

# Straight fitting, self-sealing

1823386003

Valve  
accessories

2024-08-13

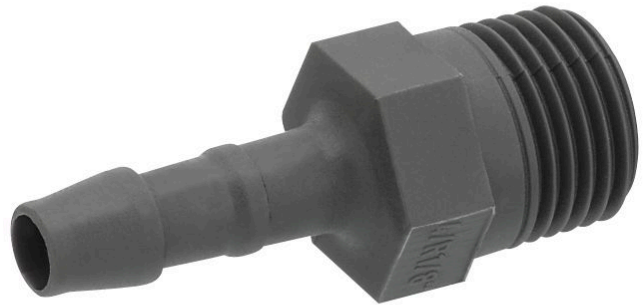

## Technical data

|                |            |
|----------------|------------|
| Industry       | Industrial |
| Clearance (LW) | 12 mm      |
| Port R         | R 3/8      |
| Delivery unit  | 10 piece   |
| Weight         | 0.005 kg   |

## Material

|                  |            |
|------------------|------------|
| Housing material | Polyamide  |
| Part No.         | 1823386003 |

# Straight fitting, self-sealing

1823386003

Valve  
accessories

2024-08-13

## Dimensions

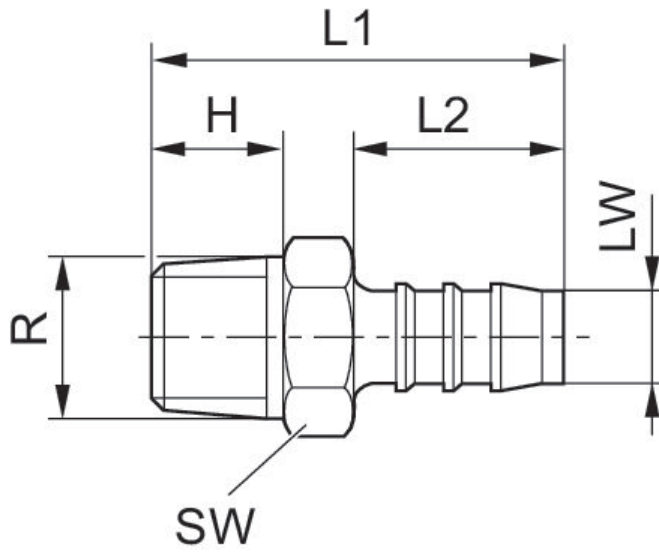

## Dimensions in mm

| Part No.   | Port R | LW    | H  | L1 | L2 | SW |
|------------|--------|-------|----|----|----|----|
| 1823386043 | R 1/8  | 4 mm  | 8  | 27 | 15 | 10 |
| 1823386044 | R 1/8  | 6 mm  | 8  | 33 | 20 | 10 |
| 1823386045 | R 1/4  | 6 mm  | 12 | 38 | 20 | 14 |
| 1823386000 | R 1/4  | 8 mm  | 12 | 41 | 23 | 14 |
| 1823386055 | R 1/4  | 10 mm | 12 | 43 | 25 | 14 |
| 1823386054 | R 1/4  | 6 mm  | 12 | 39 | 20 | 17 |
| 1823386001 | R 3/8  | 8 mm  | 12 | 44 | 23 | 17 |
| 1823386056 | R 3/8  | 10 mm | 12 | 43 | 25 | 17 |
| 1823386003 | R 3/8  | 12 mm | 12 | 48 | 28 | 17 |
| 1823386002 | R 1/2  | 8 mm  | 17 | 49 | 23 | 22 |