

Straight fitting, self-sealing

1823386044

Valve
accessories

2024-08-13

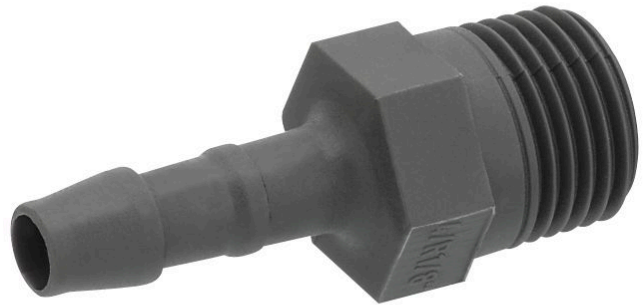

Technical data

| | |
|----------------|------------|
| Industry | Industrial |
| Clearance (LW) | 6 mm |
| Port R | R 1/8 |
| Delivery unit | 25 piece |
| Weight | 0.002 kg |

Material

| | |
|------------------|------------|
| Housing material | Polyamide |
| Part No. | 1823386044 |

Straight fitting, self-sealing

1823386044

Valve
accessories

2024-08-13

Dimensions

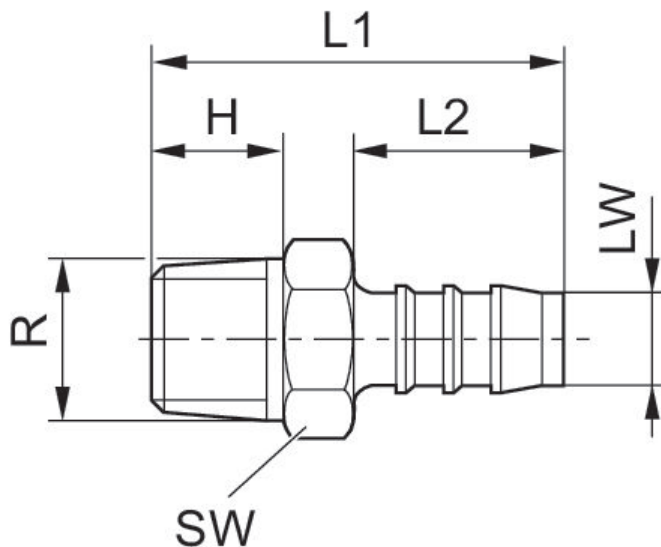

Dimensions in mm

| Part No. | Port R | LW | H | L1 | L2 | SW |
|------------|--------|-------|----|----|----|----|
| 1823386043 | R 1/8 | 4 mm | 8 | 27 | 15 | 10 |
| 1823386044 | R 1/8 | 6 mm | 8 | 33 | 20 | 10 |
| 1823386045 | R 1/4 | 6 mm | 12 | 38 | 20 | 14 |
| 1823386000 | R 1/4 | 8 mm | 12 | 41 | 23 | 14 |
| 1823386055 | R 1/4 | 10 mm | 12 | 43 | 25 | 14 |
| 1823386054 | R 1/4 | 6 mm | 12 | 39 | 20 | 17 |
| 1823386001 | R 3/8 | 8 mm | 12 | 44 | 23 | 17 |
| 1823386056 | R 3/8 | 10 mm | 12 | 43 | 25 | 17 |
| 1823386003 | R 3/8 | 12 mm | 12 | 48 | 28 | 17 |
| 1823386002 | R 1/2 | 8 mm | 17 | 49 | 23 | 22 |