

# 3/2-directional valve, pneumatically operated, Series AS2-SOV

R412006263

## General series information Series AS2

- The AVENTICS Series AS2 is a modular, versatile maintenance unit for universal application. This Series offers compact dimensions, is highly efficient, lightweight and easy-to-use. The AVENTICS Series AS guarantees reliability, safety, and efficiency with a simplified assembly and maintenance efforts.

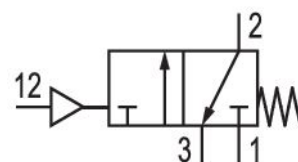

## Technical data

Industry  
Industrial

Activation  
Pneumatically

Parts  
3/2-directional valve

Nominal flow Qn  
2000 l/min

Compressed air connection  
G 3/8

Working pressure min.  
0 bar

Working pressure max  
16 bar

Connection type  
Pipe connection

Sealing principle  
Soft Seal

Type  
Poppet valve

Can be assembled into blocks  
Can be assembled into blocks

Control pressure min.  
2.5 bar

Control pressure max.  
16 bar

Min. ambient temperature  
-10 °C

Max. ambient temperature  
50 °C

Medium  
Compressed air

Neutral gases

Compressed air connection pilot exhaust  
G 1/8

Compressed air connection, exhaust  
G 1/4

Nominal flow Qn 1 to 2  
2000 l/min

Nominal flow Qn 2 to 3  
380 l/min

Weight  
0.219 kg

## Material

Housing material  
Polyamide

Seal material  
Acrylonitrile butadiene rubber

Material, front cover  
Acrylonitrile butadiene styrene

Material threaded bushing  
Die cast zinc

Part No.  
R412006263

## Technical information

The pressure dew point must be at least 15 °C under ambient and medium temperature and may not exceed 3 °C .

Nominal flow Qn with secondary pressure p2 = 6 bar at  $\Delta p = 1$  bar

A short silencer is required for wall mounting (see accessories e.g. R412004817).

## Dimensions in mm

Fig. 2

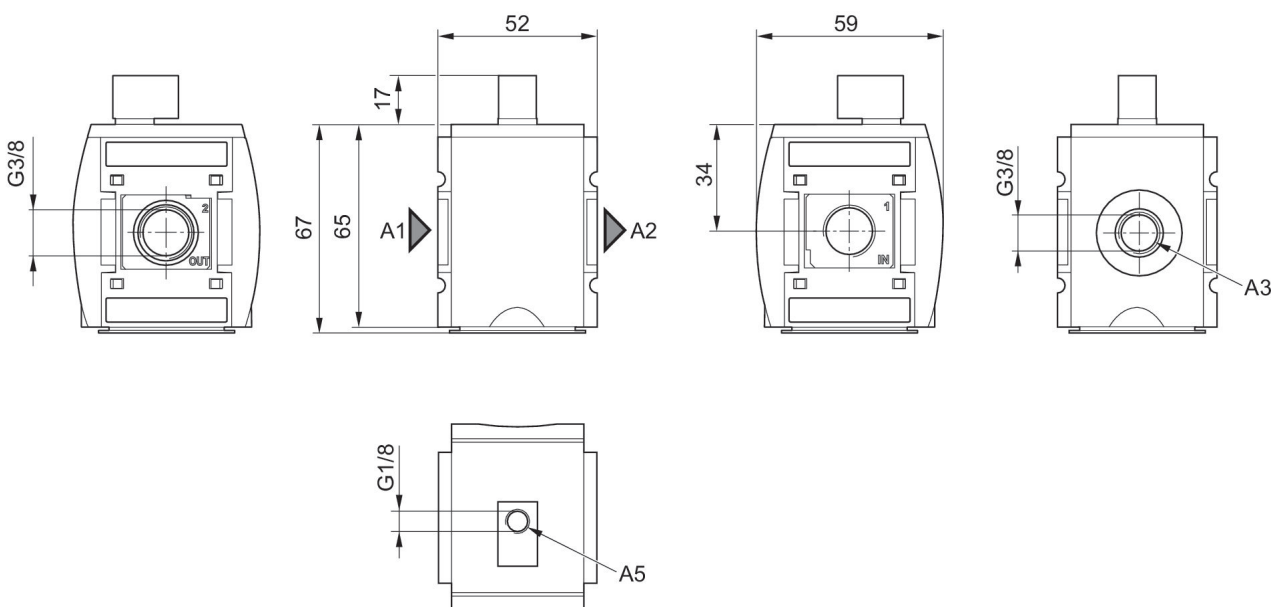

A1 = input A2 = output A3 = ventilation port  
A5 = Control pressure connection

## Dimensions in mm

Fig. 1

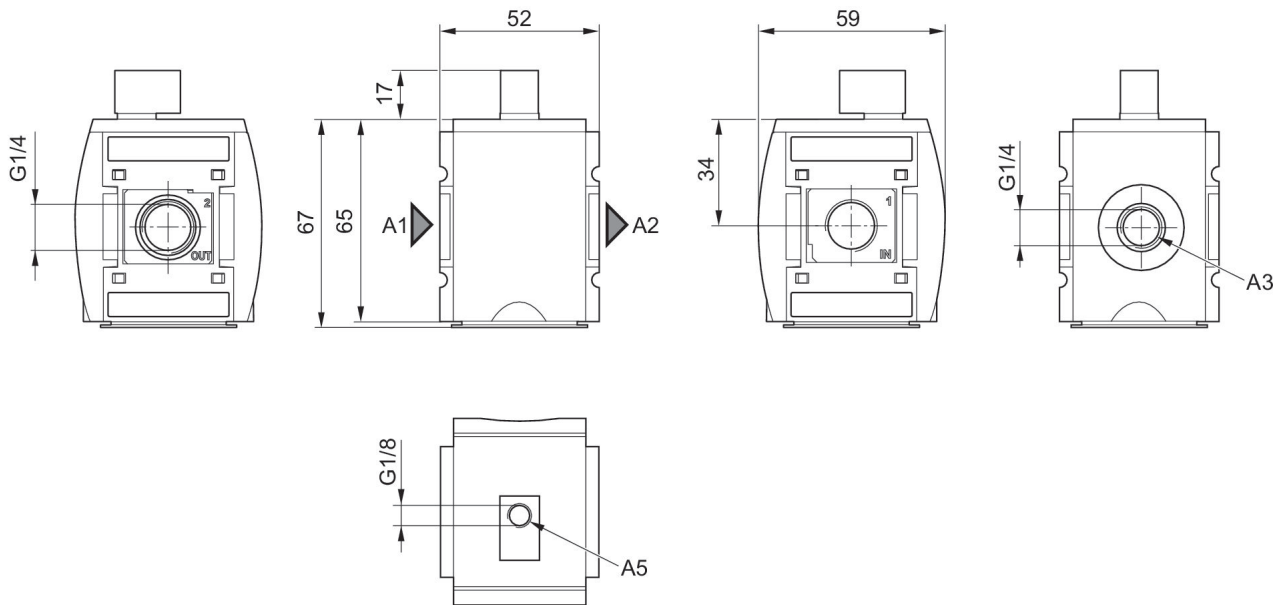

A1 = input A2 = output A3 = ventilation port  
A5 = Control pressure connection

## control pressure characteristic

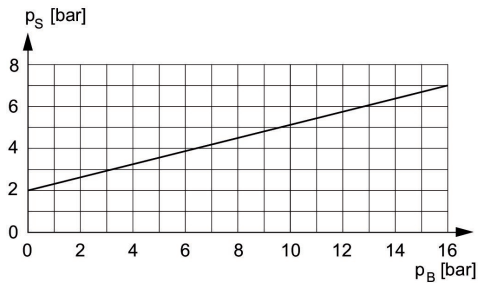

minimum pilot pressure depending on working pressure  
PS = control pressure  
P<sub>B</sub> = Working pressure

## Flow rate characteristic, $p_2 = 0,05 - 7$ bar

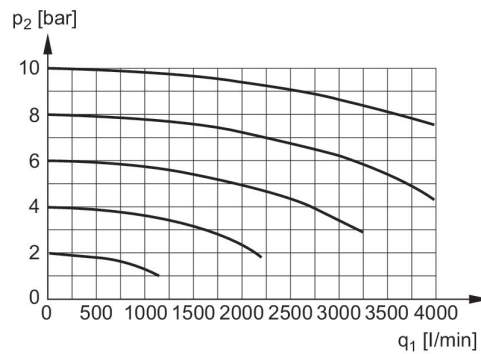

$p_2$  = secondary pressure  $q_n$  = nominal flow

## Rear exhaust

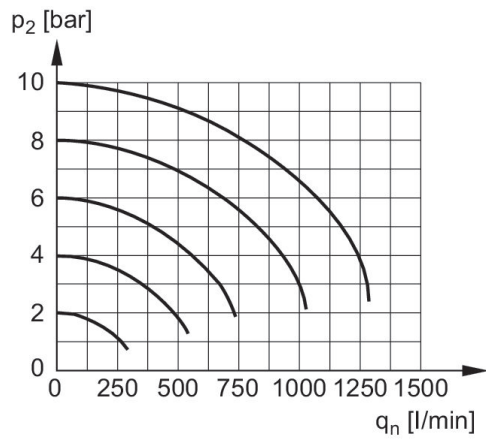

$p_2$  = secondary pressure  $q_n$  = nominal flow

## Accessories overview

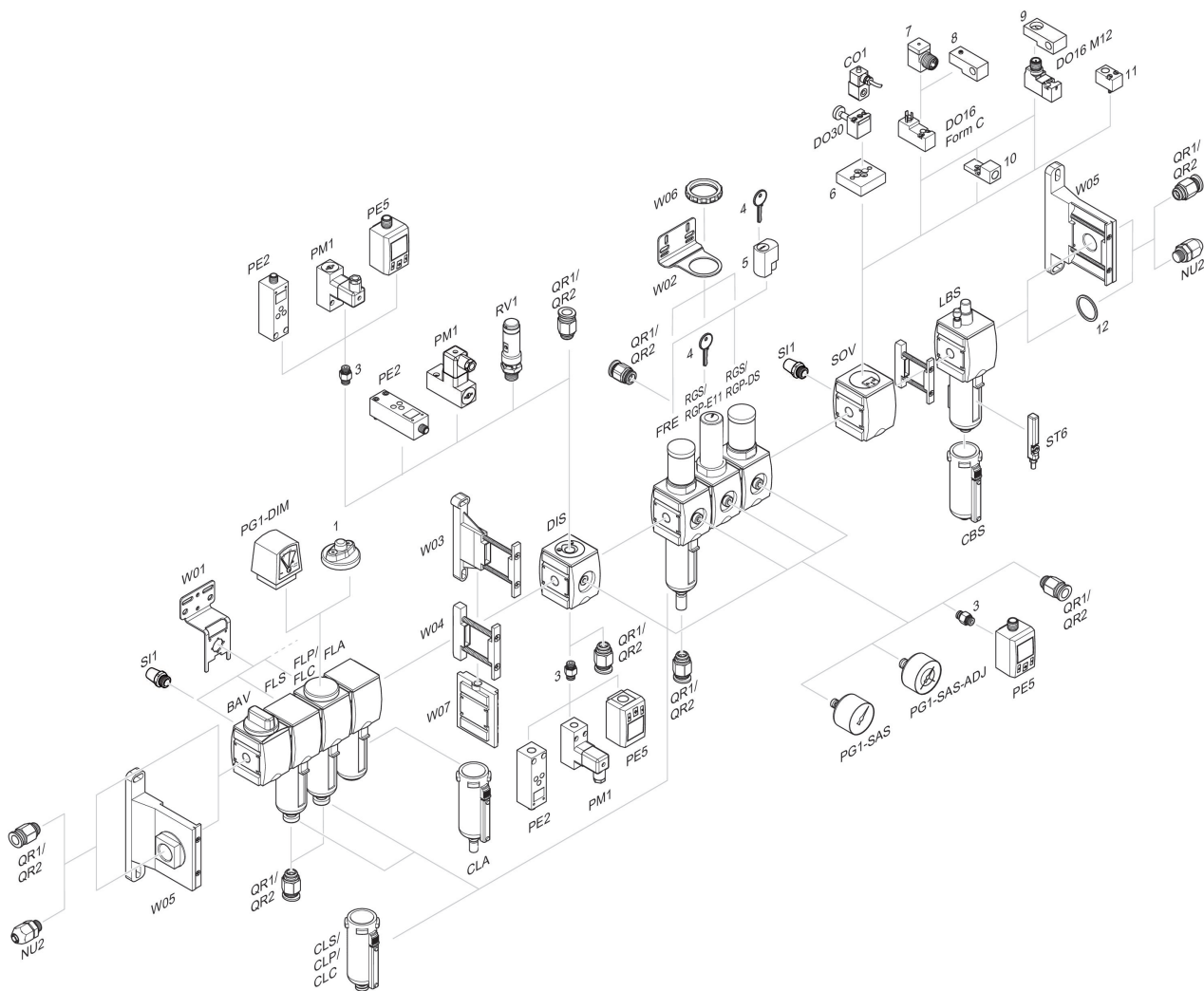

1 = contamination display 3 = Double nipple 4 = Key for E11 locking 5 = mortise lock 6 = Transition plate DO30 7 = Adapter, Series CON-VP 8 = Mounting aid DO16, form C 9 = Mounting aid DO16, M12 10 = Adapter for external pilot air 11 = Adapter pneumatic operation 12 = Sealing ring