

3/2-directional valve, electrically operated, Series AS3-SOV

R412007259

Series AS3

2024-04-09

Series AS3

The AVENTICS Series AS3 is a modular, versatile maintenance unit for universal application. This Series offers compact dimensions, is highly efficient, lightweight and easy-to-use. The AVENTICS Series AS guarantees reliability, safety, and efficiency with a simplified assembly and maintenance efforts.

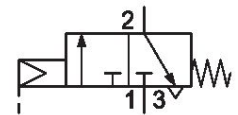

Technical data

Industry	Industrial
Activation	Electrically
Nominal flow Qn	4500 l/min
Compressed air connection	G 1/2
Min. working pressure	2.5 bar
Max. working pressure	16 bar
Sealing principle	Soft seal
Connection type	Pipe connection
Parts	3/2-directional valve
Can be assembled into blocks	Can be assembled into blocks
Basic valve equipment	Basic valve without pilot valve, with CNOMO subbase
Type	Poppet valve
Min. ambient temperature	-10 °C
Max. ambient temperature	50 °C
Medium	Compressed air Neutral gases
Max. particle size	25 µm
Compressed air connection, exhaust	G 1/2
Nominal flow Qn 1 to 2	4500 l/min

3/2-directional valve, electrically operated, Series AS3-SOV

Series AS3

2024-04-09

R412007259

Nominal flow Qn 2 to 3 3200 l/min

Protection class with connection IP65

Weight 0.459 kg

Material

Housing material Polyamide

Seal material Acrylonitrile butadiene rubber

Material threaded bushing Die cast zinc

Material front plate Acrylonitrile butadiene styrene

Part No. R412007259

Technical information

The pressure dew point must be at least 15 °C less than ambient and medium temperature and may not exceed 3 °C.

Nominal flow Qn with secondary pressure p2 = 6 bar at $\Delta p = 1$ bar

A change in the flow direction (from air supply on the left to air supply on the right) occurs by rotating installation by 180° about the vertical axis. Please see the operating instructions for further details.

2 x O-ring Ø3x1,5 (included)

See accessories for pilot valve and coil

3/2-directional valve, electrically operated, Series AS3-SOV

Series AS3

2024-04-09

R412007259

Dimensions in mm

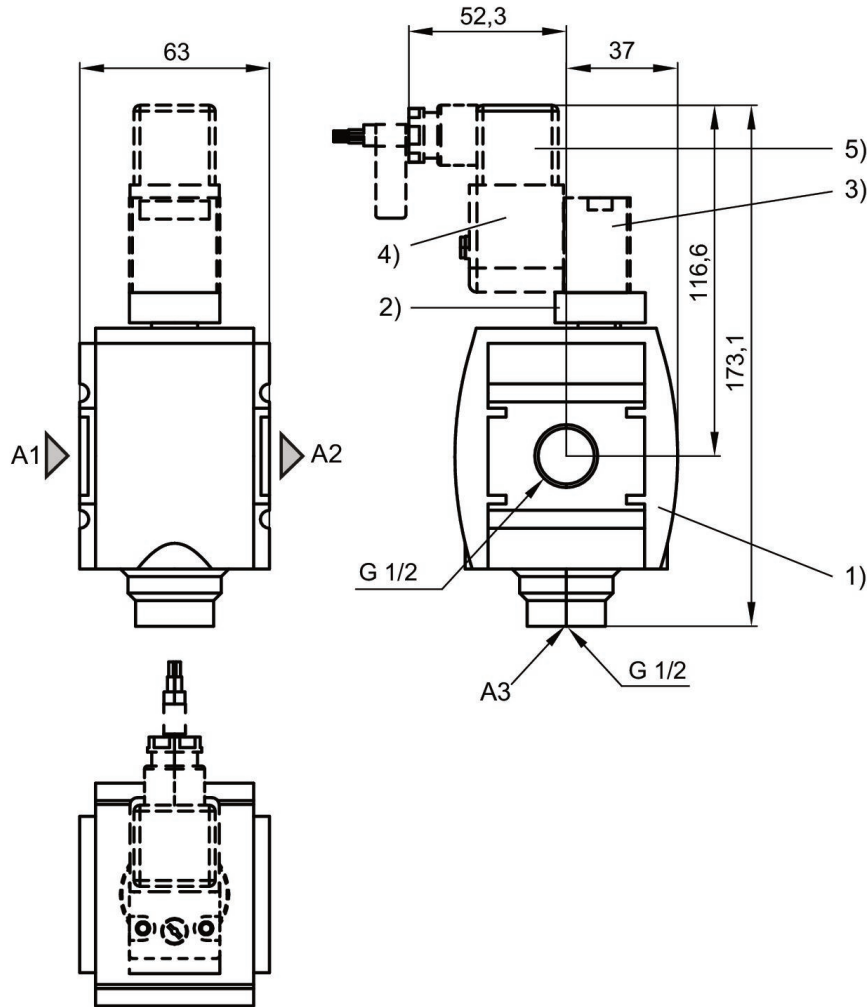

- A1 = input
- A2 = output
- A3 = ventilation port
- 1) Shut-off valve
- 2) Transition plate
- 3) Pilot valve
- 4) Coil
- 5) Valve plug connector

3/2-directional valve, electrically operated, Series AS3-SOV

Series AS3

2024-04-09

R412007259

Flow rate characteristic, $p_2 = 0,05 - 7$ Rear exhaust
bar

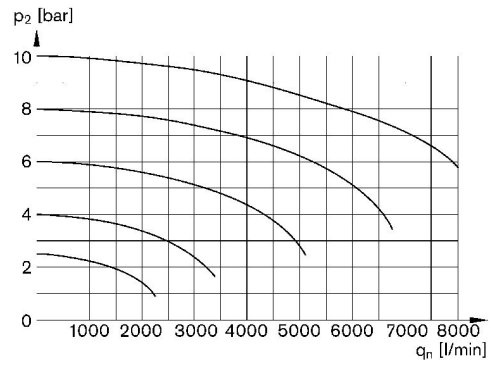
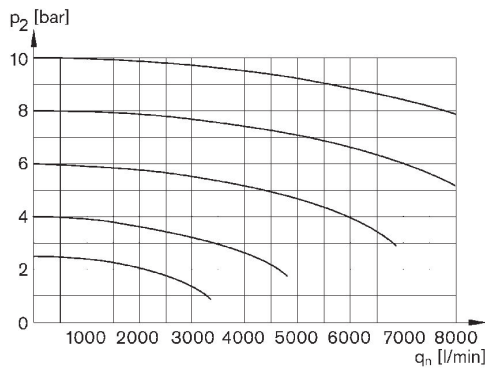

p_2 = Secondary pressure
 q_n = Nominal flow

p_2 = Secondary pressure
 q_n = Nominal flow

3/2-directional valve, electrically operated, Series AS3-SOV

Series AS3

2024-04-09

R412007259
Accessories overview

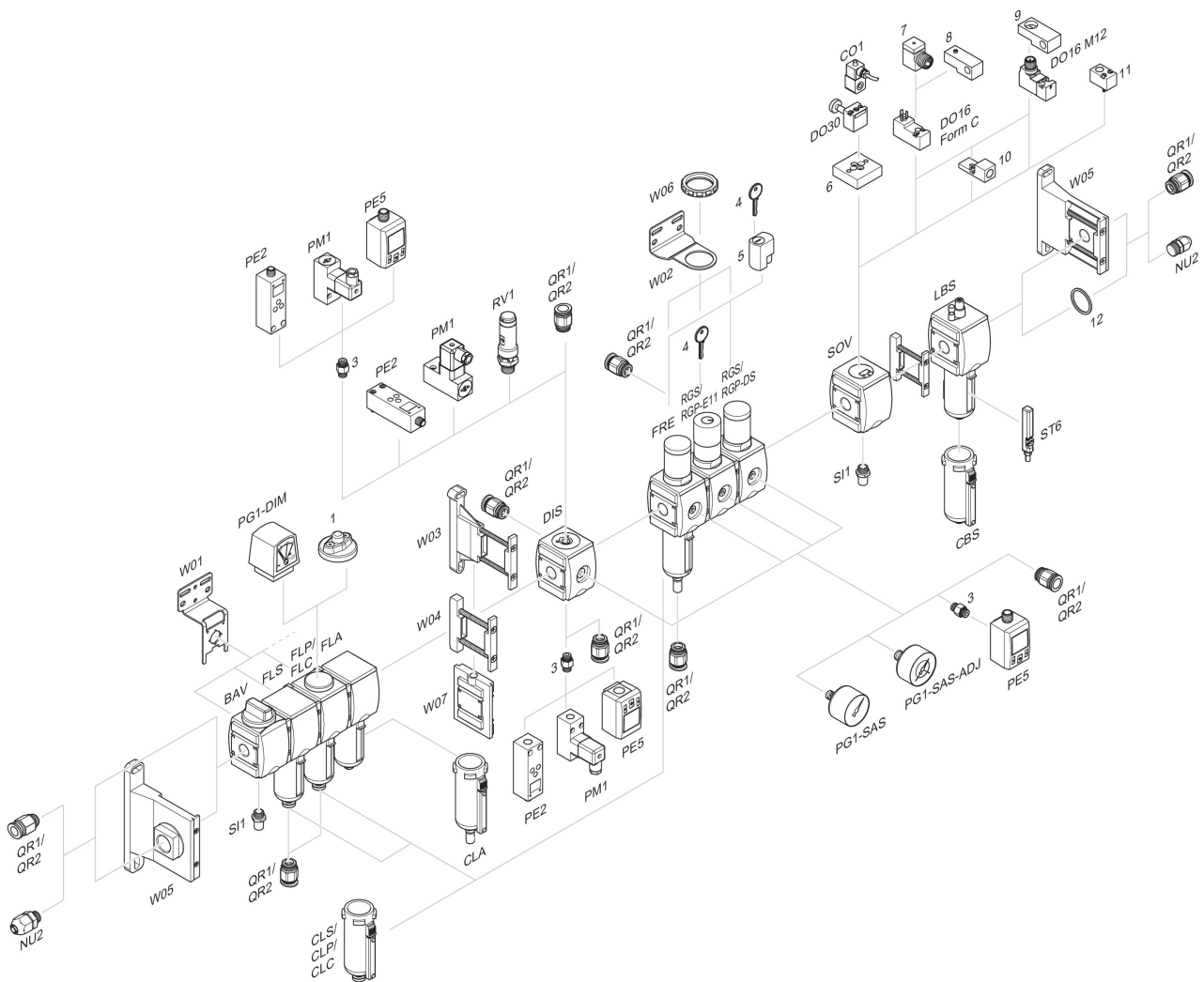

1 = contamination display 3 = Double nipple 4 = Key for E11 locking 5 = mortise lock 6 = Transition plate DO30 7 = Adapter, Series CON-VP 8 = Mounting aid DO16, form C 9 = Mounting aid DO16, M12 10 = Adapter for external pilot air 11 = Adapter pneumatic operation 12 = Sealing ring