

# 3/2-directional valve, electrically operated, Series AS3-SOV

R412007268

Series AS3

2024-08-22

## Series AS3

The AVENTICS Series AS3 is a modular, versatile maintenance unit for universal application. This Series offers compact dimensions, is highly efficient, lightweight and easy-to-use. The AVENTICS Series AS guarantees reliability, safety, and efficiency with a simplified assembly and maintenance efforts.

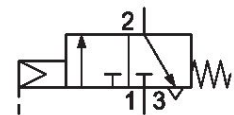

## Technical data

Industry	Industrial
Activation	Electrically
Nominal flow Qn	4500 l/min
Compressed air connection	G 1/2
Min. working pressure	2.5 bar
Max. working pressure	16 bar
Sealing principle	Soft seal
Connection type	Pipe connection
Parts	3/2-directional valve
Can be assembled into blocks	Can be assembled into blocks
Basic valve equipment	Basic valve without pilot valve
Type	Poppet valve
Min. ambient temperature	-10 °C
Max. ambient temperature	50 °C
Medium	Compressed air Neutral gases
Max. particle size	25 µm
Compressed air connection, exhaust	G 1/2
Nominal flow Qn 1 to 2	4500 l/min
Nominal flow Qn 2 to 3	3200 l/min

# 3/2-directional valve, electrically operated, Series AS3-SOV

Series AS3

2024-08-22

R412007268

Protection class with connection

IP65

Weight

0.459 kg

## Material

Housing material

Polyamide

Seal material

Acrylonitrile butadiene rubber

Material threaded bushing

Die cast zinc

Material front plate

Acrylonitrile butadiene styrene

Part No.

R412007268

## Technical information

The pressure dew point must be at least 15 °C less than ambient and medium temperature and may not exceed 3 °C.

Nominal flow  $Q_n$  with secondary pressure  $p_2 = 6$  bar at  $\Delta p = 1$  bar

A change in the flow direction (from air supply on the left to air supply on the right) occurs by rotating installation by 180° about the vertical axis. Please see the operating instructions for further details.

# 3/2-directional valve, electrically operated, Series AS3-SOV

Series AS3

2024-08-22

R412007268

Dimensions in mm

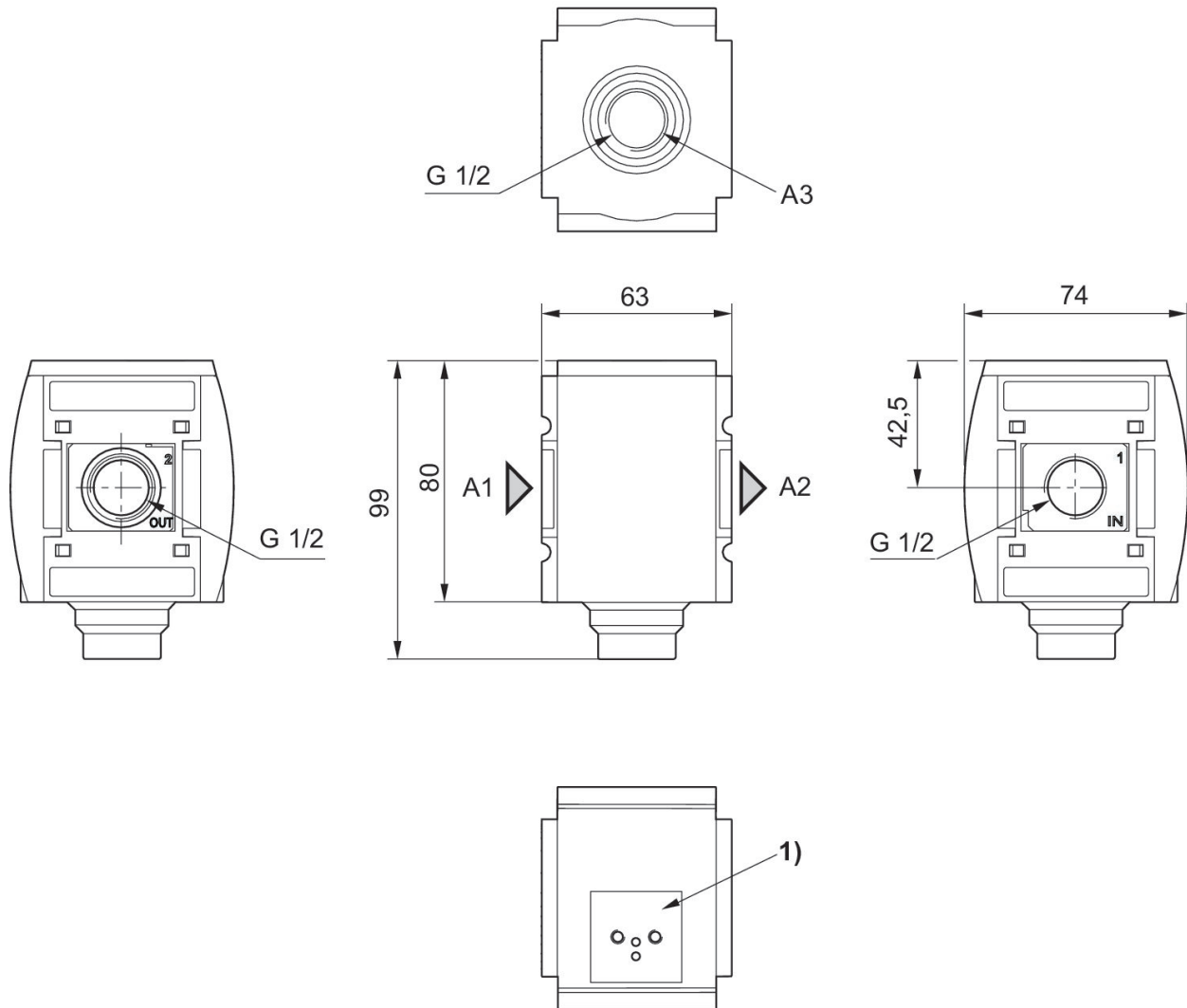

A1 = input  
A2 = output  
A3 = ventilation port  
1) For pilot valve series DO16

# 3/2-directional valve, electrically operated, Series AS3-SOV

Series AS3

2024-08-22

R412007268

Flow rate characteristic,  $p_2 = 0,05 - 7$  Rear exhaust  
bar

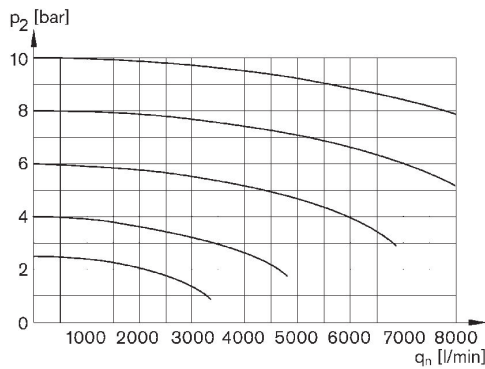

$p_2$  = Secondary pressure  
 $q_n$  = Nominal flow

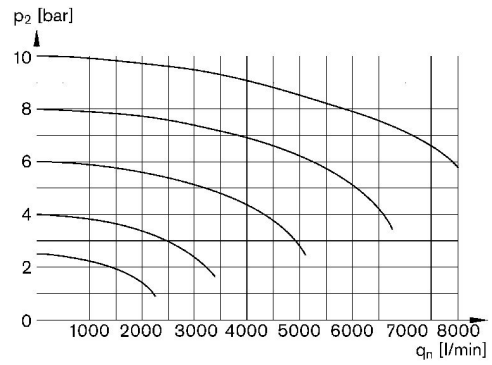

$p_2$  = Secondary pressure  
 $q_n$  = Nominal flow

# 3/2-directional valve, electrically operated, Series AS3-SOV

Series AS3

2024-08-22

R412007268  
Accessories overview

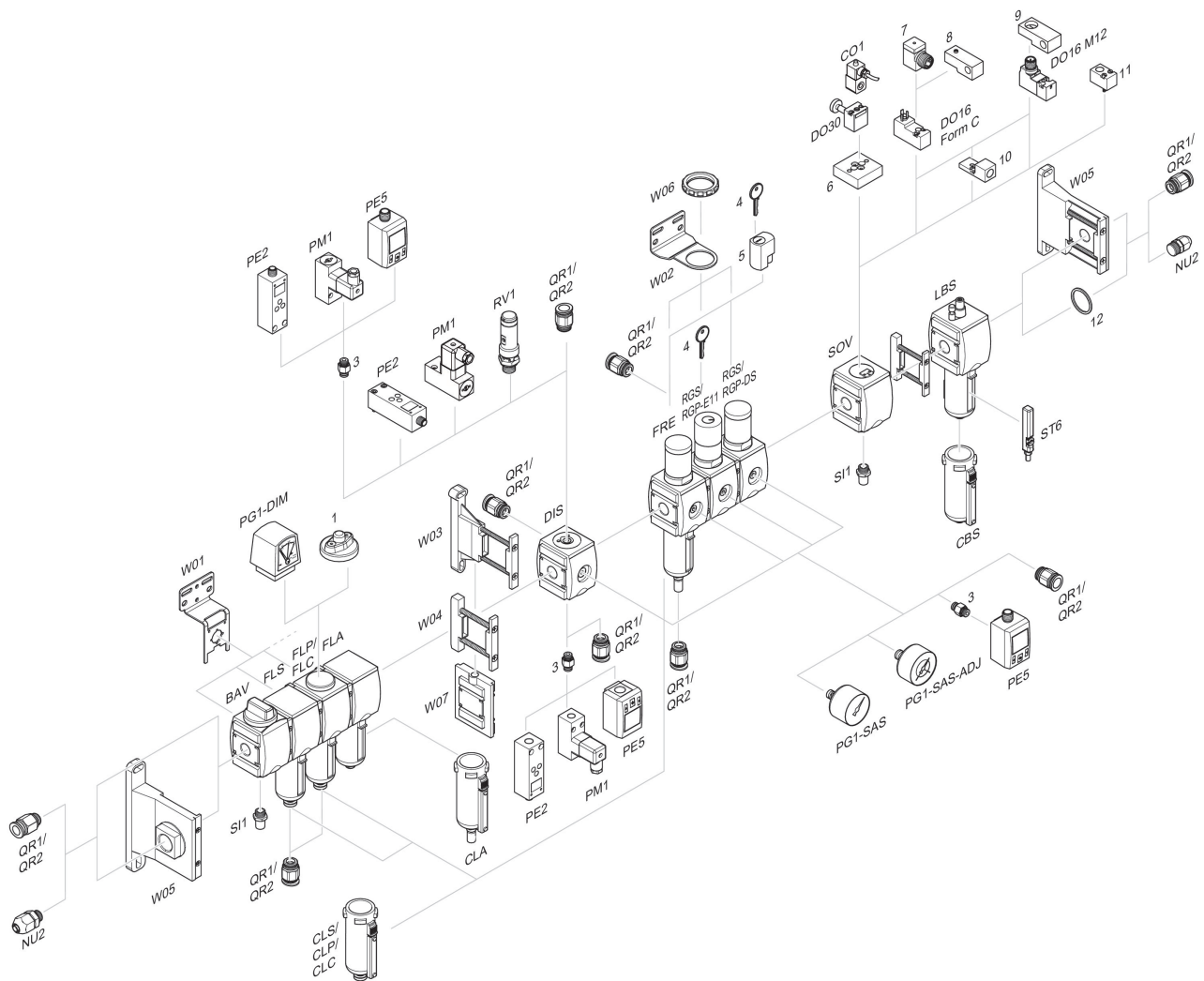

1 = contamination display 3 = Double nipple 4 = Key for E11 locking 5 = mortise lock 6 = Transition plate DO30 7 = Adapter, Series CON-VP 8 = Mounting aid DO16, form C 9 = Mounting aid DO16, M12 10 = Adapter for external pilot air 11 = Adapter pneumatic operation 12 = Sealing ring