

Throttle valve, Series CH02

0821201003

Series CH02

- $Q_n = [[200] \text{ l/min}] \dots [[4100] \text{ l/min}]$

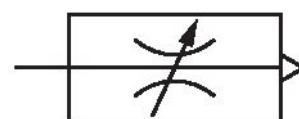
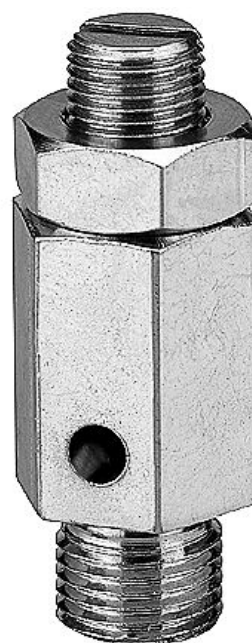

Technical data

Industry
Industrial

Working pressure min.
0 bar

Working pressure max
16 bar

Min. ambient temperature
0 °C

Max. ambient temperature
100 °C

Min. medium temperature
0 °C

Max. medium temperature
100 °C

Port 1
G 1/2

Type
Screw-in throttle

Medium
Compressed air

Compressed air connection type
External thread

Flow Q_n
3000 l/min

Weight
0.17 kg

Housing material
Brass

Surface housing
galvanized

Part No.
0821201003

Technical information

The min. control pressure must be adhered to, since otherwise faulty switching and valve failure may result!

The pressure dew point must be at least 15 °C under ambient and medium temperature and may not exceed 3 °C .

The oil content of compressed air must remain constant during the life cycle.

Use only the approved oils from AVENTICS. Further information can be found in the “Technical information” document (available in <https://www.emerson.com/en-us/support>).

Dimensions

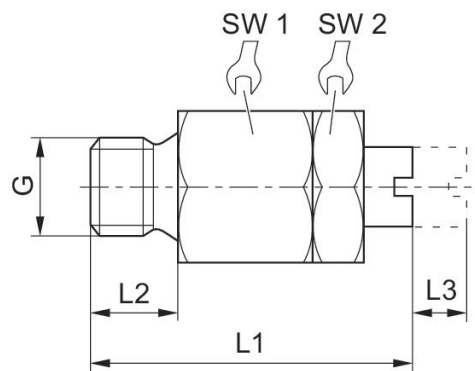

Part No.	Port G	L1	L2	L3	SW1	SW2
0821201001	G 1/8	34	8	5	13	13
0821201002	G 1/4	33	8	6.5	17	14
0821201003	G 1/2	50	10	8	27	22