

# Throttle valve, Series CH02

0821201101

Series CH02

■  $Q_n = [[200] \text{ l/min}] \dots [[4100] \text{ l/min}]$

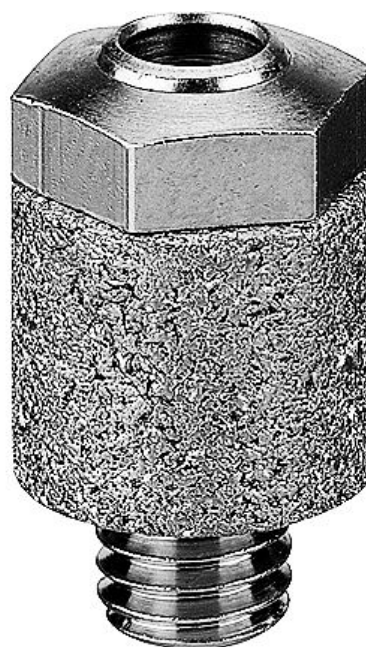

## Technical data

Industry  
Industrial

Working pressure min.  
0 bar

Working pressure max  
10 bar

Min. ambient temperature  
-25 °C

Max. ambient temperature  
80 °C

Min. medium temperature  
-25 °C

Max. medium temperature  
80 °C

Port 1  
M5

Type  
Throttle valve with silencer

Medium  
Compressed air

Compressed air connection type  
External thread

Flow  $Q_n$   
200 l/min

Tightening torque for silencer max.  
1 Nm

Weight  
0.005 kg

Housing material  
Brass

Surface housing  
galvanized

Seal material  
Acrylonitrile butadiene rubber

Silencer material  
Stainless Steel

Part No.  
0821201101

## Technical information

The min. control pressure must be adhered to, since otherwise faulty switching and valve failure may result!

The pressure dew point must be at least 15 °C under ambient and medium temperature and may not exceed 3 °C .

The oil content of compressed air must remain constant during the life cycle.

Use only the approved oils from AVENTICS. Further information can be found in the “Technical information” document (available in <https://www.emerson.com/en-us/support>).

## Dimensions

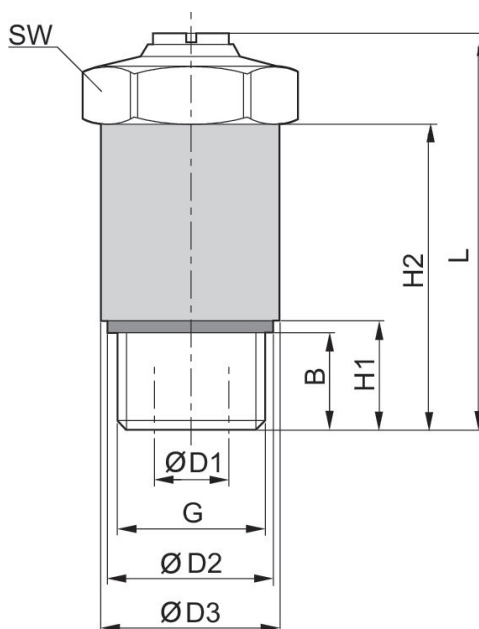

Part No.	Port G	Ø D1	Ø D2	Ø D3	H1	H2	B	L 1)	SW
0821201101	M5	2	7.7	9	3.8	12	12	16.6	8
0821201102	G 1/8	4	13	16	7	24	5.5	31.5	13
0821201103	G 1/4	6.5	17.9	20	10	30	8	37.5	17
0821201104	G 3/8	8.5	21.8	25	10	35	8	45	19
0821201105	G 1/2	12	26.5	30	12	42	10	52	24

1) Max.