

- $Q_n = 3200 \text{ l/min}$

AVENTICS Series CP1 Couplings

The AVENTICS Series CP1 of safe couplings using single snap-on coupling are robust, safe and fit two different plug-in profiles, the EURO- profile and the ARO profile.

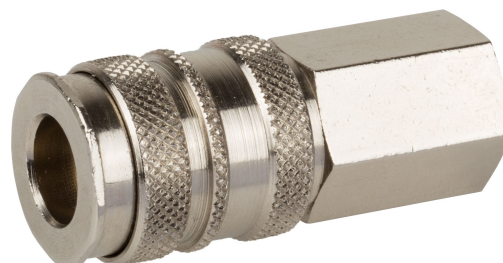

Technical data

Industry	Industrial
Port D	NW 5
Port G	G 1/4
Compressed air connection type	Internal thread
Nominal width NW	5 mm
Nominal flow Q_n	500 l/min
Min. working pressure	0 bar
Max. working pressure	16 bar
Min. ambient temperature	-10 °C
Max. ambient temperature	90 °C
Min. medium temperature	-10 °C
Max. medium temperature	90 °C
Medium	Compressed air
Delivery unit	2 piece
Weight per piece	0.031 kg
Housing material	Brass
Surface housing	nickel-plated
Material release bushing	Brass
Surface release bushing	nickel-plated

Lock coupling, Series CP1

1823376004

Series CP1

2024-10-23

Seal material
Material connector
Surface connector

Acrylonitrile butadiene rubber
Brass
nickel-plated
1823376004

Dimensions

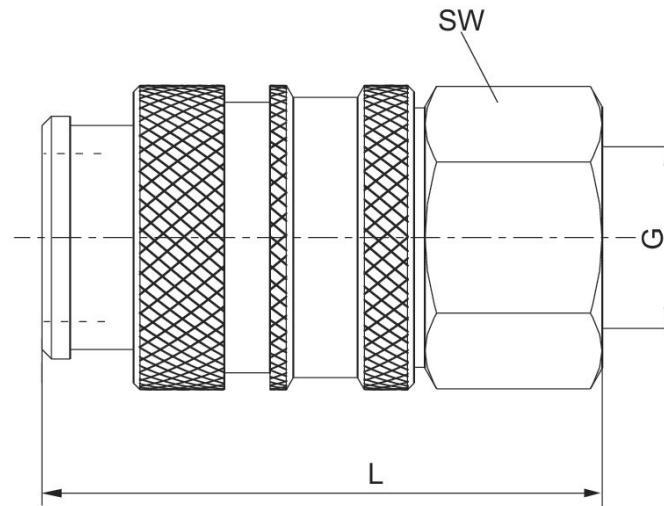

Part No.	Port G	Nominal width NW	L	SW
R412010010	G 1/8	5 mm	36.5	14
1823376004	G 1/4	5 mm	38.5	17