

AVENTICS Series CP1 Couplings

The AVENTICS Series CP1 of safe couplings using single snap-on coupling are robust, safe and fit two different plug-in profiles, the EURO- profile and the ARO profile.



Technical data

Industry	Industrial
Port D	NW 7,8
Port G	Ø 6
Compressed air connection type	Collar
Nominal width NW	7.8 mm
Nominal flow Qn	1800 l/min
Min. working pressure	0 bar
Max. working pressure	16 bar
Min. ambient temperature	-10 °C
Max. ambient temperature	90 °C
Min. medium temperature	-10 °C
Max. medium temperature	90 °C
Medium	Compressed air
Delivery unit	1 piece
Weight per piece	0.16 kg
Housing material	Brass
Surface housing	nickel-plated
Material release bushing	Brass
Surface release bushing	nickel-plated

Safety coupling, Series CP1

2024-02-20

1823376024

Seal material	Acrylonitrile butadiene rubber
Material connector	Brass
Surface connector	nickel-plated
	1823376024

Technical information

On pushing the release bushing back, the coupling plug is released but remains locked. The coupling valve closes and the air line is simultaneously vented. Actuate the release bushing once more for safe uncoupling.

Dimensions

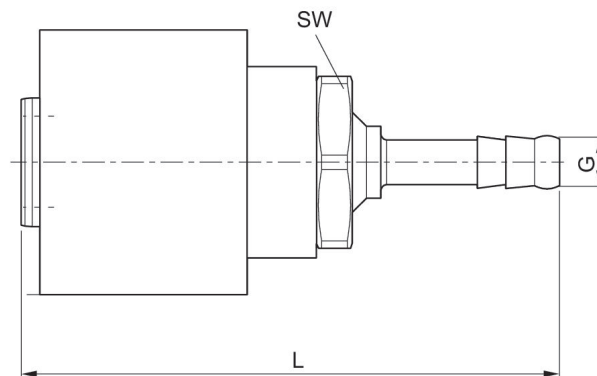

Part No.	Port G	Nominal width NW	L	SW
1823376024	Ø 6	7,8 mm	76	24
1823376025	Ø 8	7,8 mm	76	24
1823376026	Ø 10	7,8 mm	76	24
1823376027	Ø 13	7,8 mm	76	24