

Double nipple

2024-03-21

R412010692

AVENTICS Blanking screws and connectors

Technical data

Industry	Industrial
Port G	R 1/2
Type	FPT-C-RDO
Min. working pressure	0 bar
Max. working pressure	150 bar
Min. ambient temperature	-20 °C
Max. ambient temperature	150 °C
Delivery unit	2 piece
Weight	0.039 kg

Material

Material	Stainless Steel
Part No.	R412010692

Dimensions

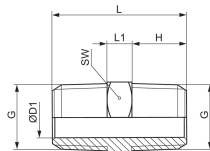

Part No.	Port G	ØD1	H	L	L1	SW
R412010691	R 1/4	8.5	11	27	5	14
R412010692	R 1/2	15	14	34	6	22