

# Double nipple

R412010691

2024-03-21

## AVENTICS Blanking screws and connectors

### Technical data

Industry	Industrial
Port G	R 1/4
Type	FPT-C-RDO
Min. working pressure	0 bar
Max. working pressure	150 bar
Min. ambient temperature	-20 °C
Max. ambient temperature	150 °C
Delivery unit	2 piece
Weight	0.015 kg

### Material

Material	Stainless Steel
Part No.	R412010691

### Dimensions

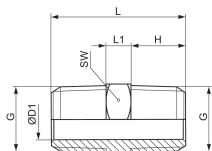

Part No.	Port G	ØD1	H	L	L1	SW
R412010691	R 1/4	8.5	11	27	5	14
R412010692	R 1/2	15	14	34	6	22