

Elbow fitting

R412010725

2024-03-21

AVENTICS Blanking screws and connectors



Technical data

Industry	Industrial
Compressed air connection type	Internal thread
Port G	G 1/2
Compressed air connection type 2	External thread
Port D	R 1/2
Type	FPT-S-RLT
Min. working pressure	-0.95 bar
Max. working pressure	16 bar
Min. ambient temperature	-20 °C
Max. ambient temperature	150 °C

Material

Material	Stainless Steel
Part No.	R412010725

Elbow fitting

2024-03-21

R412010725

Dimensions

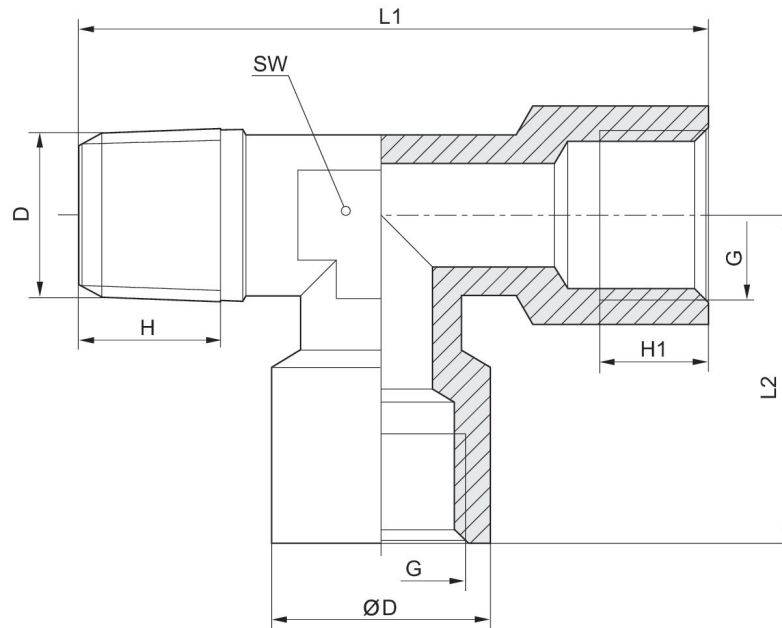

Part No.	Port D	Port G	H	H1	L1	L2	Ø D	SW
R412010724	R 1/4	G 1/4	11	11	47.5	24.5	24.5	12
R412010725	R 1/2	G 1/2	14	15	61.5	32	25.5	20