

5/2-directional valve, Series CD07

R432016625

Series CD07

- $Q_n = 1200 \dots 1400 \text{ l/min}$

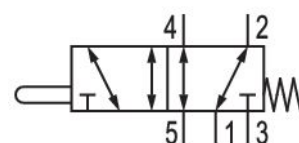
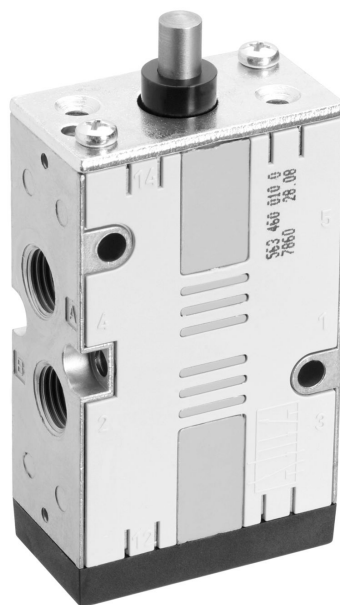

Technical data

Industry

Industrial

Activation

Mechanical

Frame size

CD07 - inch

Valve type

Spool valve, positive overlapping

Switching principle

5/2, with spring return

Actuating control

Single Solenoid

Plate connection

Pipe connection

Actuating element

Plunger

Sealing principle

soft seal

Compressed air connection

1/4 NPT

Compressed air connection type

Internal thread

Compressed air connection input

1/4 NPT

Compressed air connection output

1/4 NPT

Compressed air connection, exhaust

1/4 NPT

| | |
|------------------------------------|---------------------|
| Nominal flow Qn | 1200 l/min |
| Nominal flow Qn 1 to 2 | 1200 l/min |
| Nominal flow Qn 2 to 3 | 1200 l/min |
| Working pressure min. | -0.95 bar |
| Working pressure max. | 10 bar |
| Control pressure min. | -0.95 bar |
| Control pressure max. | 10 bar |
| actuating force min. | 70 N |
| ATEX | Suitable for ATEX |
| Min. ambient temperature | -25 °C |
| Max. ambient temperature | 80 °C |
| Min. medium temperature | -25 °C |
| Max. medium temperature | 80 °C |
| Medium | Compressed air |
| Oil content of compressed air min. | 0 mg/m ³ |
| Oil content of compressed air max. | 1 mg/m ³ |
| Max. particle size | 50 µm |
| Weight | 0.54 kg |

Material

| | |
|----------------------------|---|
| Housing material | Die cast zinc Polyamide fiber-glass reinforced |
| Seal material | Acrylonitrile butadiene rubber |
| Material actuating control | Stainless Steel |
| Part No. | R432016625 |

Technical information

The min. control pressure must be adhered to, since otherwise faulty switching and valve failure may result!

The pressure dew point must be at least 15 °C less than ambient and medium temperature and may not exceed 3 °C.

The oil content of compressed air must remain constant during the life cycle.

Use only the approved oils from AVENTICS. Further information can be found in the "Technical information" document (available in <https://www.emerson.com/en-us/support>).

Dimensions in inches

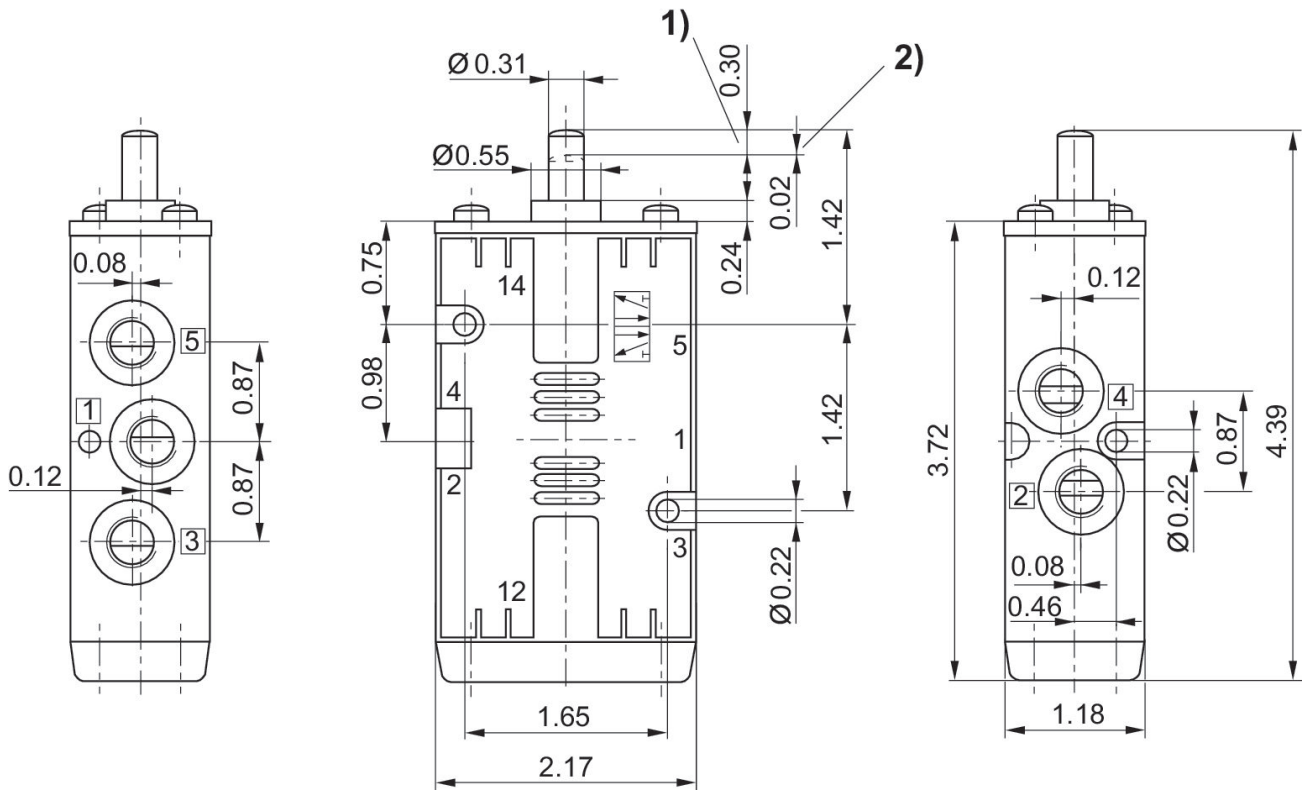

1) Stroke 2) Overstroke
Dimensions of basic valve apply to all types of actuation.