

# Non-return valve, Series QR1-ANR

R432000417

Series QR1 - Inch





## Technical data

|                                  |                 |
|----------------------------------|-----------------|
| Industry                         | Industrial      |
| Compressed air connection 1      | Ø1/4            |
| Compressed air connection type 1 | push-in fitting |
| Compressed air connection type 2 | External thread |
| Type                             | Poppet valve    |
| Compressed air connection 2      | 1/8 NPT         |
| Working pressure min.            | 0.8275 bar      |
| Working pressure max             | 10 bar          |
| Min. ambient temperature         | 0 °C            |
| Max. ambient temperature         | 60 °C           |
| Min. medium temperature          | 0 °C            |
| Max. medium temperature          | 60 °C           |
| Medium                           | Compressed air  |
| Delivery unit                    | 5 piece         |
| Weight                           | 0.0136 kg       |

## Material

|                  |                                |
|------------------|--------------------------------|
| Housing material | Brass                          |
| Surface housing  | nickel-plated                  |
| Seal material    | Acrylonitrile butadiene rubber |
| Part No.         | R432000417                     |

## Technical information

Flow direction from tubing to threads

### Dimensions in inches

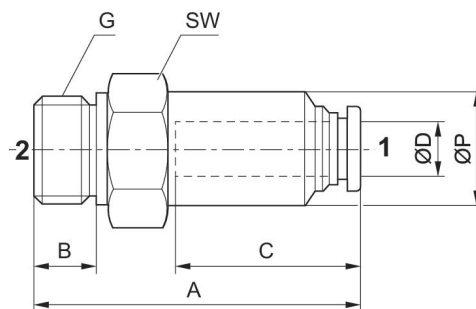

| Part No.   | G         | Ø D   | A     | B     | C     | SW    | Ø P   |
|------------|-----------|-------|-------|-------|-------|-------|-------|
| R432000424 | 10-32 UNF | Ø5/32 | 1.182 | 0.217 | 0.63  | 7/16  | 0.394 |
| R432000423 | 1/8 NPT   | Ø5/32 | 1.221 | 0.315 | 0.63  | 7/16  | 0.394 |
| R432000422 | 1/8 NPT   | Ø5/16 | 1.127 | 0.315 | 0.729 | 9/16  | 0.406 |
| R432000417 | 1/8 NPT   | Ø1/4  | 0.973 | 0.315 | 0.67  | 1/2   | 0.473 |
| R432000418 | 1/4 NPT   | Ø1/4  | 1.127 | 0.433 | 0.67  | 1/2   | 0.511 |
| R432000421 | 1/4 NPT   | Ø1/4  | 1.127 | 0.433 | 0.729 | 9/16  | 0.406 |
| R432000419 | 3/8 NPT   | Ø 3/8 | 2.45  | 0.473 | 0.827 | 11/16 | 0.989 |
| R432000415 | 3/8 NPT   | Ø1/2  | 2.537 | 0.473 | 0.887 | 7/8   | 0.985 |
| R432000420 | 1/2 NPT   | Ø 3/8 | 2.466 | 0.591 | 0.827 | 7/8   | 1.103 |
| R432000416 | 1/2 NPT   | Ø1/2  | 2.778 | 0.591 | 0.887 | 7/8   | 1.103 |