

# QR1-S-RAS standard series

R432000039

General series information  
AVENTICS Series QR1 Fittings

- AVENTICS Series QR1 push-in connectors with easy, secure mounting are available in many versions: for tubing diameters from 3 to 16 mm, as well as in plastic, metal, and stainless steel variants. QR1 Series offers a cylindric thread that allows repeated connection and release without problems (Quick Release) and captive O-ring guarantees an optimal sealing. Our QR program offers the right solution for every application and industry.



## Technical data

Industry	Industrial
Fitting type	Push-in connector
Compressed air connection type	External thread
Port G	1/4 NPT
Compressed air connection type 2	pin bushing
Port D	Ø 3/8
Type	QR1-S-RAS
Working pressure min.	-0.95 bar
Working pressure max	10 bar
Min. ambient temperature	0 °C
Max. ambient temperature	60 °C
Delivery unit	10 piece
Weight	0.023 kg

## Material

Surface	nickel-plated
Housing material	Polybutyleneterephthalate
Seal material	Acrylonitrile butadiene rubber

Material thread	Brass
Surface thread	nickel-plated
Part No.	R432000039

### Technical information

The series QR1 (plastic) and QR2 (metal) can not be combined

Thread seal with captive O-ring

These pneumatic components with NPT or inch thread dimensions are only available from our US sales organization.

### Dimensions in inches

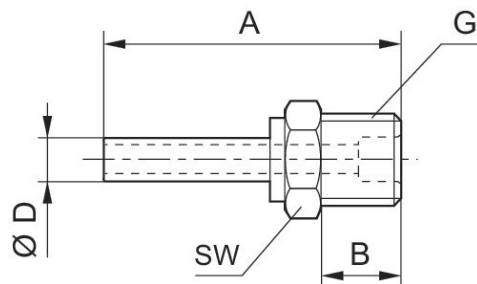

### Dimensions in inches

Part No.	Port D	Port G	A	B	SW
R432000045	Ø5/32	10-32 UNF	1.45	0.16	3/8
R432000034	Ø1/4	10-32 UNF	1.65	0.16	3/8
R432000047	Ø5/32	1/8 NPT	1.3	0.32	13/32
R432000036	Ø1/4	1/8 NPT	1.5	0.32	13/32
R432000037	Ø1/4	3/8 NPT	1.65	0.47	11/16
R432000046	Ø5/32	1/4 NPT	1.42	0.43	9/16
R432000035	Ø1/4	1/4 NPT	1.62	0.43	9/16
R432000042	Ø5/16	1/4 NPT	1.7	0.43	9/16
R432000039	Ø 3/8	1/4 NPT	2.17	0.43	19/32
R432000032	Ø1/2	1/4 NPT	2.44	0.43	23/32
R432000044	Ø5/16	3/8 NPT	1.73	0.47	11/16
R432000040	Ø 3/8	3/8 NPT	1.93	0.47	11/16
R432000033	Ø1/2	3/8 NPT	2.4	0.47	23/32
R432000038	Ø 3/8	1/2 NPT	2.05	0.59	27/32
R432000031	Ø1/2	1/2 NPT	2.25	0.59	27/32