

AVENTICS Series QR2 Fittings

AVENTICS Series QR2, push-in connectors with easy, secure mounting are available in many versions: In metal for tubing diameters from 3 to 16 mm. QR2 Series offers a cylindric thread that allows repeated connection and release without problems (Quick Release) and captive O-ring guarantees an optimal sealing. Our QR program offers the right solution for every application and industry.



Technical data

| | |
|-------------------------------------|-------------------------------------|
| Industry | Industrial |
| Fitting type | T-union, conical |
| Compressed air connection type | External thread |
| Port G | R 1/8 |
| Compressed air connection type 2 | push-in fitting |
| Port D | Ø 4 |
| Type | QR2-C-RTT |
| suitable for use in food processing | suitable for use in food processing |
| Min. working pressure | -0.95 bar |
| Max. working pressure | 16 bar |
| Min. ambient temperature | -20 °C |
| Max. ambient temperature | 150 °C |
| Delivery unit | 2 piece |
| Weight | 0.015 kg |

Material

| | |
|----------------------------|-----------------|
| Housing material | Stainless Steel |
| Seal material | Fluorocautchouc |
| Material tooth lock washer | Stainless Steel |

Series QR2-C-RTT, stainless steel

2024-04-10

R412004968

Material release ring Stainless Steel
Material thread Stainless Steel
Part No. R412004968

Technical information

The series QR1 (plastic) and QR2 (metal) can not be combined

Dimensions

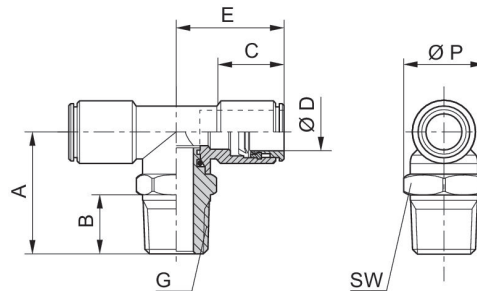

| Part No. | Port D | Port G | A | B | C | E | SW | Ø P |
|------------|--------|--------|------|------|----|------|----|-----|
| R412004968 | Ø 4 | R 1/8 | 21.5 | 7.5 | 15 | 17 | 10 | 9 |
| R412004969 | Ø 6 | R 1/8 | 24.5 | 7.5 | 16 | 21 | 13 | 12 |
| R412004970 | Ø 8 | R 1/8 | 24.5 | 7.5 | 18 | 21.5 | 13 | 14 |
| R412004971 | Ø 6 | R 1/4 | 28.5 | 11 | 16 | 21 | 14 | 12 |
| R412004972 | Ø 8 | R 1/4 | 28.5 | 11 | 18 | 21.5 | 14 | 14 |
| R412004909 | Ø 10 | R 1/4 | 32 | 11 | 19 | 25 | 16 | 16 |
| R412004910 | Ø 10 | R 3/8 | 32.5 | 11.5 | 19 | 25 | 18 | 16 |