



CQ35-25NPP-KW1

CQ

CAPACITIVE PROXIMITY SENSORS

SICK
Sensor Intelligence.



Illustration may differ

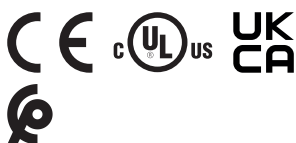

Ordering information

| Type | Part no. |
|----------------|----------|
| CQ35-25NPP-KW1 | 6020478 |

Other models and accessories → www.sick.com/CQ

Detailed technical data

Features

| | |
|--|--|
| Housing | Rectangular |
| Dimensions (W x H x D) | 35 mm x 69.5 mm x 15 mm |
| Sensing range S_n | 4 mm ... 25 mm |
| Safe sensing range S_a | 18 mm |
| Installation type | Non-flush |
| Switching frequency | 50 Hz |
| Connection type | Cable, 4-wire, 2 m ¹⁾ |
| Switching output | PNP |
| Output function | Complementary |
| Electrical wiring | DC 4-wire |
| Adjustment | Potentiometer Sensitivity (270°) |
| Enclosure rating | IP67 ²⁾ |
| Items supplied | Screwdriver for potentiometer adjustment (1 x) |

¹⁾ Do not bend below 0 °C.

²⁾ According to EN 60529.

Mechanics/electronics

| | |
|-----------------------|---------------------|
| Supply voltage | 10 V DC ... 36 V DC |
|-----------------------|---------------------|

¹⁾ Of U_B .

²⁾ At I_a max.

³⁾ Without load.

⁴⁾ Of S_r .

⁵⁾ Supply voltage U_B and constant ambient temperature T_a .

⁶⁾ In EMC critical applications, conducted interference levels may lie within the frequency range of the oscillator. This can cause changes to the output signal. (See operating instructions.).

| | |
|---|---|
| Ripple | ≤ 10 % ¹⁾ |
| Voltage drop | ≤ 2.5 V DC ²⁾ |
| Current consumption | 10 mA ³⁾ |
| Time delay before availability | ≤ 100 ms |
| Hysteresis | 4 % ... 20 % |
| Reproducibility | ≤ 5 % ^{4) 5)} |
| Temperature drift (of S_r) | ± 10 % |
| EMC | According to EN 60947-5-2 ⁶⁾ |
| Continuous current I_a | ≤ 200 mA |
| Cable material | PVC |
| Conductor size | 0.34 mm ² |
| Short-circuit protection | ✓ |
| Power-up pulse protection | ✓ |
| Shock and vibration resistance | 30 g, 11 ms / 10 ... 55 Hz, 1 mm |
| Ambient operating temperature | -25 °C ... +75 °C |
| Housing material | Plastic, PC |
| Sensing face material | Plastic |
| UL File No. | NRKH.E191603 |

¹⁾ Of U_B.

²⁾ At I_a max.

³⁾ Without load.

⁴⁾ Of S_r.

⁵⁾ Supply voltage U_B and constant ambient temperature T_a.

⁶⁾ In EMC critical applications, conducted interference levels may lie within the frequency range of the oscillator. This can cause changes to the output signal. (See operating instructions.).

Safety-related parameters

| | |
|-------------------------------------|-----------|
| MTTF_D | 897 years |
| DC_{avg} | 0 % |
| T_M (mission time) | 20 years |

Reduction factors

| | |
|-----------------|--|
| Note | The values are reference values which may vary |
| Metal | 1 |
| Water | 1 |
| PVC | Approx. 0.4 |
| Oil | Approx. 0.25 |
| Glass | 0.6 |
| Ceramics | 0.5 |
| Alcohol | 0.7 |
| Wood | 0.2 ... 0.7 |

Installation note

| | |
|---------------|---------------------------------------|
| Remark | Associated graphic see "Installation" |
|---------------|---------------------------------------|

| | |
|----------|----------------------------------|
| A | 35 mm |
| B | 35 mm |
| F | 6 x S _n (max. 150 mm) |

Classifications

| | |
|-----------------------|----------|
| ECLASS 5.0 | 27270102 |
| ECLASS 5.1.4 | 27270102 |
| ECLASS 6.0 | 27270102 |
| ECLASS 6.2 | 27270102 |
| ECLASS 7.0 | 27270102 |
| ECLASS 8.0 | 27270102 |
| ECLASS 8.1 | 27270102 |
| ECLASS 9.0 | 27270102 |
| ECLASS 10.0 | 27270102 |
| ECLASS 11.0 | 27270102 |
| ECLASS 12.0 | 27274201 |
| ETIM 5.0 | EC002715 |
| ETIM 6.0 | EC002715 |
| ETIM 7.0 | EC002715 |
| ETIM 8.0 | EC002715 |
| UNSPSC 16.0901 | 39122230 |

Installation note

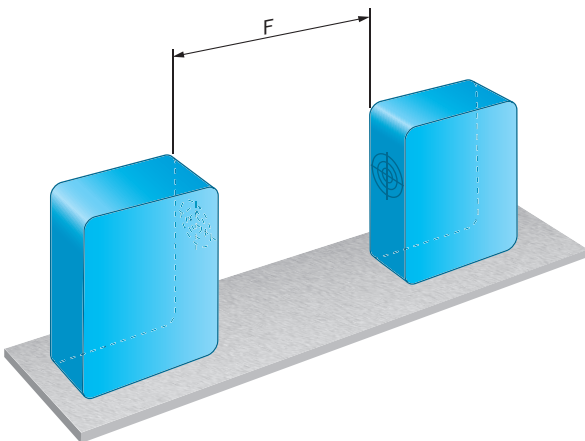

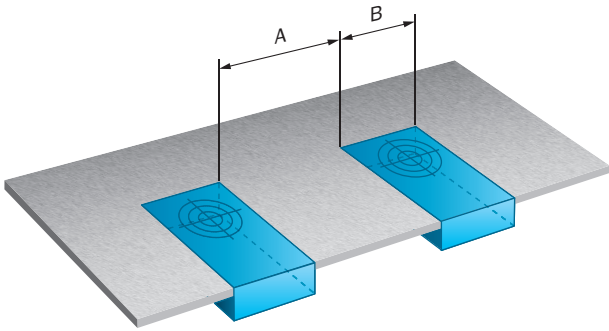

Connection type

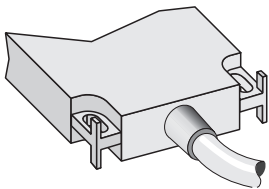

Connection diagram

Cd-005

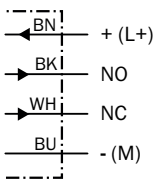

Dimensional drawing (Dimensions in mm (inch))

CQ35, cable

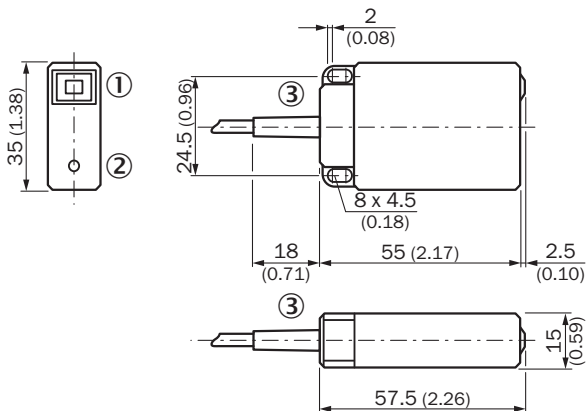

- ① Display LED
- ② Potentiometer
- ③ Connection

SICK AT A GLANCE

SICK is one of the leading manufacturers of intelligent sensors and sensor solutions for industrial applications. A unique range of products and services creates the perfect basis for controlling processes securely and efficiently, protecting individuals from accidents and preventing damage to the environment.

We have extensive experience in a wide range of industries and understand their processes and requirements. With intelligent sensors, we can deliver exactly what our customers need. In application centers in Europe, Asia and North America, system solutions are tested and optimized in accordance with customer specifications. All this makes us a reliable supplier and development partner.

Comprehensive services complete our offering: SICK LifeTime Services provide support throughout the machine life cycle and ensure safety and productivity.

For us, that is “Sensor Intelligence.”

WORLDWIDE PRESENCE:

Contacts and other locations –www.sick.com