



FLX0-GPNT100

Flexi Compact

SAFETY CONTROLLERS

SICK
Sensor Intelligence.



Ordering information

Gateways

Fieldbus	Type	Part no.
PROFINET TCP/IP sockets	FLX0-GPNT100	1085356

Other models and accessories → www.sick.com/Flexi_Compact



Detailed technical data

Features

Module	Gateway
Description	The gateway module enables a safety controller to send data to a network for control and diagnostic purposes, and to receive data from the network.
Fieldbus	PROFINET TCP/IP sockets
Configuration method	Via software (Safety Designer)
Items supplied	Gateway Operating instructions for download

Functions

Integration into a PROFINET network as a field device	✓
Communication of multiple applications with the safety controller via TCP/IP sockets	✓
Configuration of the safety controller via TCP/IP	✓

Interfaces

Configuration and diagnostics	
TCP/IP configuration interface	✓
Configuration via TFT display	✓
Fieldbus	PROFINET TCP/IP sockets
Fieldbus interface	2 x female connector, RJ45
Note	The module is equipped with an integrated switch. The switch enables the module to be connected to another Ethernet component (e.g., to a computer) without having to interrupt the connection of the fieldbus network.
Display elements	TFT display

Electrical data

Protection class	III (EN 61140)
Interference resistance	EN 61000-6-2
Interference emission	EN 61000-6-4
Voltage supply	The voltage supply of the extension modules is maintained via the backplane bus
Power loss	≤ 3.3 W
Current consumption at nominal voltage	135 mA

Mechanical data

Dimensions (W x H x D)	18 mm x 124.7 mm x 85.5 mm
Contamination rating	2 (IEC 61010-1)
Control device type	Open device (IEC 61010-2-201)
Weight	108 g (± 5 %)
Mounting	Mounting on a 35 mm × 7.5 mm mounting rail in accordance with IEC 60715

Ambient data

Enclosure rating	IP20 (EN 60529)
Ambient operating temperature	-25 °C ... +55 °C ¹⁾
Storage temperature	-25 °C ... +70 °C
Air humidity	≤ 95 %, Non-condensing
Vibration resistance	1 g, 5 Hz ... 200 Hz (EN 60068-2-6)
Shock resistance	15 g, 11 ms (EN 60068-2-27)

¹⁾ At altitudes up to 2,000 m above sea level For higher areas of application up to max. 4,000 m above sea level, see the operating instructions.

Classifications

ECLASS 5.0	27243001
ECLASS 5.1.4	27243101
ECLASS 6.0	27243101
ECLASS 6.2	27243101
ECLASS 7.0	27243101
ECLASS 8.0	27243101
ECLASS 8.1	27243101
ECLASS 9.0	27243101
ECLASS 10.0	27243101
ECLASS 11.0	27243101
ECLASS 12.0	27243101
ETIM 5.0	EC001449
ETIM 6.0	EC001449
ETIM 7.0	EC001449
ETIM 8.0	EC001449
UNSPSC 16.0901	32151705

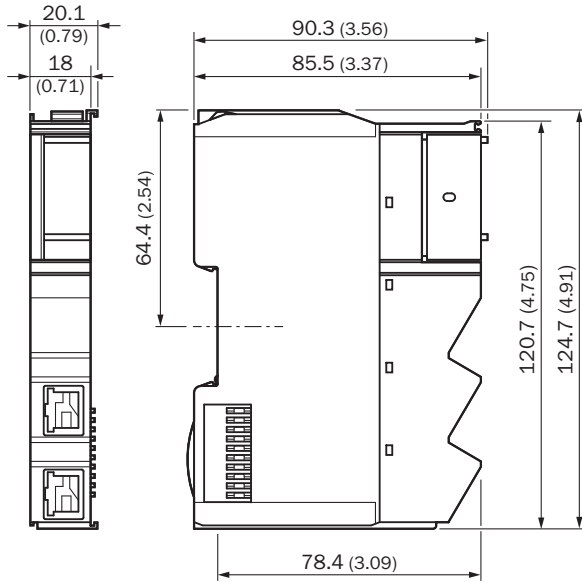

Dimensional drawing (Dimensions in mm (inch))

GETC1, GPNT1 gateways



Recommended accessories

Other models and accessories → www.sick.com/Flexi_Compact

	Brief description	Type	Part no.
Safety switching amplifier			
	<ul style="list-style-type: none"> Applications: Output expansion module for OSSDs Compatible sensor types: Safety sensors with OSSDs Connection type: Front connector with spring terminals Restart interlock: no External device monitoring (EDM): Via path Outputs: 2 enabling current paths (safe), 1 feedback current path (for use as external device monitoring, not safe) Housing width: 18 mm 	RLY3-OSSD100	1085343
	<ul style="list-style-type: none"> Applications: Output expansion module for OSSDs Compatible sensor types: Safety sensors with OSSDs Connection type: Front connector with spring terminals Restart interlock: no External device monitoring (EDM): Via path Outputs: 4 enabling current paths (safe), 1 feedback current path (for use as external device monitoring, not safe), 1 signaling current path (not safe) Housing width: 28 mm 	RLY3-OSSD400	1099971

SICK AT A GLANCE

SICK is one of the leading manufacturers of intelligent sensors and sensor solutions for industrial applications. A unique range of products and services creates the perfect basis for controlling processes securely and efficiently, protecting individuals from accidents and preventing damage to the environment.

We have extensive experience in a wide range of industries and understand their processes and requirements. With intelligent sensors, we can deliver exactly what our customers need. In application centers in Europe, Asia and North America, system solutions are tested and optimized in accordance with customer specifications. All this makes us a reliable supplier and development partner.

Comprehensive services complete our offering: SICK LifeTime Services provide support throughout the machine life cycle and ensure safety and productivity.

For us, that is “Sensor Intelligence.”

WORLDWIDE PRESENCE:

Contacts and other locations –www.sick.com