



# HW1980IFR-3SER KIT

HW19

MOBILE HANDHELD SCANNERS

**SICK**  
Sensor Intelligence.



### Ordering information

Type	Part no.
HW1980IFR-3SER KIT	6059466

**Included in delivery:** Connection cable (male connector-female connector) (1), HW1980IFR-3 (1)

A country-specific power supply unit may be required for operation (see "Recommended accessories").

Other models and accessories → [www.sick.com/HW19](http://www.sick.com/HW19)



### Detailed technical data

#### Features

<b>Version</b>	Full Range Focus
<b>Application</b>	Industrial application
<b>Scanner design</b>	Cable connection variant
<b>Sensor resolution</b>	1,280 px x 800 px
<b>Light source</b>	LED, Visible, Red, 624 nm, ± 18 nm
<b>Alignment aid</b>	Laser, Red, 650 nm
<b>Reading distance</b>	150 mm ... 16,000 mm
<b>Code resolution</b>	≥ 0.05 mm <sup>1)</sup> ≥ 2 mm <sup>2)</sup>

<sup>1)</sup> Close range.

<sup>2)</sup> Distance range.

#### Mechanics/electronics

<b>Supply voltage</b>	4 V DC ... 5.5 V DC
<b>Current consumption</b>	Operation at 5 V DC: 470 mA Standby: 100 mA
<b>Housing material</b>	Plastic (UL 94 V-0)
<b>Housing color</b>	Orange, gray
<b>Enclosure rating</b>	IP65
<b>Weight</b>	335 g
<b>Dimensions (L x W x H)</b>	133 mm x 75 mm x 195 mm

#### Performance

<b>Readable code structures</b>	1D codes, 2D codes, Stacked
<b>Bar code types</b>	Code 39, Code 39 Trioptic, Code 32, Code 93, Code 11, Codabar, Code 128, GS1-128 / EAN 128, UPC / EAN / JAN (with addition), MSI/Plessey, UK/Plessey, IATA, Interleaved 2 of 5, Standard and Industrial 2 of 5, Matrix 2 of 5, Telepen, GS1 DataBar, Australian Post, China Post, German Post, US Planet, US Postnet, British Post, Intelligent Mail, Japan Post, Korean Post, Dutch KIX Post
<b>2D code types</b>	Data Matrix, QR code, MicroQR-Code, Aztec, MaxiCode

<b>Stacked code types</b>	PDF417, MicroPDF417, Code 49, Code 16K, Composite, Codablock F
<b>Code alignment</b>	Omni-directional

### Interfaces

<b>Ethernet</b>	✓, TCP/IP
Type of fieldbus integration	Optional over external fieldbus module CDF600-2
<b>PROFINET</b>	✓
Type of fieldbus integration	Optional over external fieldbus module CDF600-2
Function	PROFINET Single Port, PROFINET Dual Port
<b>EtherCAT</b>	✓
Type of fieldbus integration	Optional over external fieldbus module CDF600
<b>Serial</b>	✓, RS-232 TTL
Remark	RS-232 (± 12 V)
<b>PROFIBUS DP</b>	✓
Type of fieldbus integration	Optional over external fieldbus module CDF600-2
<b>Optical indicators</b>	2 LEDs (good read, charge of battery, radio connection status)
<b>Acoustic indicators</b>	Beeper, can be switched off
<b>Vibration</b>	Yes
<b>Configuration software</b>	EZConfig Tool

### Ambient data

<b>Shock resistance</b>	50 drop tests onto concrete from a height of 2 m at -30 °C
<b>Ambient operating temperature</b>	-30 °C ... +50 °C
<b>Storage temperature</b>	-40 °C ... +70 °C
<b>Permissible relative humidity</b>	95 %, Non-condensing
<b>Ambient light immunity</b>	100,000 lx
<b>Bar code print contrast (PCS)</b>	≥ 40 %

### Classifications

<b>ECLASS 5.0</b>	27280101
<b>ECLASS 5.1.4</b>	27280101
<b>ECLASS 6.0</b>	27280101
<b>ECLASS 6.2</b>	27280101
<b>ECLASS 7.0</b>	27280101
<b>ECLASS 8.0</b>	27280101
<b>ECLASS 8.1</b>	27280101
<b>ECLASS 9.0</b>	27280101
<b>ECLASS 10.0</b>	27280101
<b>ECLASS 11.0</b>	27280101
<b>ECLASS 12.0</b>	27280101
<b>ETIM 5.0</b>	EC002550
<b>ETIM 6.0</b>	EC002550
<b>ETIM 7.0</b>	EC002550
<b>ETIM 8.0</b>	EC002550

UNSPSC 16.0901

43211701

### Connection diagram

PROFINET IO/RT

### PROFINET IO/RT

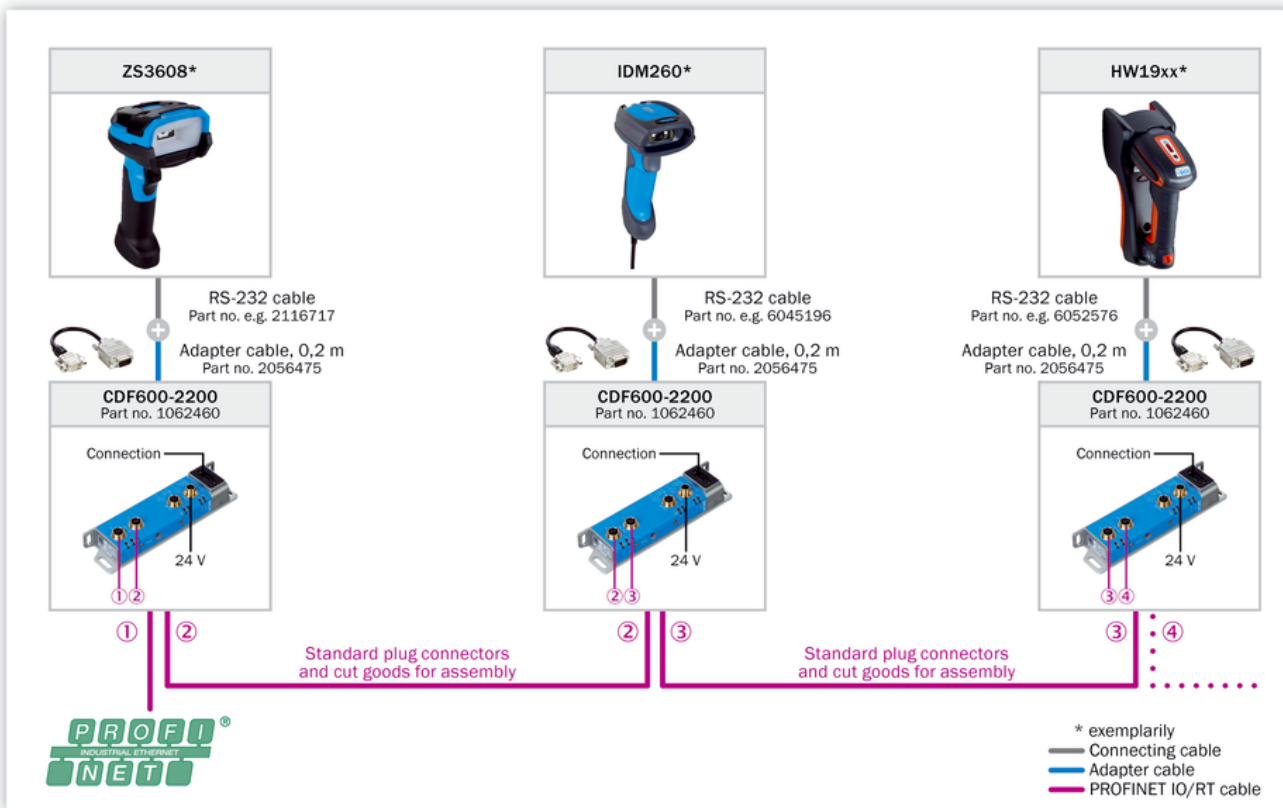

### PROFIBUS DP

### PROFIBUS DP

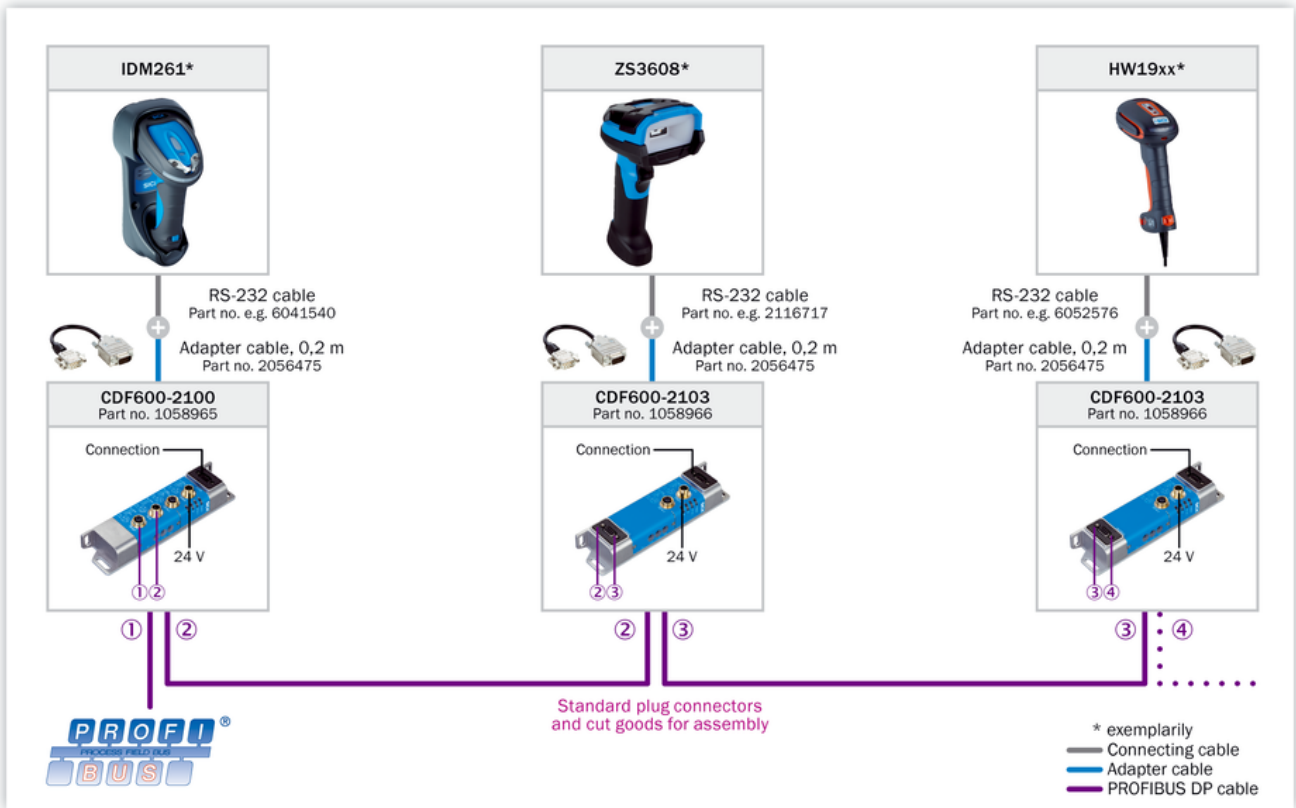

EtherCAT®

EtherCAT®

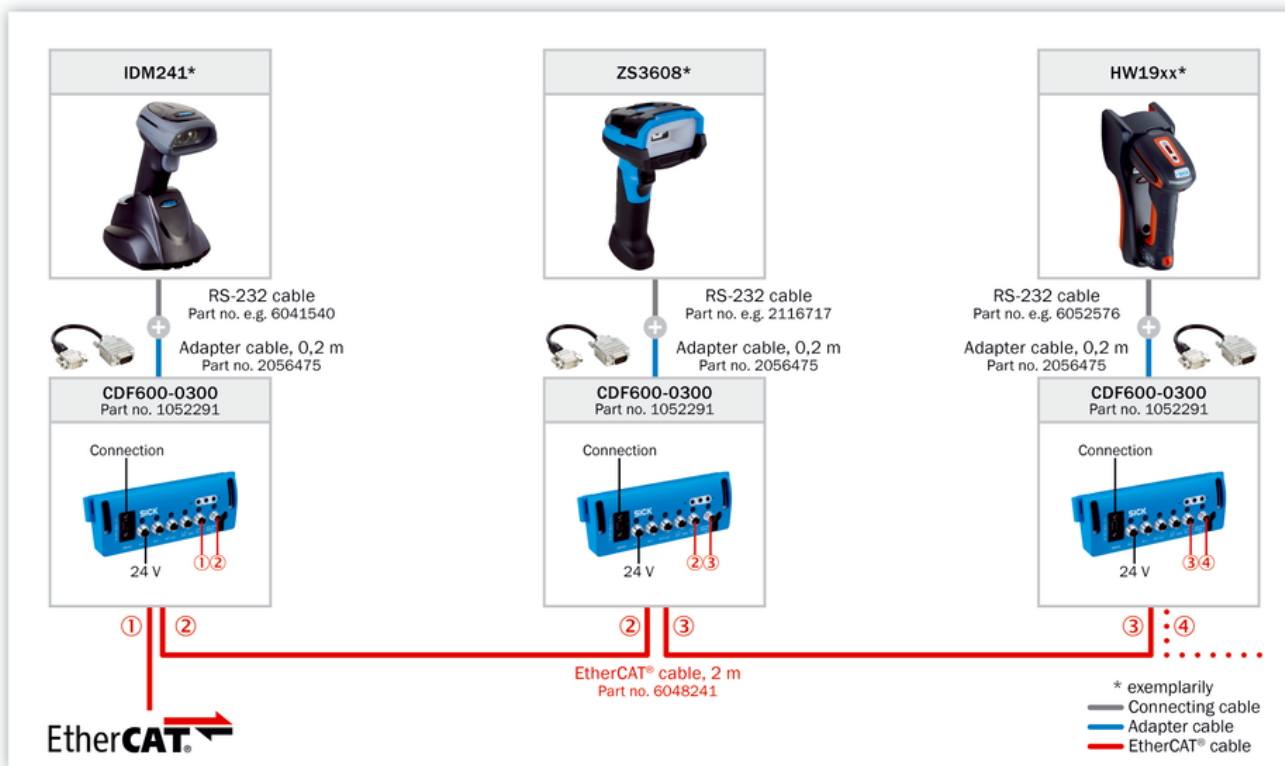

AUX looping

Looping-in via AUX

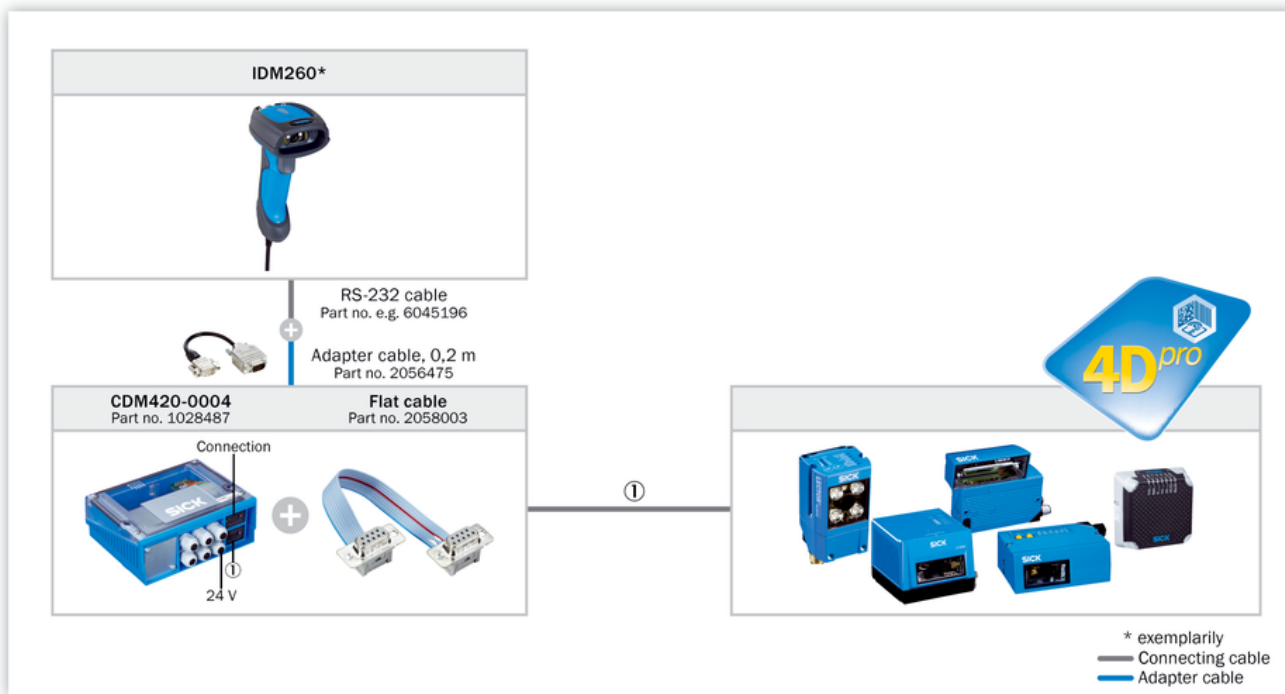

Selection Guide



\*) For EtherNet/IP third party gateway is required from e.g. Control or HMS (requires local sourcing).

Recommended accessories

Other models and accessories → [www.sick.com/HW19](http://www.sick.com/HW19)

	Brief description	Type	Part no.
<b>Others</b>			
	<ul style="list-style-type: none"> <li><b>Connection type head A:</b> Male connector, USB-A</li> <li><b>Connection type head B:</b> Male connector, RJ45</li> <li><b>Signal type:</b> USB</li> <li><b>Cable:</b> 3 m, coiled cable</li> <li><b>Description:</b> USB, Keyboard connector or USB Com Port Emulation, 5 V host power (Honeywell CBL-500-300-C00)</li> </ul>	USB cable	6052577
	<ul style="list-style-type: none"> <li><b>Connection type head A:</b> Female connector, D-Sub, 9-pin, straight</li> <li><b>Connection type head B:</b> Male connector, RJ45</li> <li><b>Signal type:</b> RS-232 TTL</li> <li><b>Cable:</b> 3 m, coiled cable</li> <li><b>Description:</b> RS-232 TTL, 5 V external voltage supply with option for host voltage supply on pin 9, industrial grade (Honeywell CBL-020-300-C00-01)</li> </ul>	Connection cable (male connector-female connector)	6064034
	<ul style="list-style-type: none"> <li><b>Connection type head A:</b> Male connector, USB-A</li> <li><b>Connection type head B:</b> Male connector, RJ45</li> <li><b>Signal type:</b> USB</li> <li><b>Cable:</b> 3 m, straightened cable</li> <li><b>Description:</b> USB, Keyboard connector or USB Com Port Emulation, 5 V host power, industrial grade (Honeywell CBL-500-300-S00-01)</li> </ul>	USB cable	6064633

## SICK AT A GLANCE

SICK is one of the leading manufacturers of intelligent sensors and sensor solutions for industrial applications. A unique range of products and services creates the perfect basis for controlling processes securely and efficiently, protecting individuals from accidents and preventing damage to the environment.

We have extensive experience in a wide range of industries and understand their processes and requirements. With intelligent sensors, we can deliver exactly what our customers need. In application centers in Europe, Asia and North America, system solutions are tested and optimized in accordance with customer specifications. All this makes us a reliable supplier and development partner.

Comprehensive services complete our offering: SICK LifeTime Services provide support throughout the machine life cycle and ensure safety and productivity.

For us, that is “Sensor Intelligence.”

## WORLDWIDE PRESENCE:

Contacts and other locations –[www.sick.com](http://www.sick.com)