



IDM240-411S RS232 Kit

IDM

MOBILE HANDHELD SCANNERS

SICK
Sensor Intelligence.



Ordering information

| Type | Part no. |
|-----------------------|----------|
| IDM240-411S RS232 Kit | 6080737 |

Included in delivery: IDM240-411S (1), Connection cable (1)

Other models and accessories → www.sick.com/IDM



Detailed technical data

Features

| | |
|--------------------------|--|
| Application | Standard application |
| Scanner design | Cable connection variant |
| Sensor resolution | 1,280 px x 800 px |
| Light source | LED, Visible, Red, 660 nm |
| Alignment aid | LED, green, 660 nm |
| Reading distance | 30 mm ... 400 mm |
| Code resolution | ≥ 0.07 mm ¹⁾ ≥ 0.13 mm ²⁾ |

¹⁾ Valid for Code 39.

²⁾ Valid for Data Matrix code.

Mechanics/electronics

| | |
|-------------------------------|--------------------------------------|
| Supply voltage | 5 V DC, ± 10 % |
| Current consumption | Operation: 395 mA Standby: 220 mA |
| Housing color | Black, Gray |
| Enclosure rating | IP52 |
| Weight | 152 g, without cable |
| Dimensions (L x W x H) | 95 mm x 70.5 mm x 161.7 mm |
| MTBF | 100,000 h |

Performance

| | |
|---------------------------------|---|
| Readable code structures | 1D codes, 2D codes, Stacked |
| Bar code types | Code 39, Code 39 Full ASCII, Code 32, Code 128, GS1-128, Codabar, Code 11, Code 93, GS1 DataBar, Standard and Industrial 2 of 5, Interleaved & Matrix 2 of 5, IATA, UPC / EAN / JAN, UPC / EAN / JAN (with addition), Telepen, MSI/Plessey, UK/Plessey, Australian Post, China Post, German Post, US Planet, US Postnet, British Post, Intelligent Mail, Japan Post, Korea Post, Dutch KIX Post, Posi LAPA 4 State Code |
| 2D code types | Data Matrix, MaxiCode, QR code, Aztec, MicroQR-Code, GS1 QR code, GS1 Data-Matrix |
| Stacked code types | PDF417, MicroPDF417, Code 49, Code 16K, Composite, Codablock F |

Interfaces

| | | |
|-------------------------------|------------------------------|--|
| Ethernet | | ✓, TCP/IP |
| | Type of fieldbus integration | Optional, over external connection module CDF600-2 |
| PROFINET | | ✓ |
| | Type of fieldbus integration | Optional over external fieldbus module CDF600-2 |
| | Function | PROFINET Single Port, PROFINET Dual Port |
| EtherCAT | | ✓ |
| | Type of fieldbus integration | Optional over external fieldbus module CDF600 |
| Serial | | ✓, RS-232 |
| PROFIBUS DP | | ✓ |
| | Type of fieldbus integration | Optional over external fieldbus module CDF600-2 |
| Optical indicators | | 2 LEDs (operational status, good read) |
| Acoustic indicators | | Beeper, can be switched off |
| Vibration | | No |
| Configuration software | | IDM Setup Tool |

Ambient data

| | |
|--------------------------------------|--|
| Shock resistance | 25 drops from 1.8 m height on concrete |
| Ambient operating temperature | -10 °C ... +50 °C |
| Storage temperature | -40 °C ... +70 °C |
| Permissible relative humidity | 95 %, Non-condensing |
| Ambient light immunity | 100,000 lx |

General notes

| | |
|-------------|---|
| Note | A power supply unit may also be required for commissioning. Not free of paint wetting impairment substances. |
|-------------|---|

Classifications

| | |
|-----------------------|----------|
| ECLASS 5.0 | 27280101 |
| ECLASS 5.1.4 | 27280101 |
| ECLASS 6.0 | 27280101 |
| ECLASS 6.2 | 27280101 |
| ECLASS 7.0 | 27280101 |
| ECLASS 8.0 | 27280101 |
| ECLASS 8.1 | 27280101 |
| ECLASS 9.0 | 27280101 |
| ECLASS 10.0 | 27280101 |
| ECLASS 11.0 | 27280101 |
| ECLASS 12.0 | 27280101 |
| ETIM 5.0 | EC002550 |
| ETIM 6.0 | EC002550 |
| ETIM 7.0 | EC002550 |
| ETIM 8.0 | EC002550 |
| UNSPSC 16.0901 | 43211701 |

Connection diagram

PROFINET IO/RT

PROFINET IO/RT

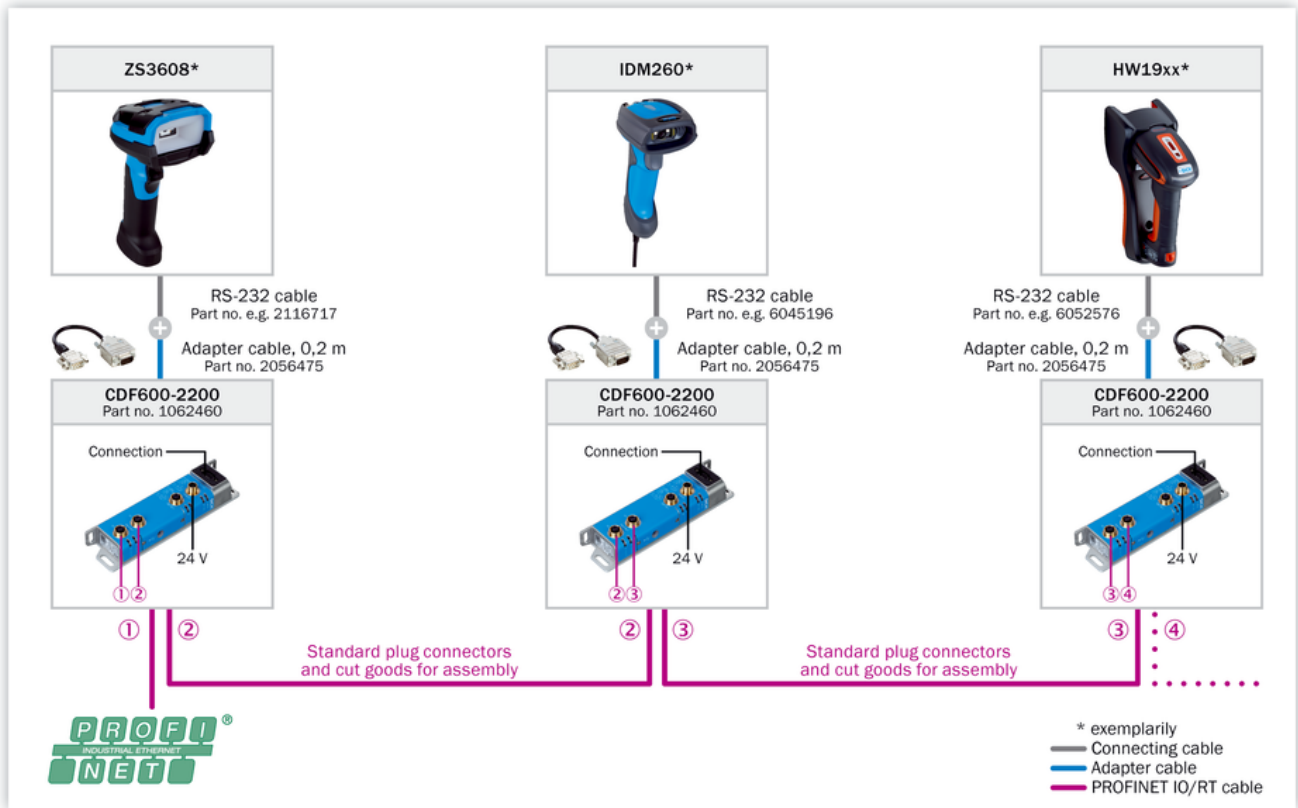

PROFIBUS DP

PROFIBUS DP

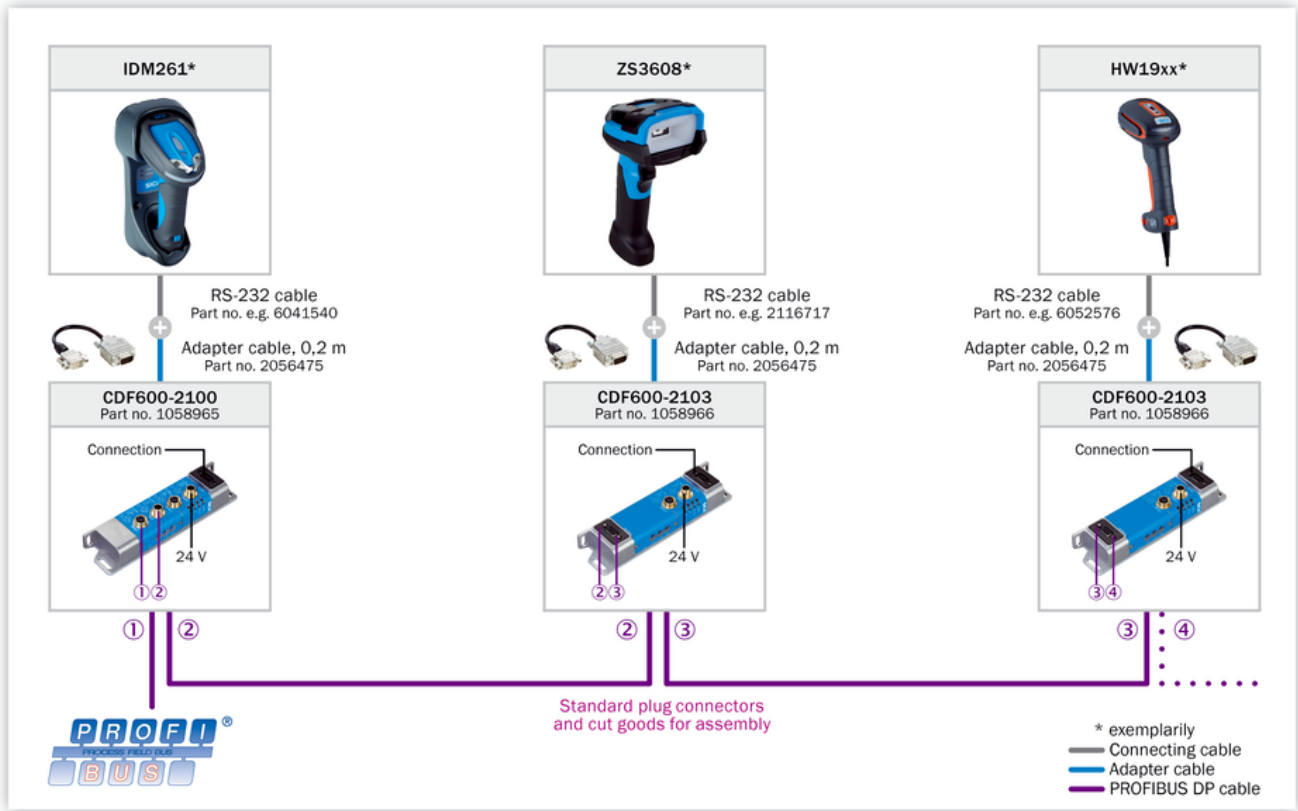

Ethernet TCP/IP

Ethernet TCP/IP

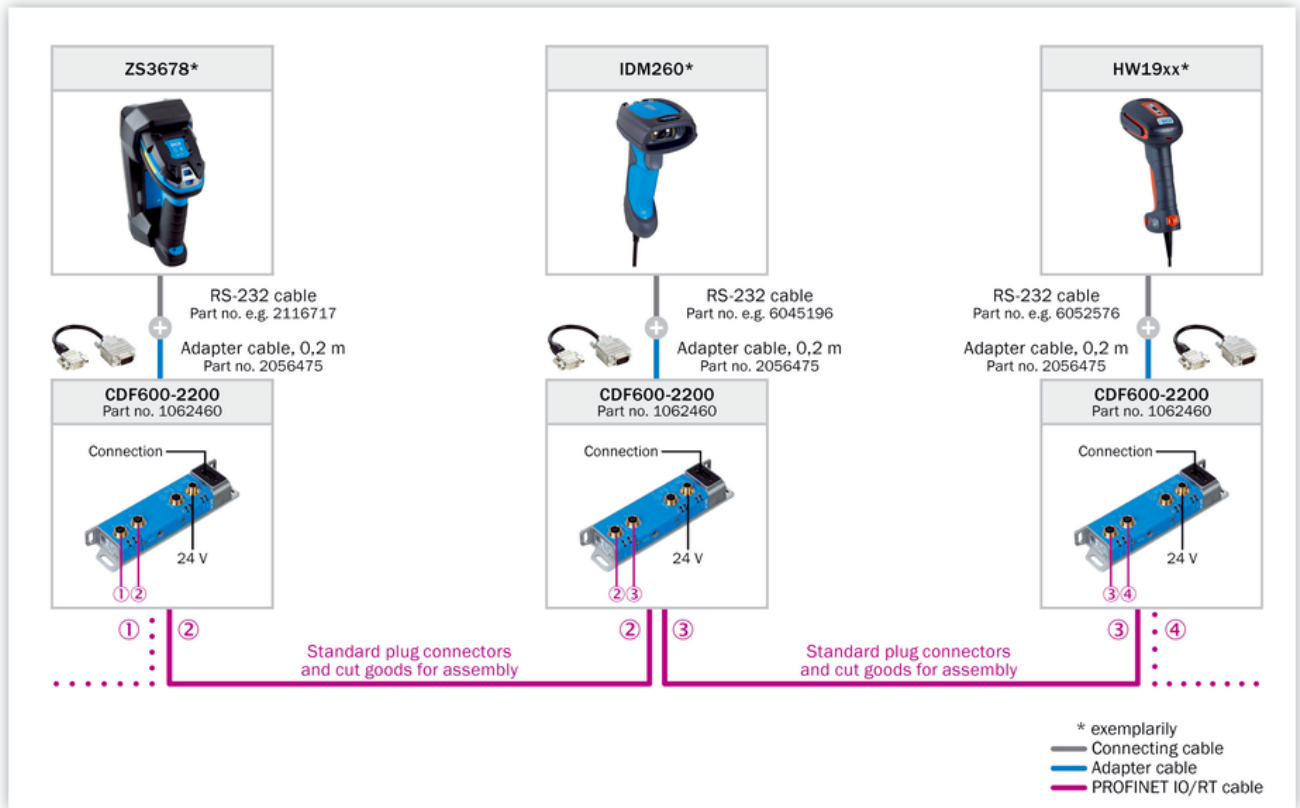

EtherCAT®

EtherCAT®

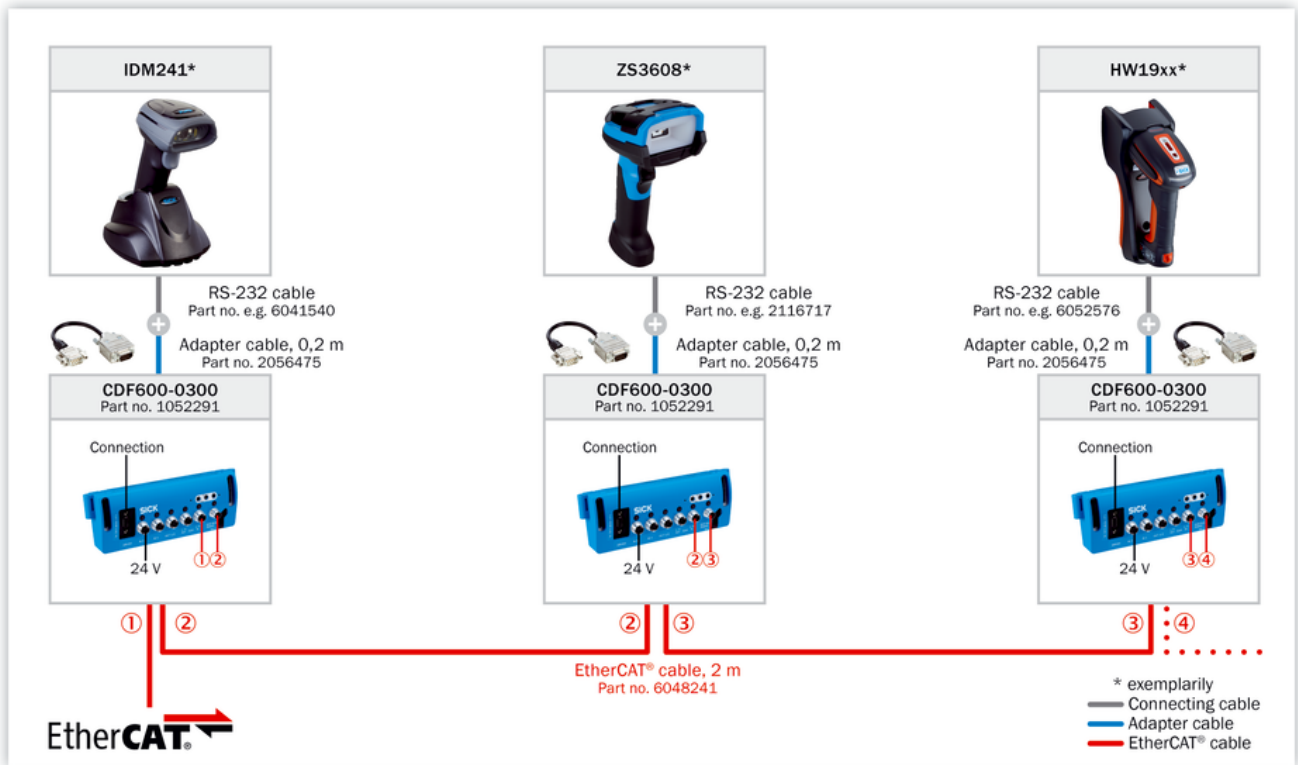

AUX looping

Looping-in via AUX

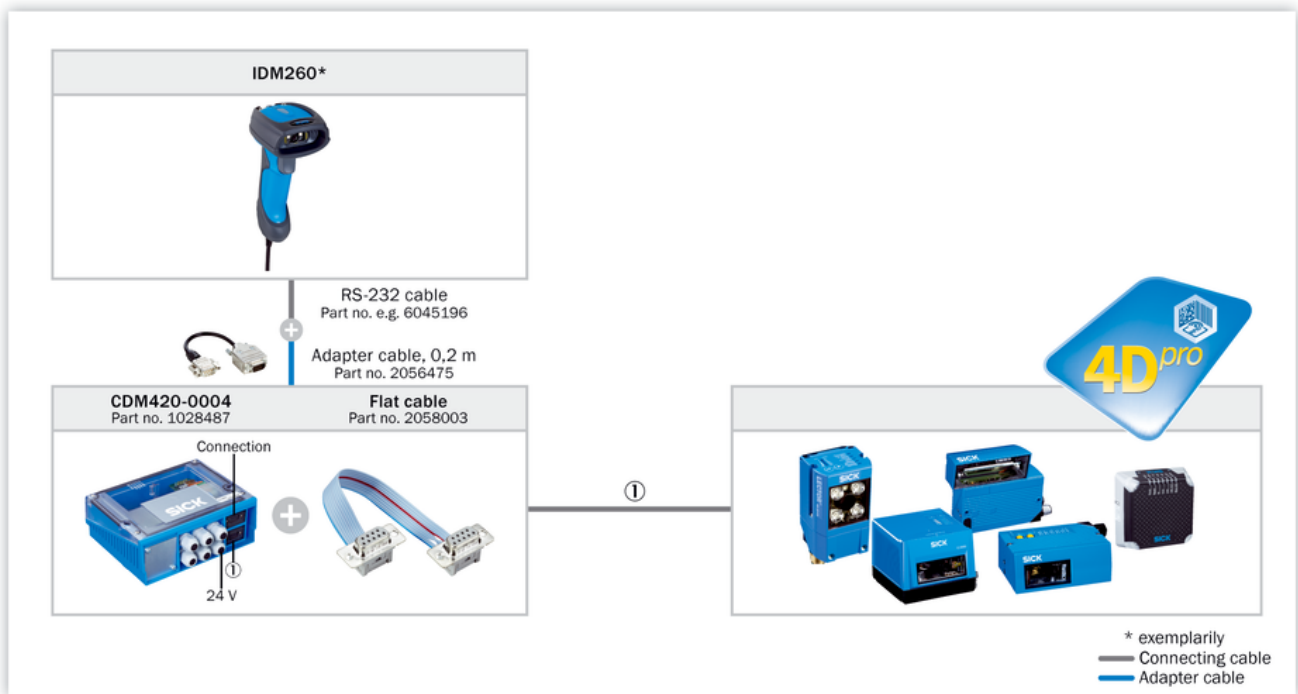

Selection Guide



*1) For EtherNet/IP third party gateway is required from e.g. Control or HMS (requires local sourcing).

Recommended accessories

Other models and accessories → www.sick.com/IDM

| | Brief description | Type | Part no. |
|-----------------------------------|---|--------------------------------|----------|
| Fieldbus modules | | | |
| | Connection kit for connecting a hand-held scanner to a PROFINET (Siemens) interface | Hand-held scanner PROFINET kit | 1101488 |
| | Adapter for connecting a handheld scanner to CDB620 / CDM420 / CDF600 / CD-F600-2, D-Sub 9-pin male connector, D-Sub 15-pin male connector, including 24V / 5V DC converter, AUX port adapter, for handheld scanners to CDB620/CDM420/ CDF600/CD-F600-2, adapter AUX port | YMH DAC-C30XXXMSA9 | 2056475 |
| Other mounting accessories | | | |
| | Tripod mount | Stand mount | 6036724 |
| | Power supply, input AC 100 ... 240 V, output DC 5 V/2 A (necessary when using RS-232 TTL cable, does not fulfill medical standard EN 60601/ IEC 60601)) | Power supply unit | 6036722 |

Recommended services

Additional services → www.sick.com/IDM

| | Type | Part no. |
|---|--|----------|
| Extended warranty | | |
| <ul style="list-style-type: none">• Product area: Machine vision, LiDAR sensors, safety camera sensors, Safety laser scanners, Safety radar sensors, Radar sensors, Fixed mount barcode scanners, Image-based code readers, RFID, Mobile handheld scanners• Range of services: The services correspond to the scope of the statutory manufacturer warranty (SICK general terms of delivery).• Duration: Five-year warranty from delivery date. | Extended warranty for a total of five years from delivery date | 1680671 |

SICK AT A GLANCE

SICK is one of the leading manufacturers of intelligent sensors and sensor solutions for industrial applications. A unique range of products and services creates the perfect basis for controlling processes securely and efficiently, protecting individuals from accidents and preventing damage to the environment.

We have extensive experience in a wide range of industries and understand their processes and requirements. With intelligent sensors, we can deliver exactly what our customers need. In application centers in Europe, Asia and North America, system solutions are tested and optimized in accordance with customer specifications. All this makes us a reliable supplier and development partner.

Comprehensive services complete our offering: SICK LifeTime Services provide support throughout the machine life cycle and ensure safety and productivity.

For us, that is “Sensor Intelligence.”

WORLDWIDE PRESENCE:

Contacts and other locations –www.sick.com