

# IM30-20B-A-ZC1

IMA

**INDUCTIVE PROXIMITY SENSORS**

**SICK**  
Sensor Intelligence.

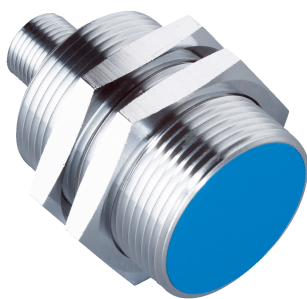

Illustration may differ



## Ordering information

| Type           | Part no. |
|----------------|----------|
| IM30-20B-A-ZC1 | 6033125  |

Other models and accessories → [www.sick.com/IMA](http://www.sick.com/IMA)

## Detailed technical data

### Features

|  |  |
|--|--|
| <b>Housing</b>                                       | Metric   |
| <b>Thread size</b>                                   | M30 x 1.5  |
| <b>Diameter</b>                                      | Ø 30 mm  |
| <b>Sensing range <math>S_n</math></b>                | 0 mm ... 20 mm   |
| <b>Installation type</b>                             | Quasi-flush  |
| <b>Connection type</b>                               | Male connector M12, 4-pin  |
| <b>Repeatability (<math>T_a</math> not constant)</b> | 0.3 mm <sup>1) 2) 3)</sup>   |
| <b>Repeatability (<math>T_a</math> constant)</b>     | ± 0.05 mm  |
| <b>Resolution</b>                                    | ≤ 5 µm   |
| <b>Enclosure rating</b>                              | IP67 <sup>4)</sup>   |
| <b>Special features</b>                              | Analog output  |
| <b>Items supplied</b>                                | Mounting nut, brass, chromium-plated (2x)<br>Toothed washer, stainless steel (2 x) |

<sup>1)</sup> As per IEC 60947-5-2.

<sup>2)</sup>  $U_b = DC 20 V \dots 30 V$ .

<sup>3)</sup>  $T_A = 23 \text{ °C} \pm 5 \text{ °C}$ .

<sup>4)</sup> According to EN 60529: 2000-09.

### Mechanics/electronics

|  |                      |
|--|----------------------|
| <b>Supply voltage</b>                          | 15 V DC ... 30 V DC  |
| <b>Ripple</b>                                  | ≤ 20 % <sup>1)</sup> |
| <b>Time delay before availability</b>          | ≤ 50 ms              |
| <b>Temperature drift (of <math>S_n</math>)</b> | ≤ 10 %               |

<sup>1)</sup> Of  $V_S$ .

<sup>2)</sup> Without load.

<sup>3)</sup> At voltage output QA1.

<sup>4)</sup> -3 dB if  $S_n = 10 \text{ mm}$ .

<sup>5)</sup> QA1 loaded, QA2 unloaded.

<sup>6)</sup> QA1 loaded, QA2 loaded: see temperature reduction.

|                                      |  |
|--------------------------------------|--|
| <b>No load current</b>               | $\leq 12 \text{ mA}^{2)}$  |
| <b>Load current</b>                  | $\pm 10 \text{ mA}^{3)}$   |
| <b>Max. load resistance</b>          | $\leq 400 \Omega \text{ Ub} = 15 \text{ V}$<br>$\leq 1,000 \Omega \text{ Ub} = 30 \text{ V}$             |
| <b>Output voltage Q<sub>A1</sub></b> | s = 0 mm: 0 V/-0 +0,4 V (23 °C)<br>s = 10 mm: +5,2 V/ +0,4 V (23 °C)<br>s = 20 mm: +10 V/ +0,4 V (23 °C) |
| <b>Output current Q<sub>A2</sub></b> | s = 0 mm: 4 mA/ +0,8 mA (23 °C)<br>s = 20 mm: 20 mA +/-0,8 mA (23 °C)                                    |
| <b>Output voltage</b>                | 0 V ... 10 V   |
| <b>Bandwidth</b>                     | 200 Hz <sup>4)</sup>   |
| <b>Short-circuit protection</b>      | ✓  |
| <b>Ambient operating temperature</b> | -25 °C ... +70 °C <sup>5) 6)</sup>   |
| <b>Housing material</b>              | Brass, chromium-plated   |
| <b>Sensing face material</b>         | Plastic, PTB   |
| <b>Housing length</b>                | 73.5 mm  |
| <b>Thread length</b>                 | 52 mm  |

1) Of V<sub>S</sub>.

2) Without load.

3) At voltage output QA1.

4) -3 dB if S<sub>n</sub> = 10 mm.

5) QA1 loaded, QA2 unloaded.

6) QA1 loaded, QA2 loaded: see temperature reduction.

#### Safety-related parameters

|                                     |          |
|-------------------------------------|----------|
| <b>MTTF<sub>D</sub></b>             | 87 years |
| <b>DC<sub>avg</sub></b>             | 0%       |
| <b>T<sub>M</sub> (mission time)</b> | 20 years |

#### Reduction factors

|                                   |  |
|-----------------------------------|--|
| <b>Note</b>                       | The values are reference values which may vary |
| <b>Stainless steel (V2A, 304)</b> | Approx. 0.65                                   |
| <b>Aluminum (Al)</b>              | Approx. 0.2                                    |
| <b>Copper (Cu)</b>                | Approx. 0.17                                   |
| <b>Brass (Br)</b>                 | Approx. 0.3                                    |

#### Installation note

|               |                                       |
|---------------|---------------------------------------|
| <b>Remark</b> | Associated graphic see "Installation" |
|---------------|---------------------------------------|

#### Classifications

|                     |          |
|---------------------|----------|
| <b>ECLASS 5.0</b>   | 27270101 |
| <b>ECLASS 5.1.4</b> | 27270101 |
| <b>ECLASS 6.0</b>   | 27270101 |
| <b>ECLASS 6.2</b>   | 27270101 |
| <b>ECLASS 7.0</b>   | 27270101 |
| <b>ECLASS 8.0</b>   | 27270101 |
| <b>ECLASS 8.1</b>   | 27270101 |

|                       |          |
|-----------------------|----------|
| <b>ECLASS 9.0</b>     | 27270101 |
| <b>ECLASS 10.0</b>    | 27270101 |
| <b>ECLASS 11.0</b>    | 27270101 |
| <b>ECLASS 12.0</b>    | 27274001 |
| <b>ETIM 5.0</b>       | EC002714 |
| <b>ETIM 6.0</b>       | EC002714 |
| <b>ETIM 7.0</b>       | EC002714 |
| <b>ETIM 8.0</b>       | EC002714 |
| <b>UNSPSC 16.0901</b> | 39122230 |

### Installation note

Flush installation

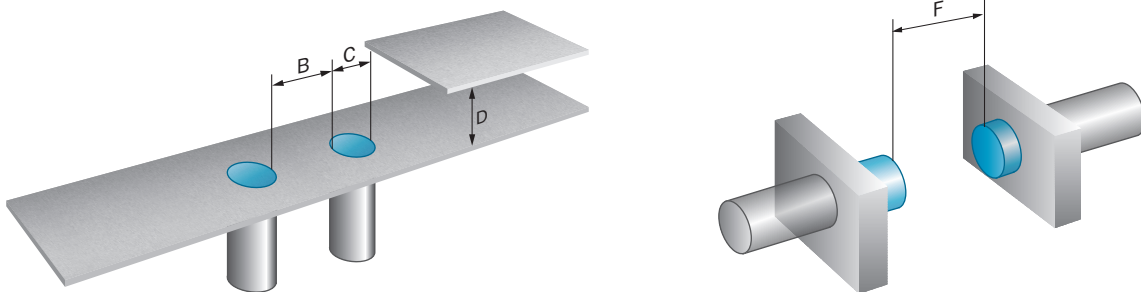

### Connection type

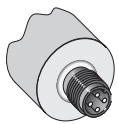

### Connection diagram

Cd-022

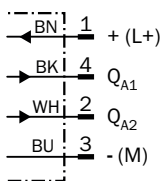

### Temperature derating

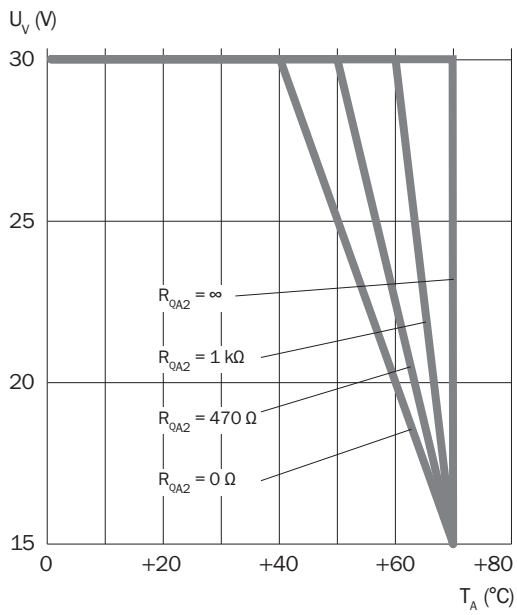

### Response diagram

IMA30

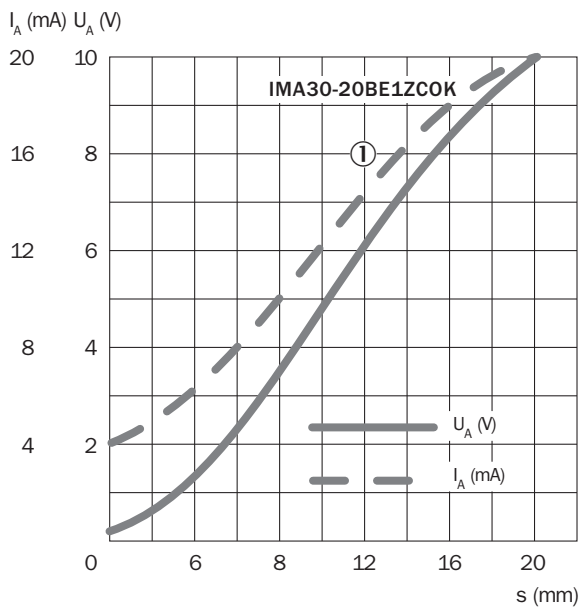

① St37 (FE)

**Dimensional drawing** (Dimensions in mm (inch))

IMA30, connector, quasi-flush

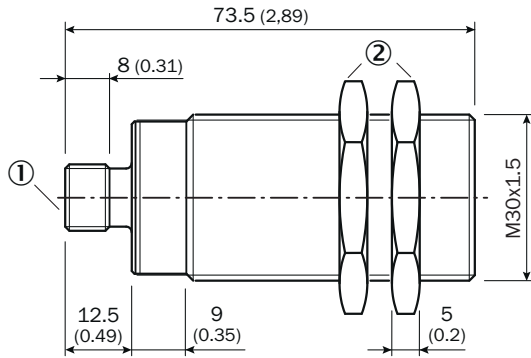





- ① Connection
- ② Fastening nuts (2x); width across 36, metal

**Recommended accessories**

Other models and accessories → [www.sick.com/IMA](http://www.sick.com/IMA)

|                                     | Brief description   | Type               | Part no. |
|-------------------------------------|---|--------------------|----------|
| <b>Mounting brackets and plates</b> |   |                    |          |
|                                     | Mounting plate for M30 sensors, steel, zinc coated, without mounting hardware   | BEF-WG-M30         | 5321871  |
|                                     | Mounting bracket for M30 sensors, steel, zinc coated, without mounting hardware   | BEF-WN-M30         | 5308445  |
| <b>Others</b>                       |   |                    |          |
|                                     | <ul style="list-style-type: none"> <li>• <b>Connection type head A:</b> Female connector, M12, 4-pin, straight, A-coded</li> <li>• <b>Connection type head B:</b> Flying leads</li> <li>• <b>Signal type:</b> Sensor/actuator cable</li> <li>• <b>Cable:</b> 2 m, 4-wire, PVC</li> <li>• <b>Description:</b> Sensor/actuator cable, unshielded</li> <li>• <b>Application:</b> Zones with chemicals</li> </ul> | YF2A14-020VB3XLEAX | 2096234  |
|                                     | <ul style="list-style-type: none"> <li>• <b>Connection type head A:</b> Female connector, M12, 4-pin, straight, A-coded</li> <li>• <b>Connection type head B:</b> Flying leads</li> <li>• <b>Signal type:</b> Sensor/actuator cable</li> <li>• <b>Cable:</b> 5 m, 4-wire, PVC</li> <li>• <b>Description:</b> Sensor/actuator cable, unshielded</li> <li>• <b>Application:</b> Zones with chemicals</li> </ul> | YF2A14-050VB3XLEAX | 2096235  |
|                                     | <ul style="list-style-type: none"> <li>• <b>Connection type head A:</b> Female connector, M12, 4-pin, angled, A-coded</li> <li>• <b>Connection type head B:</b> Flying leads</li> <li>• <b>Signal type:</b> Sensor/actuator cable</li> <li>• <b>Cable:</b> 2 m, 4-wire, PVC</li> <li>• <b>Description:</b> Sensor/actuator cable, unshielded</li> <li>• <b>Application:</b> Zones with chemicals</li> </ul>   | YG2A14-020VB3XLEAX | 2095895  |
|                                     | <ul style="list-style-type: none"> <li>• <b>Connection type head A:</b> Female connector, M12, 4-pin, angled, A-coded</li> <li>• <b>Connection type head B:</b> Flying leads</li> <li>• <b>Signal type:</b> Sensor/actuator cable</li> <li>• <b>Cable:</b> 5 m, 4-wire, PVC</li> <li>• <b>Description:</b> Sensor/actuator cable, unshielded</li> <li>• <b>Application:</b> Zones with chemicals</li> </ul>   | YG2A14-050VB3XLEAX | 2095897  |

|   | Brief description  | Type               | Part no. |
|---|--|--------------------|----------|
|  | <ul style="list-style-type: none"> <li>• <b>Connection type head A:</b> Female connector, M12, 4-pin, straight, A-coded</li> <li>• <b>Connection type head B:</b> Flying leads</li> <li>• <b>Signal type:</b> Sensor/actuator cable</li> <li>• <b>Cable:</b> 2 m, 4-wire, PUR, halogen-free</li> <li>• <b>Description:</b> Sensor/actuator cable, unshielded</li> <li>• <b>Application:</b> Zones with oils and lubricants, Drag chain operation, Robot</li> </ul> | YF2A14-020UB3XLEAX | 2095607  |
|  | <ul style="list-style-type: none"> <li>• <b>Connection type head A:</b> Female connector, M12, 4-pin, straight, A-coded</li> <li>• <b>Connection type head B:</b> Flying leads</li> <li>• <b>Signal type:</b> Sensor/actuator cable</li> <li>• <b>Cable:</b> 5 m, 4-wire, PUR, halogen-free</li> <li>• <b>Description:</b> Sensor/actuator cable, unshielded</li> <li>• <b>Application:</b> Zones with oils and lubricants, Drag chain operation, Robot</li> </ul> | YF2A14-050UB3XLEAX | 2095608  |
|  | <ul style="list-style-type: none"> <li>• <b>Connection type head A:</b> Female connector, M12, 4-pin, angled, A-coded</li> <li>• <b>Connection type head B:</b> Flying leads</li> <li>• <b>Signal type:</b> Sensor/actuator cable</li> <li>• <b>Cable:</b> 2 m, 4-wire, PUR, halogen-free</li> <li>• <b>Description:</b> Sensor/actuator cable, unshielded</li> <li>• <b>Application:</b> Zones with oils and lubricants, Drag chain operation, Robot</li> </ul>   | YG2A14-020UB3XLEAX | 2095766  |
|  | <ul style="list-style-type: none"> <li>• <b>Connection type head A:</b> Female connector, M12, 4-pin, angled, A-coded</li> <li>• <b>Connection type head B:</b> Flying leads</li> <li>• <b>Signal type:</b> Sensor/actuator cable</li> <li>• <b>Cable:</b> 5 m, 4-wire, PUR, halogen-free</li> <li>• <b>Description:</b> Sensor/actuator cable, unshielded</li> <li>• <b>Application:</b> Zones with oils and lubricants, Drag chain operation, Robot</li> </ul>   | YG2A14-050UB3XLEAX | 2095767  |

## SICK AT A GLANCE

SICK is one of the leading manufacturers of intelligent sensors and sensor solutions for industrial applications. A unique range of products and services creates the perfect basis for controlling processes securely and efficiently, protecting individuals from accidents and preventing damage to the environment.

We have extensive experience in a wide range of industries and understand their processes and requirements. With intelligent sensors, we can deliver exactly what our customers need. In application centers in Europe, Asia and North America, system solutions are tested and optimized in accordance with customer specifications. All this makes us a reliable supplier and development partner.

Comprehensive services complete our offering: SICK LifeTime Services provide support throughout the machine life cycle and ensure safety and productivity.

For us, that is “Sensor Intelligence.”

## WORLDWIDE PRESENCE:

Contacts and other locations –[www.sick.com](http://www.sick.com)