



# VL18-3P3840

V18

CYLINDRICAL PHOTOELECTRIC SENSORS

**SICK**  
Sensor Intelligence.



Illustration may differ



### Ordering information

| Type        | Part no. |
|-------------|----------|
| VL18-3P3840 | 6013635  |

Other models and accessories → [www.sick.com/V18](http://www.sick.com/V18)

### Detailed technical data

#### Features

|  |                                       |
|--|---------------------------------------|
| <b>Functional principle</b>            | Photoelectric retro-reflective sensor |
| <b>Dimensions (W x H x D)</b>          | 18 mm x 18 mm x 75 mm                 |
| <b>Housing design (light emission)</b> | Cylindrical                           |
| <b>Housing length</b>                  | 75 mm                                 |
| <b>Thread diameter (housing)</b>       | M18 x 1                               |
| <b>Optical axis</b>                    | Radial                                |
| <b>Sensing range max.</b>              | 0.05 m ... 3.7 m <sup>1)</sup>        |
| <b>Sensing range</b>                   | 0.05 m ... 3 m <sup>1)</sup>          |
| <b>Focus</b>                           | Approx. 2.8°                          |
| <b>Type of light</b>                   | Visible red light                     |
| <b>Light source</b>                    | LED <sup>2)</sup>                     |
| <b>Light spot size (distance)</b>      | Ø 150 mm (3 m)                        |
| <b>Angle of dispersion</b>             | Approx. 2.8°                          |
| <b>Adjustment</b>                      | None                                  |

<sup>1)</sup> Reflector C110A.

<sup>2)</sup> Average service life: 100,000 h at T<sub>U</sub> = +25 °C.

#### Mechanics/electronics

|                                     |                                   |
|-------------------------------------|-----------------------------------|
| <b>Supply voltage U<sub>B</sub></b> | 10 V DC ... 30 V DC <sup>1)</sup> |
|-------------------------------------|-----------------------------------|

<sup>1)</sup> Limit values.

<sup>2)</sup> May not fall below or exceed U<sub>V</sub> tolerances.

<sup>3)</sup> Without load.

<sup>4)</sup> Signal transit time with resistive load.

<sup>5)</sup> With light/dark ratio 1:1.

<sup>6)</sup> A = V<sub>S</sub> connections reverse-polarity protected.

<sup>7)</sup> B = inputs and output reverse-polarity protected.

<sup>8)</sup> C = interference suppression.

<sup>9)</sup> D = outputs overcurrent and short-circuit protected.

|  |  |
|--|--|
| <b>Ripple</b>                          | $\pm 10 \% ^{2)}$  |
| <b>Current consumption</b>             | 30 mA <sup>3)</sup>  |
| <b>Switching output</b>                | PNP  |
| <b>Switching mode</b>                  | Dark switching   |
| <b>Output current I<sub>max.</sub></b> | $\leq 100 \text{ mA}$  |
| <b>Response time</b>                   | $\leq 2 \text{ ms} ^{4)}$  |
| <b>Switching frequency</b>             | 250 Hz <sup>5)</sup>   |
| <b>Connection type</b>                 | Male connector M12, 4-pin  |
| <b>Circuit protection</b>              | A <sup>6)</sup><br>B <sup>7)</sup><br>C <sup>8)</sup><br>D <sup>9)</sup> |
| <b>Protection class</b>                | III  |
| <b>Weight</b>                          | 100 g  |
| <b>Polarisation filter</b>             | ✓  |
| <b>Housing material</b>                | Plastic, PBT/PC  |
| <b>Optics material</b>                 | Plastic, PMMA  |
| <b>Enclosure rating</b>                | IP67   |
| <b>Ambient operating temperature</b>   | -25 °C ... +70 °C  |
| <b>UL File No.</b>                     | NMFT2.E175606  |

1) Limit values.

2) May not fall below or exceed U<sub>y</sub> tolerances.

3) Without load.

4) Signal transit time with resistive load.

5) With light/dark ratio 1:1.

6) A = V<sub>S</sub> connections reverse-polarity protected.

7) B = inputs and output reverse-polarity protected.

8) C = interference suppression.

9) D = outputs overcurrent and short-circuit protected.

## Classifications

|                     |          |
|---------------------|----------|
| <b>ECLASS 5.0</b>   | 27270902 |
| <b>ECLASS 5.1.4</b> | 27270902 |
| <b>ECLASS 6.0</b>   | 27270902 |
| <b>ECLASS 6.2</b>   | 27270902 |
| <b>ECLASS 7.0</b>   | 27270902 |
| <b>ECLASS 8.0</b>   | 27270902 |
| <b>ECLASS 8.1</b>   | 27270902 |
| <b>ECLASS 9.0</b>   | 27270902 |
| <b>ECLASS 10.0</b>  | 27270902 |
| <b>ECLASS 11.0</b>  | 27270902 |
| <b>ECLASS 12.0</b>  | 27270902 |
| <b>ETIM 5.0</b>     | EC002717 |
| <b>ETIM 6.0</b>     | EC002717 |

# VL18-3P3840 | V18

## CYLINDRICAL PHOTOELECTRIC SENSORS

|                       |          |
|-----------------------|----------|
| <b>ETIM 7.0</b>       | EC002717 |
| <b>ETIM 8.0</b>       | EC002717 |
| <b>UNSPSC 16.0901</b> | 39121528 |

### Adjustments

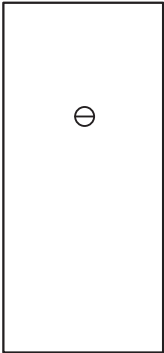

### Connection type

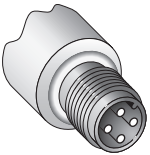

### Characteristic curve

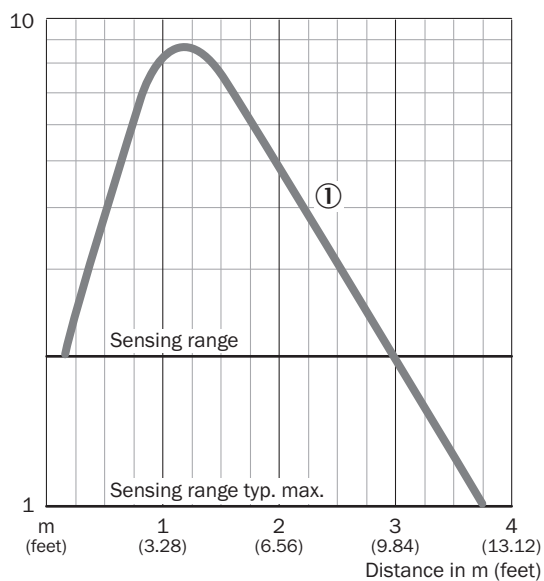

Sensing range diagram

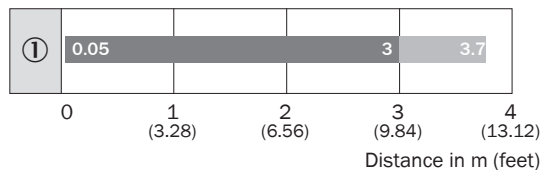

■ Operating range ■ Scanning range typ. max.

① Reflector type C110

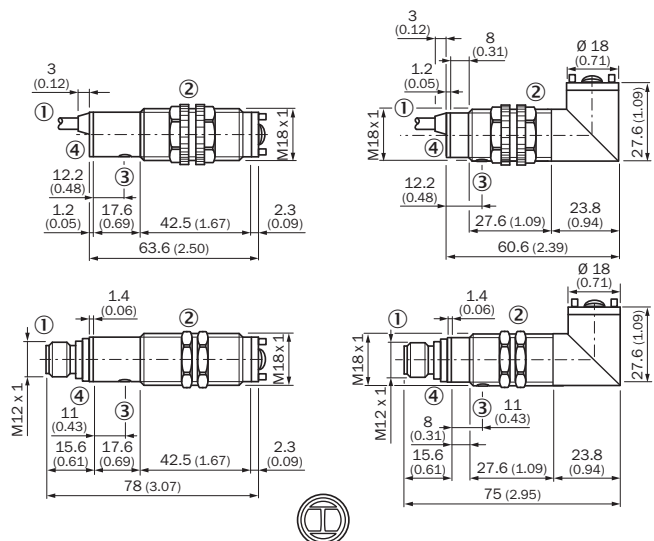

Dimensional drawing (Dimensions in mm (inch))



Recommended accessories

Other models and accessories → [www.sick.com/V18](http://www.sick.com/V18)

|                                     | Brief description   | Type        | Part no. |
|-------------------------------------|---|-------------|----------|
| <b>Mounting brackets and plates</b> |   |             |          |
|                                     | Mounting bracket for M18 sensors, steel, zinc coated, without mounting hardware | BEF-WN-M18  | 5308446  |
|                                     | Universal mounting bracket for reflectors, steel, zinc coated                   | BEF-WN-REFX | 2064574  |

|   | Brief description   | Type               | Part no. |
|---|---|--------------------|----------|
| Reflectors  |   |                    |          |
|  | Rectangular, screw connection, 51 mm x 61 mm, PMMA/ABS, Screw-on, 2 hole mounting   | P250               | 5304812  |
| Others  |   |                    |          |
|  | <ul style="list-style-type: none"> <li>• <b>Connection type head A:</b> Female connector, M12, 4-pin, straight, A-coded</li> <li>• <b>Connection type head B:</b> Flying leads</li> <li>• <b>Signal type:</b> Sensor/actuator cable</li> <li>• <b>Cable:</b> 5 m, 4-wire, PVC</li> <li>• <b>Description:</b> Sensor/actuator cable, unshielded</li> <li>• <b>Application:</b> Zones with chemicals</li> </ul> | YF2A14-050VB3XLEAX | 2096235  |
|  | <ul style="list-style-type: none"> <li>• <b>Connection type head A:</b> Male connector, M12, 4-pin, straight, A-coded</li> <li>• <b>Description:</b> Unshielded</li> <li>• <b>Connection systems:</b> Screw-type terminals</li> <li>• <b>Permitted cross-section:</b> ≤ 0.75 mm<sup>2</sup></li> </ul>  | STE-1204-G         | 6009932  |

## SICK AT A GLANCE

SICK is one of the leading manufacturers of intelligent sensors and sensor solutions for industrial applications. A unique range of products and services creates the perfect basis for controlling processes securely and efficiently, protecting individuals from accidents and preventing damage to the environment.

We have extensive experience in a wide range of industries and understand their processes and requirements. With intelligent sensors, we can deliver exactly what our customers need. In application centers in Europe, Asia and North America, system solutions are tested and optimized in accordance with customer specifications. All this makes us a reliable supplier and development partner.

Comprehensive services complete our offering: SICK LifeTime Services provide support throughout the machine life cycle and ensure safety and productivity.

For us, that is “Sensor Intelligence.”

## WORLDWIDE PRESENCE:

Contacts and other locations –[www.sick.com](http://www.sick.com)