



## Y8A36A2-LXXXUBA050

Passive distribution boxes

**SICK**  
Sensor Intelligence.



## Ordering information

Type	Part no.
Y8A36A2-LXXXUBA050	2115728

Other models and accessories → [www.sick.com/Passive\\_distribution\\_boxes](http://www.sick.com/Passive_distribution_boxes)



## Detailed technical data

### Technical specifications

<b>Shielding</b>	Unshielded
<b>Number of slots</b>	6
<b>Slot connection type</b>	M8, 3-pin, A-coded, female connector
<b>Root port connection type</b>	Flying leads
<b>Connecting cable</b>	5 m, 8-wire, PUR, halogen-free
<b>Cable diameter</b>	8.5 mm
<b>Cable color</b>	Gray
<b>Conductor cross section</b>	2 x 0.75 mm <sup>2</sup> + 6 x 0.34 mm <sup>2</sup>
<b>Traversing speed</b>	2 m/s
<b>Travelling distance</b>	5 m
<b>Acceleration</b>	≤ 5 m/s <sup>2</sup>
<b>Bending radius</b>	
Flexible use	> 10 x cable diameter
Stationary position	> 10 x cable diameter
Drag chain operation	> 10 x cable diameter
<b>Bending cycles</b>	≤ 5,000,000
<b>Tightening torque</b>	
Slots	0.4 Nm
<b>Display LED</b>	
Slots	1 x per socket
Root port	1x per distributor
<b>Reference voltage</b>	≤ 24 V DC
<b>Current loading</b>	10 A
<b>Overtoltage category</b>	III
<b>Operating temperature</b>	
Flexible use	-5 °C ... +80 °C
Stationary position	-40 °C ... +80 °C
Drag chain operation	-5 °C ... +60 °C

Distributor box	-20 °C ... +72 °C
<b>Enclosure rating</b>	IP65/ IP67
<b>UL File No.</b>	E238799
<b>Authorizations</b>	UL CE
<b>Items supplied</b>	5 x labeling plates

## Classifications

<b>ECLASS 5.0</b>	27279201
<b>ECLASS 5.1.4</b>	27279201
<b>ECLASS 6.0</b>	27279201
<b>ECLASS 6.2</b>	27279201
<b>ECLASS 7.0</b>	27279201
<b>ECLASS 8.0</b>	27279201
<b>ECLASS 8.1</b>	27279201
<b>ECLASS 9.0</b>	27440108
<b>ECLASS 10.0</b>	27440108
<b>ECLASS 11.0</b>	27440108
<b>ECLASS 12.0</b>	27440108
<b>ETIM 5.0</b>	EC002585
<b>ETIM 6.0</b>	EC002585
<b>ETIM 7.0</b>	EC002585
<b>ETIM 8.0</b>	EC002585
<b>UNSPSC 16.0901</b>	31163032

## Dimensional drawing (Dimensions in mm (inch))

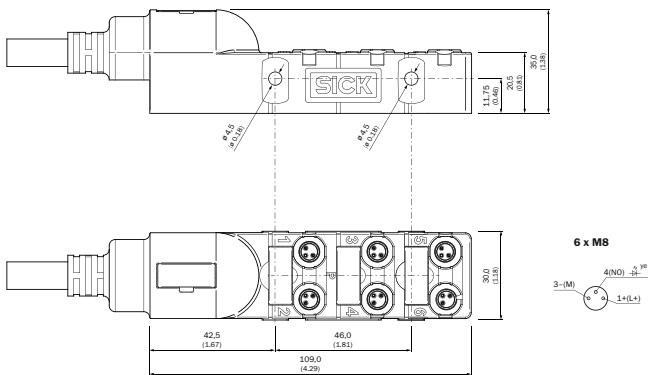

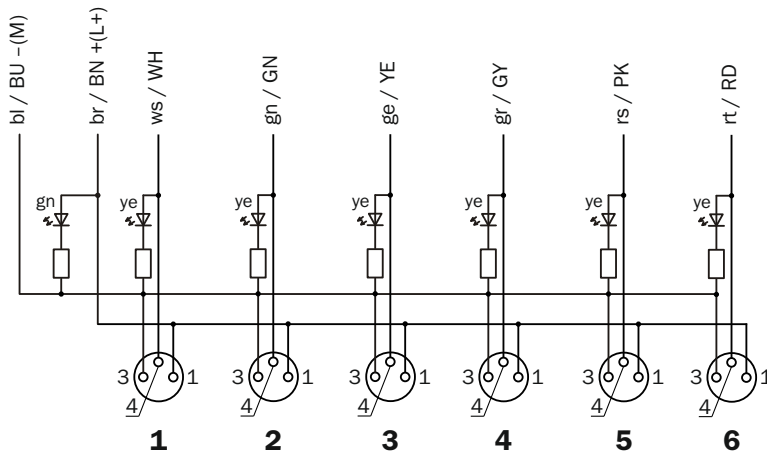

## Connection diagram

Cd-475



## Recommended accessories

Other models and accessories → [www.sick.com/Passive\\_distribution\\_boxes](http://www.sick.com/Passive_distribution_boxes)

	Brief description	Type	Part no.
Device protection (mechanical)			
	1 piece, Protective cap for M8 socket or unused ports	DOS-08SK	5340762
Others			
	<ul style="list-style-type: none"> <li><b>Connection type head A:</b> Female connector, M8, 3-pin, straight, A-coded</li> <li><b>Connection type head B:</b> Male connector, M8, 3-pin, straight, A-coded</li> <li><b>Signal type:</b> Sensor/actuator cable</li> <li><b>Cable:</b> 5 m, 3-wire, PUR, halogen-free</li> <li><b>Description:</b> Sensor/actuator cable, unshielded</li> <li><b>Application:</b> Uncontaminated zones, Zones with oils and lubricants, Robot, Drag chain operation</li> </ul>	YF8U13-050UA1M8U13	2096308

## SICK AT A GLANCE

SICK is one of the leading manufacturers of intelligent sensors and sensor solutions for industrial applications. A unique range of products and services creates the perfect basis for controlling processes securely and efficiently, protecting individuals from accidents and preventing damage to the environment.

We have extensive experience in a wide range of industries and understand their processes and requirements. With intelligent sensors, we can deliver exactly what our customers need. In application centers in Europe, Asia and North America, system solutions are tested and optimized in accordance with customer specifications. All this makes us a reliable supplier and development partner.

Comprehensive services complete our offering: SICK LifeTime Services provide support throughout the machine life cycle and ensure safety and productivity.

For us, that is “Sensor Intelligence.”

## WORLDWIDE PRESENCE:

Contacts and other locations –[www.sick.com](http://www.sick.com)