



ZS3608-SR20263VZWW

Zx36

MOBILE HANDHELD SCANNERS

SICK
Sensor Intelligence.



Ordering information

Type	Part no.
ZS3608-SR20263VZWW	6080542

Other models and accessories → www.sick.com/Zx36



Detailed technical data

Features

Version	Standard Range (SR)
Application	Industrial application
Country approval	World-wide (except India, Korea)
Scanner design	Cable connection variant
Light source	LED, Visible, Red, 660 nm Target, laser, Visible, Red, 610 nm
Reading distance	30 mm ... 1,520 mm
Code resolution	≥ 0.13 mm ¹⁾ ≥ 0.19 mm ²⁾

¹⁾ Valid for Code 128.

²⁾ Valid for Data Matrix code.

Mechanics/electronics

Supply voltage	5 V DC, ± 10 %, Via host 12 V DC, ± 5 %, External supply
Housing color	Blue, black
Enclosure rating	IP65 IP68
Weight	305 g
Dimensions (L x W x H)	132 mm x 77 mm x 185 mm

Performance

Readable code structures	1D codes, 2D codes, Stacked, Digimarc®
Bar code types	Code 39, Code 39 Trioptic, Code 32, Code 93, Code 11, Codabar, Code 128, GS1-128 / EAN 128, UPC / EAN / JAN (with addition), MSI/Plessey, Interleaved 2 of 5, Standard and Industrial 2 of 5, Matrix 2 of 5, GS1 DataBar, DotCode, OCR-A/B, Australian Post, US Planet, US Postnet, British Post, Japan Post, Dutch KIX Post, OCR symbologies
2D code types	Data Matrix, QR code, MicroQR-Code, Aztec, MaxiCode, TLC-39, Chinese Sensible (Han Xin)
Stacked code types	PDF417, MicroPDF417, Code 49, Code 16K, Composite, Codablock F
Code alignment	Omni-directional

Battery power	3,100 mAh, over 100,000 scans with full battery
Code buffer	9,000 Codes (EAN, for scanning in batch mode)

Interfaces

Ethernet	✓, TCP/IP
Type of fieldbus integration	Optional over external fieldbus module CDF600-2
PROFINET	✓
Type of fieldbus integration	Optional over external fieldbus module CDF600-2
Function	PROFINET Single Port, PROFINET Dual Port
EtherCAT	✓
Type of fieldbus integration	Optional over external fieldbus module CDF600-2
Serial	✓, RS-232 TTL
PROFIBUS DP	✓
Type of fieldbus integration	Optional over external fieldbus module CDF600-2
USB	✓
Function	Keyboard wedge, COM-Port emulation
Optical indicators	2 LEDs (operational status, good read)
Acoustic indicators	Beeper, can be switched off
Vibration	Yes
Configuration software	Z-Up Tool

Ambient data

Shock resistance	Multiple falls Onto concrete from a height of 3 m
Ambient operating temperature	-30 °C ... +50 °C
Storage temperature	-40 °C ... +70 °C
Permissible relative humidity	95 %, Non-condensing
Ambient light immunity	108,000 lx

General notes

Note	Not free of paint wetting impairment substances.
-------------	--

Classifications

ECLASS 5.0	27280101
ECLASS 5.1.4	27280101
ECLASS 6.0	27280101
ECLASS 6.2	27280101
ECLASS 7.0	27280101
ECLASS 8.0	27280101
ECLASS 8.1	27280101
ECLASS 9.0	27280101
ECLASS 10.0	27280101
ECLASS 11.0	27280101
ECLASS 12.0	27280101
ETIM 5.0	EC002550
ETIM 6.0	EC002550

ETIM 7.0	EC002550
ETIM 8.0	EC002550
UNSPSC 16.0901	43211701

Connection diagram

PROFINET IO/RT

PROFINET IO/RT

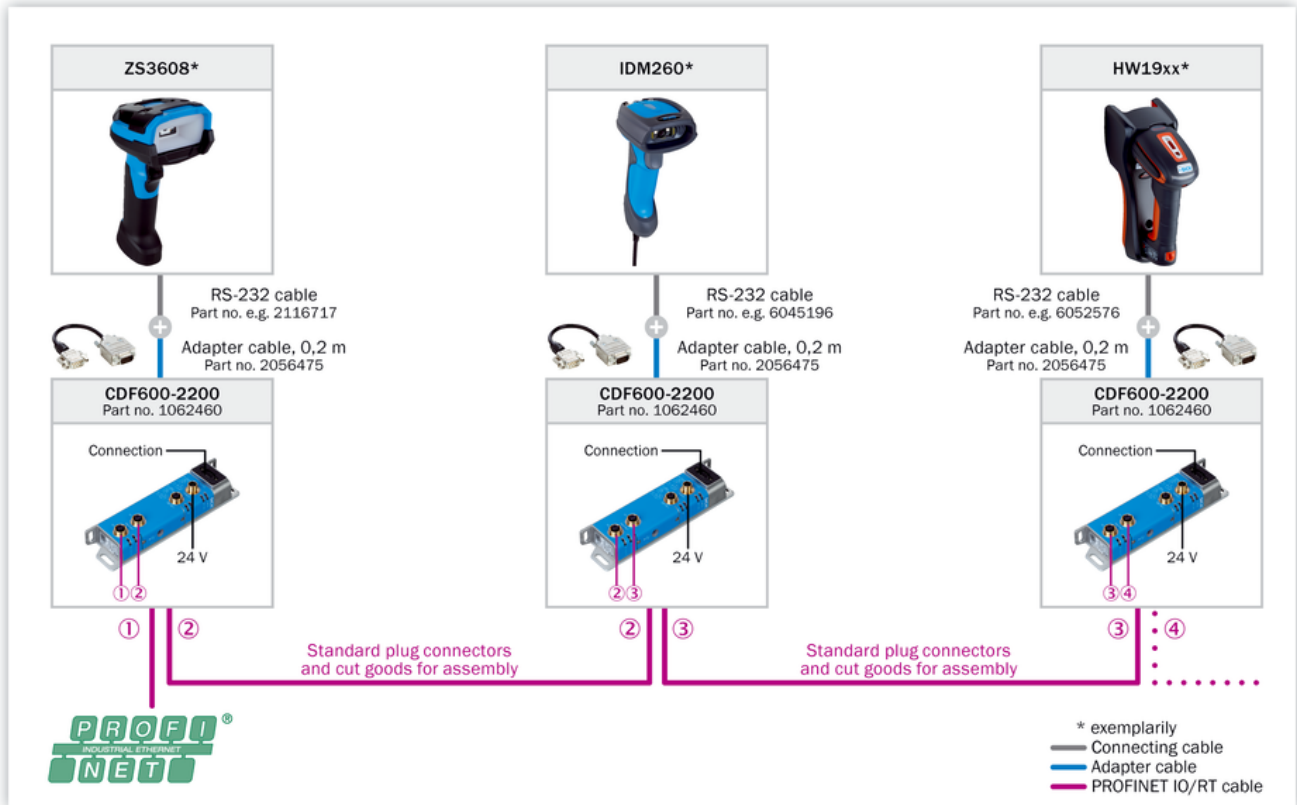

PROFIBUS DP

PROFIBUS DP

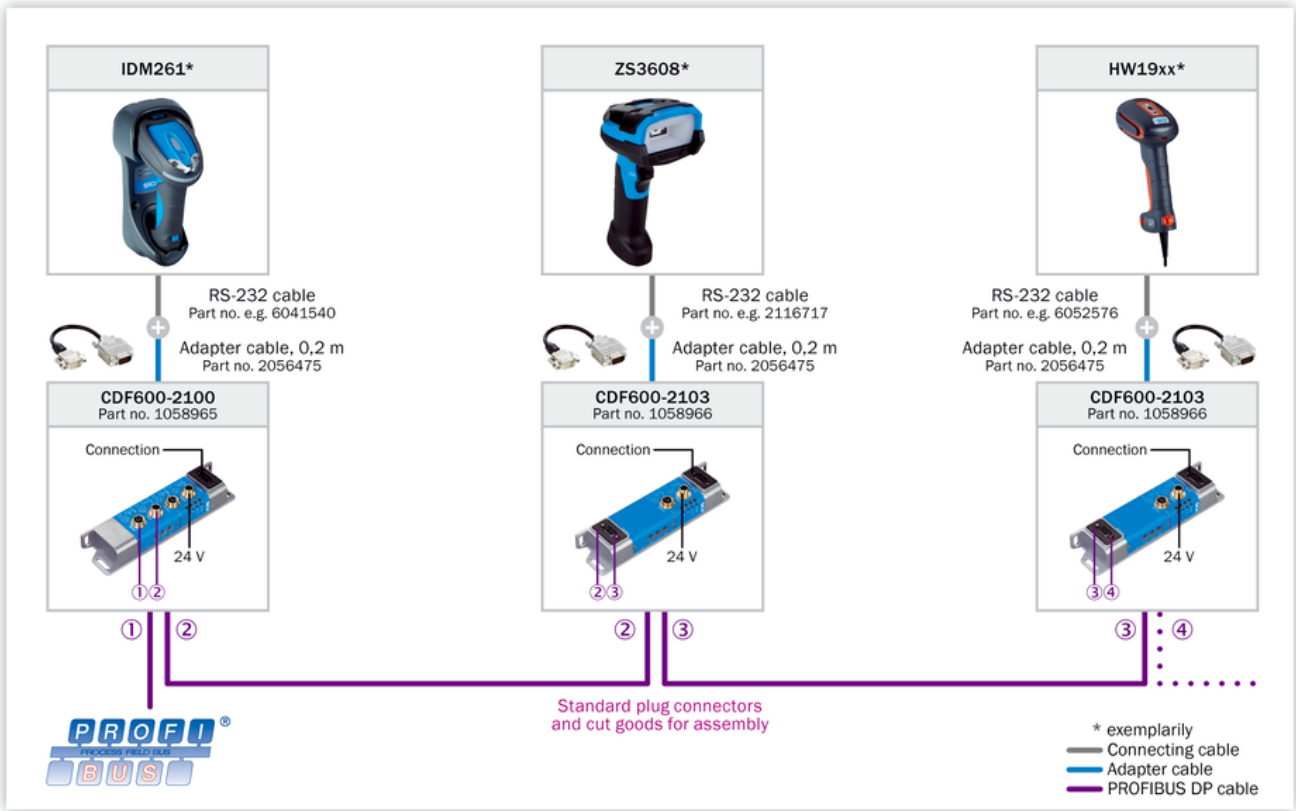

Ethernet TCP/IP

Ethernet TCP/IP

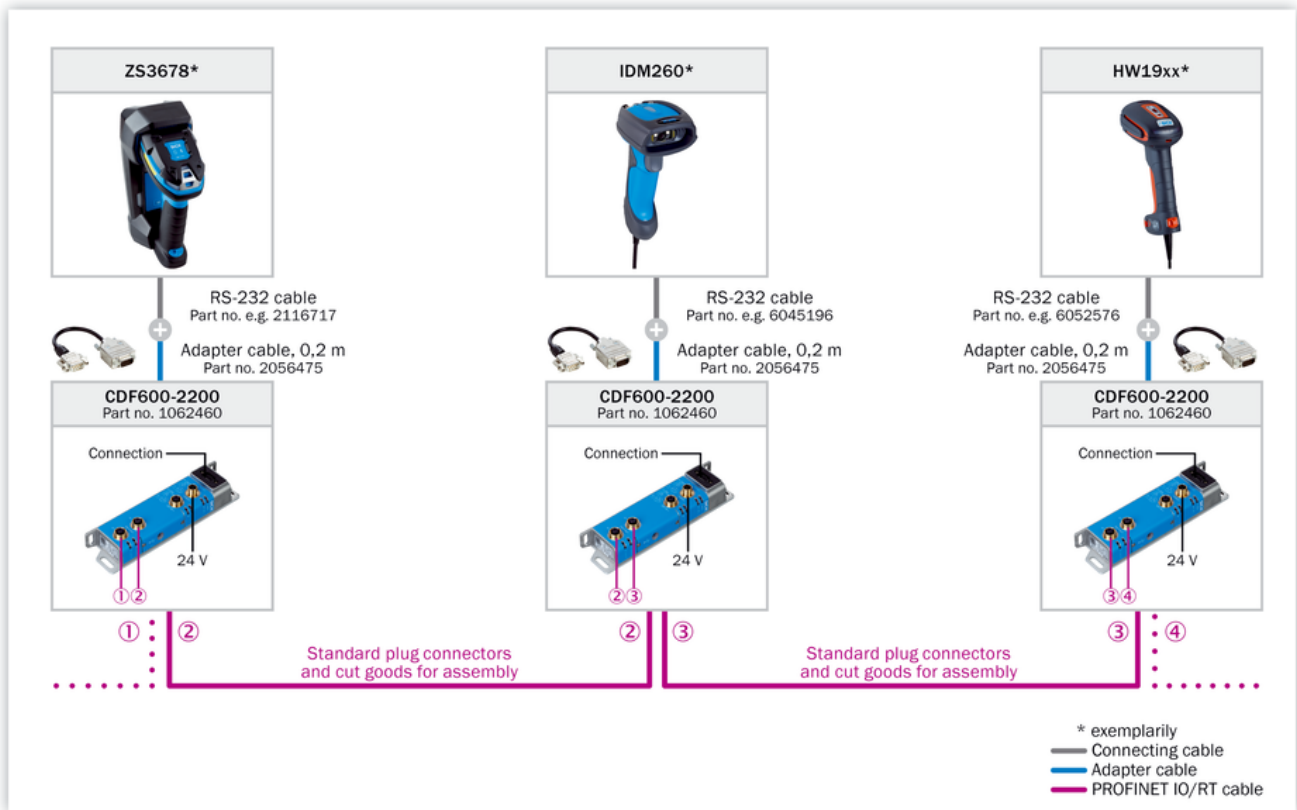

EtherCAT®

EtherCAT®

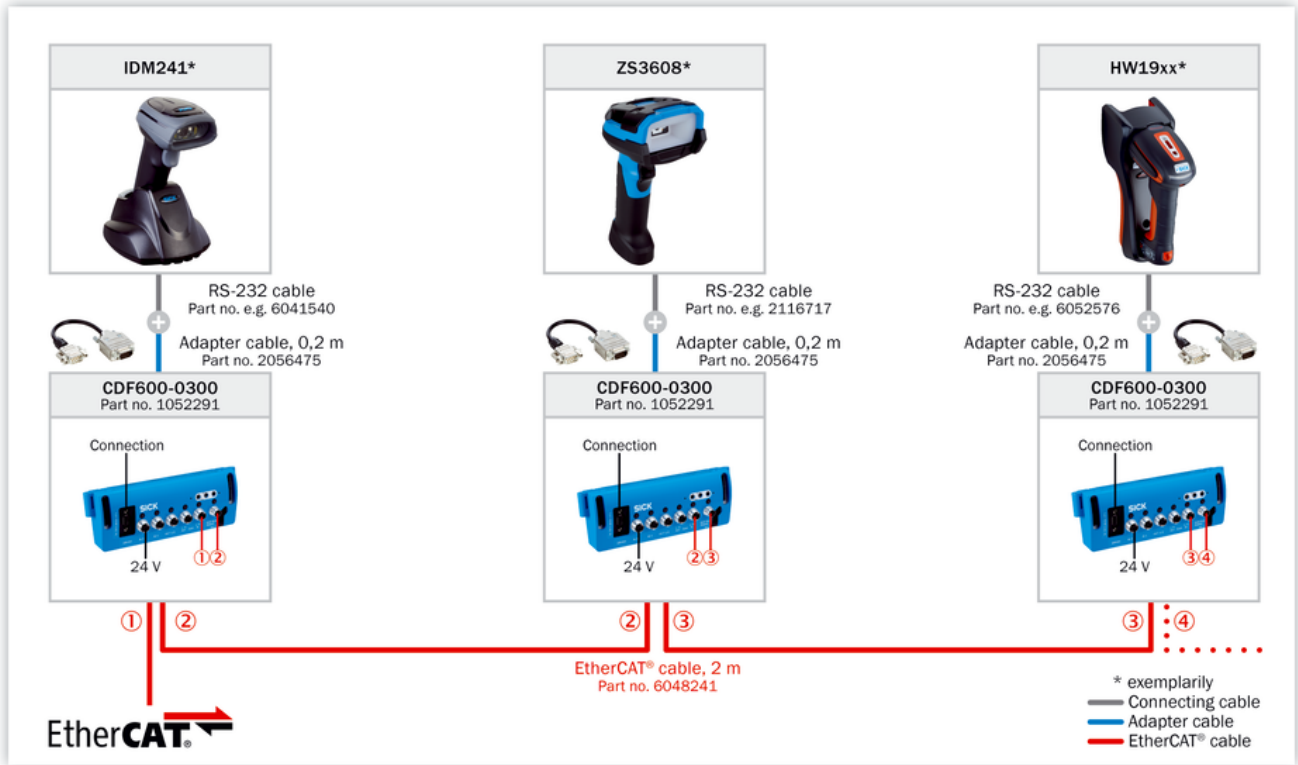

AUX looping

Looping-in via AUX

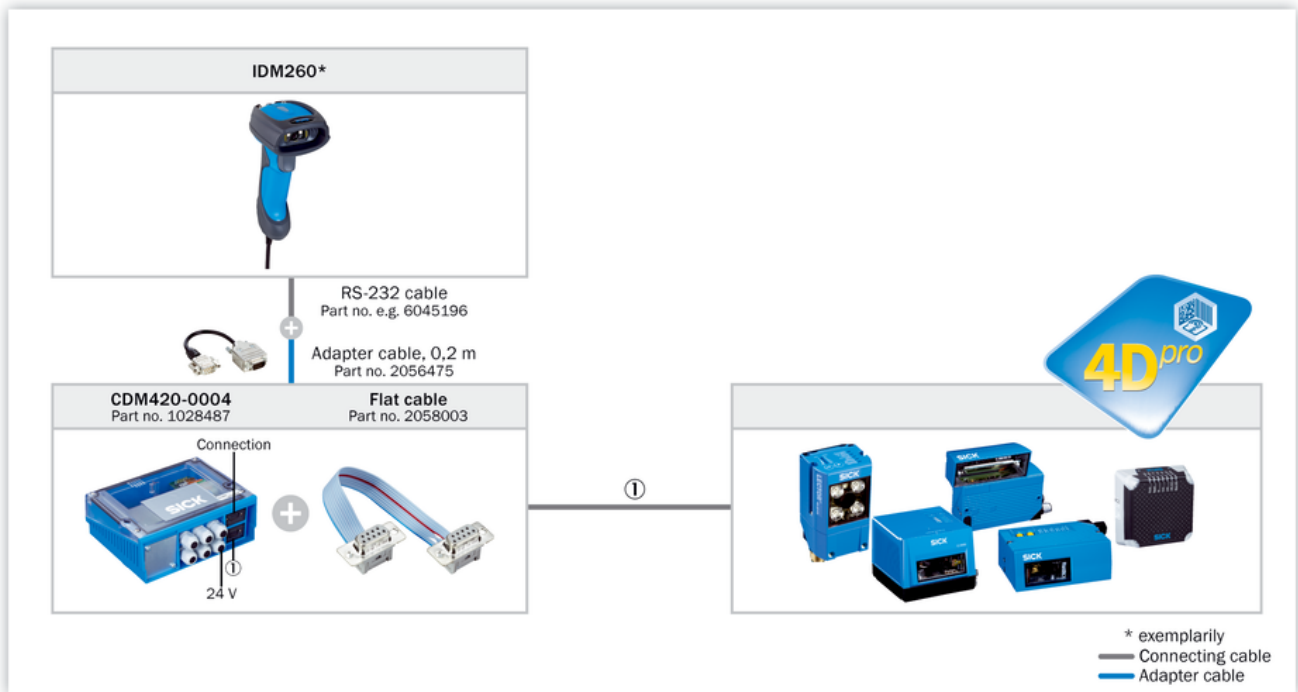

Selection Guide

ZS36x8 DPM

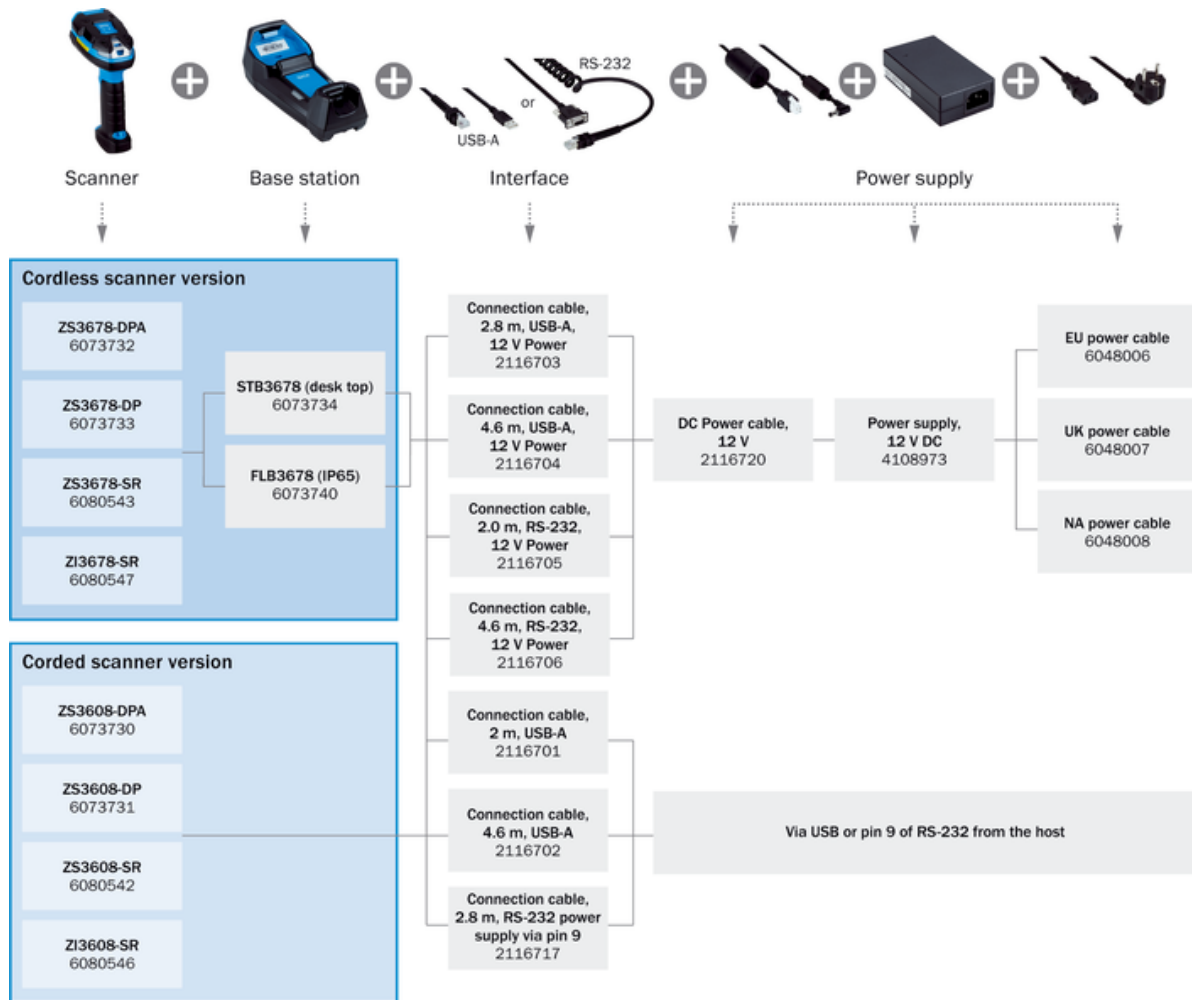

Optional accessories for all scanner versions



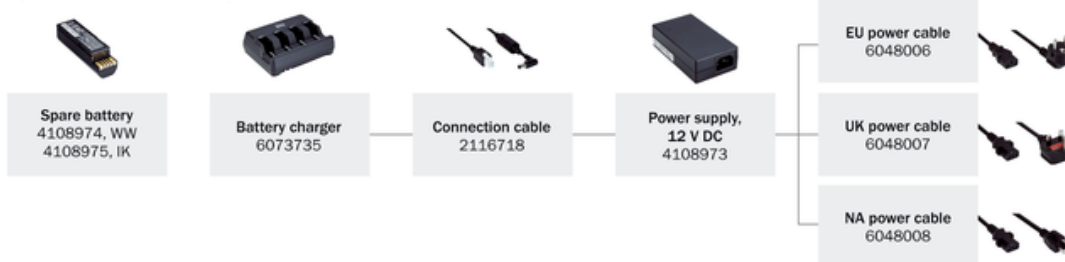

Optional accessories only for cordless scanner versions

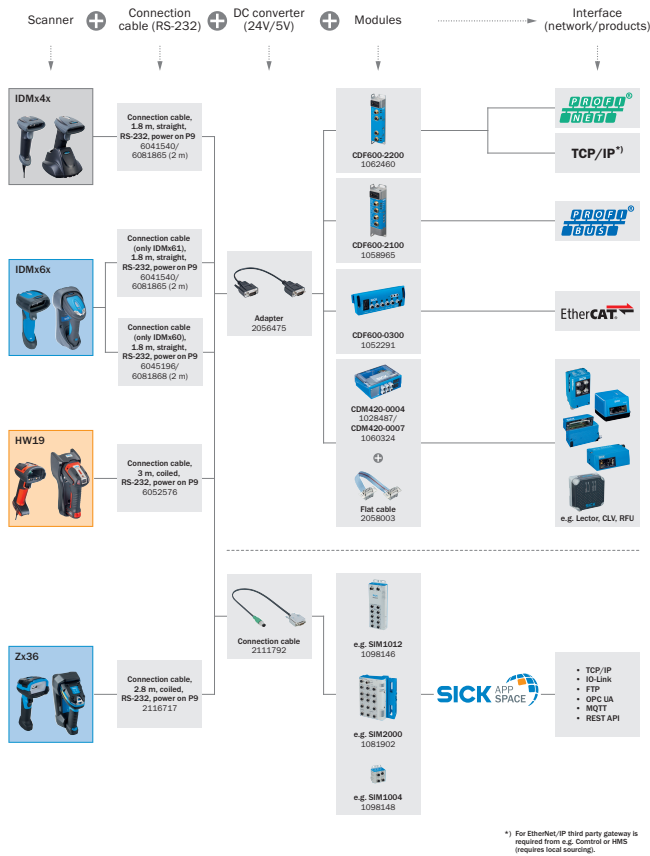









Recommended accessories

Other models and accessories → www.sick.com/Zx36

	Brief description	Type	Part no.
Other mounting accessories			
	Wall bracket, grey, plastic (Zebra 11-66553-06R) for ZS36xx	Wall holder	4108871
	Adjustable stand, grey, weighted base plate, plastic (Zebra STND-AS0036-07) for ZS36xx	Stand mount	4108870
Others			
	<ul style="list-style-type: none"> Connection type head A: Female connector, D-Sub, 9-pin, straight Connection type head B: Male connector, RJ45 Signal type: RS-232 TTL Cable: 2 m, straightened cable Description: RS-232 TTL, 5 V Host Power, with power socket for 12 V power supply, RS232 TTL, TXT on pin 2 (Zebra CBA-R07-S07PAR), needs power supply/DC and AC line if necessary 	Connection cable (male connector-female connector)	2116705

	Brief description	Type	Part no.
	<ul style="list-style-type: none"> • Connection type head A: Female connector, D-Sub, 9-pin, straight • Connection type head B: Male connector, RJ45 • Signal type: RS-232 TTL • Cable: 2.8 m, coiled cable • Description: RS-232 TTL, Voltage supply via pin 9, RS232 TTL, (Zebra CBA-R71-C09ZAR) 	Connection cable (male connector-female connector)	2116717
	<ul style="list-style-type: none"> • Connection type head A: Male connector, USB-A • Connection type head B: Male connector, RJ45 • Signal type: USB • Cable: 2 m, straightened cable • Description: USB, for keyboard connector or USB Com Port Emulation, 5 V Host Power shielded (Zebra CBA-U46-S07ZAR), USB 	Connection cable (male connector-male connector)	2116701
	<ul style="list-style-type: none"> • Connection type head A: Male connector, USB-A • Connection type head B: Male connector, RJ45 • Signal type: USB • Cable: 2.8 m, straightened cable • Description: USB, for keyboard connector or USB Com Port Emulation, 5 V Host Power, with power socket for 12 V power supply, shielded (Zebra CBA-U42-S07PAR), USB, needs power supply/DC- and AC cable 	Connection cable (male connector-male connector)	2116703
	AC power cable with EU male connector	Power cable	6048006
	DC cable for power supply (#6074455, Zebra PWRBGA12V50W0WW) for use with ZS36xx (Zebra CBL-DC-451A1-01)	Power cable	2116720
	Power supply for ZS36xx, battery charger, EA 3600 module (Zebra PWRB-GA12V50W0WW), requires DC and AC line	Power supply unit	4108973

SICK AT A GLANCE

SICK is one of the leading manufacturers of intelligent sensors and sensor solutions for industrial applications. A unique range of products and services creates the perfect basis for controlling processes securely and efficiently, protecting individuals from accidents and preventing damage to the environment.

We have extensive experience in a wide range of industries and understand their processes and requirements. With intelligent sensors, we can deliver exactly what our customers need. In application centers in Europe, Asia and North America, system solutions are tested and optimized in accordance with customer specifications. All this makes us a reliable supplier and development partner.

Comprehensive services complete our offering: SICK LifeTime Services provide support throughout the machine life cycle and ensure safety and productivity.

For us, that is “Sensor Intelligence.”

WORLDWIDE PRESENCE:

Contacts and other locations –www.sick.com