



# ZS3678-DP2F263VZK

Zx36

MOBILE HANDHELD SCANNERS

**SICK**  
Sensor Intelligence.



### Ordering information

| Type              | Part no. |
|-------------------|----------|
| ZS3678-DP2F263VZK | 6073739  |

**Included in delivery:** Rechargeable battery (1)

Other models and accessories → [www.sick.com/Zx36](http://www.sick.com/Zx36)

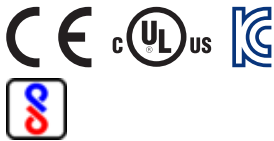

### Detailed technical data

#### Features

|                          |  |
|--------------------------|--|
| <b>Version</b>           | High Density (DP)  |
| <b>Application</b>       | Industrial application   |
| <b>Country approval</b>  | India, Korea   |
| <b>Scanner design</b>    | Wireless variant   |
| <b>Sensor resolution</b> | 1,280 px x 960 px  |
| <b>Light source</b>      | LED, Visible, Warm white, Direct<br>LED, Visible, Red, 634 nm, diffuse |
| <b>Alignment aid</b>     | LED, Red, 630 nm   |
| <b>Reading distance</b>  | 0 mm ... 86 mm   |
| <b>Code resolution</b>   | ≥ 0.08 mm <sup>1)</sup><br>≥ 0.13 mm <sup>2)</sup>                     |
| <b>Authorizations</b>    | BIS-conformity<br>KC-conformity  |

<sup>1)</sup> Valid for Code 39.

<sup>2)</sup> Valid for Data Matrix code.

#### Mechanics/electronics

|                               |   |
|-------------------------------|---|
| <b>Supply voltage</b>         | 5 V DC, ± 10 %, Via host<br>12 V DC, ± 5 %, External supply   |
| <b>Current consumption</b>    | Operation (full charge mode): 1,200 mA<br>Operation (minimum charge mode): 400 mA<br>Standby current: 80 mA |
| <b>Housing color</b>          | Blue, black   |
| <b>Enclosure rating</b>       | IP65<br>IP68  |
| <b>Weight</b>                 | 402 g, incl. rechargeable battery   |
| <b>Dimensions (L x W x H)</b> | 132 mm x 77 mm x 185 mm   |

## Performance

|                                 |  |
|---------------------------------|--|
| <b>Readable code structures</b> | 1D codes, 2D codes, Stacked, direct-marked codes   |
| <b>Bar code types</b>           | Code 39, Code 39 Trioptic, Code 32, Code 93, Code 11, Codabar, Code 128, GS1-128 / EAN 128, UPC / EAN / JAN (with addition), MSI/Plessey, Interleaved 2 of 5, Standard and Industrial 2 of 5, Matrix 2 of 5, GS1 DataBar, Australian Post, US Planet, US Postnet, British Post, Japan Post, Dutch KIX Post |
| <b>2D code types</b>            | Data Matrix, QR code, MicroQR-Code, Aztec, MaxiCode, TLC-39, Chinese Sensible (Han Xin)  |
| <b>Stacked code types</b>       | PDF417, MicroPDF417, Code 49, Code 16K, Composite, Codablock F   |
| <b>Code alignment</b>           | Omni-directional   |
| <b>Battery power</b>            | 3,100 mAh, over 100,000 scans with full battery  |
| <b>Code buffer</b>              | 9,000 Codes (EAN, for scanning in batch mode)  |
| <b>Authorizations</b>           | BIS-conformity<br>KC-conformity  |

## Interfaces

|                               |   |
|-------------------------------|---|
| <b>Ethernet</b>               | ✓, TCP/IP   |
| Type of fieldbus integration  | Optional over external fieldbus module CDF600-2   |
| <b>PROFINET</b>               | ✓   |
| Type of fieldbus integration  | Optional over external fieldbus module CDF600-2   |
| Function                      | PROFINET Single Port, PROFINET Dual Port  |
| <b>EtherCAT</b>               | ✓   |
| Type of fieldbus integration  | Optional over external fieldbus module CDF600-2   |
| <b>Serial</b>                 | ✓, RS-232 TTL   |
| <b>PROFIBUS DP</b>            | ✓   |
| Type of fieldbus integration  | Optional over external fieldbus module CDF600-2   |
| <b>USB</b>                    | ✓   |
| Function                      | Keyboard wedge, COM-Port emulation  |
| <b>Bluetooth</b>              | ✓   |
| Remark                        | Bluetooth™ V4.0, 2.402 ... 2.4830 GHz   |
| Function                      | Wireless operating range up to 100 m (free view), batch function for expansion of the wireless radius, up to seven scanners communicate with one base station |
| Data transmission rate        | ≤ 3 Mbit/s  |
| <b>Optical indicators</b>     | 3 LEDs (operational status, good read, radio connection status)   |
| <b>Acoustic indicators</b>    | Beeper, can be switched off   |
| <b>Vibration</b>              | Yes   |
| <b>Configuration software</b> | Z-Up Tool   |

## Ambient data

|                                      |   |
|--------------------------------------|---|
| <b>Shock resistance</b>              | Multiple falls onto concrete from a height of 2.4 m |
| <b>Ambient operating temperature</b> | -20 °C ... +50 °C                                   |
| <b>Storage temperature</b>           | -40 °C ... +70 °C                                   |
| <b>Permissible relative humidity</b> | 95 %, Non-condensing                                |
| <b>Ambient light immunity</b>        | 108,000 lx  |

## General notes

|                       |  |
|-----------------------|--|
| <b>Items supplied</b> | The rechargeable battery is included with delivery |
|-----------------------|--|

|             |  |
|-------------|--|
| <b>Note</b> | Not free of paint wetting impairment substances. |
|-------------|--|

### Classifications

|                       |          |
|-----------------------|----------|
| <b>ECLASS 5.0</b>     | 27280101 |
| <b>ECLASS 5.1.4</b>   | 27280101 |
| <b>ECLASS 6.0</b>     | 27280101 |
| <b>ECLASS 6.2</b>     | 27280101 |
| <b>ECLASS 7.0</b>     | 27280101 |
| <b>ECLASS 8.0</b>     | 27280101 |
| <b>ECLASS 8.1</b>     | 27280101 |
| <b>ECLASS 9.0</b>     | 27280101 |
| <b>ECLASS 10.0</b>    | 27280101 |
| <b>ECLASS 11.0</b>    | 27280101 |
| <b>ECLASS 12.0</b>    | 27280101 |
| <b>ETIM 5.0</b>       | EC002550 |
| <b>ETIM 6.0</b>       | EC002550 |
| <b>ETIM 7.0</b>       | EC002550 |
| <b>ETIM 8.0</b>       | EC002550 |
| <b>UNSPSC 16.0901</b> | 43211701 |

Connection diagram

PROFINET IO/RT

PROFINET IO/RT

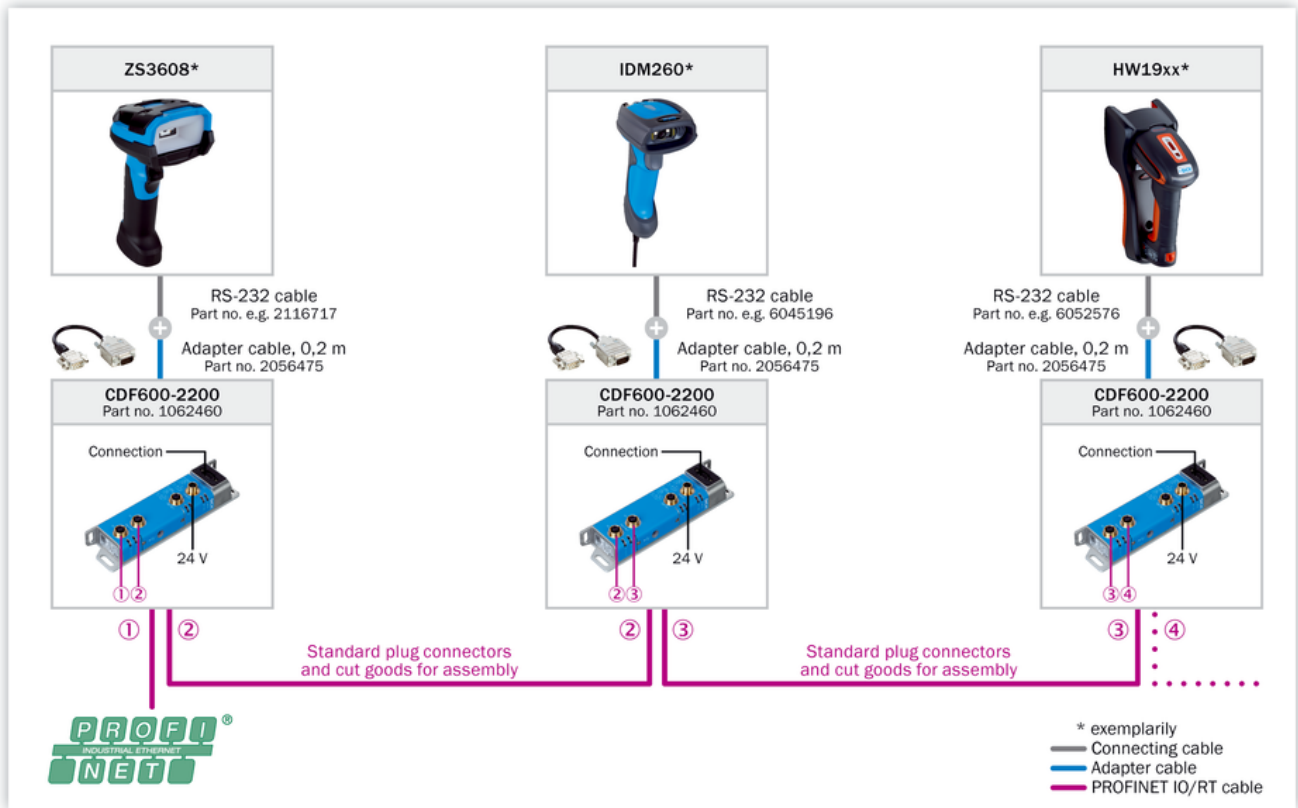

### PROFIBUS DP

#### PROFIBUS DP

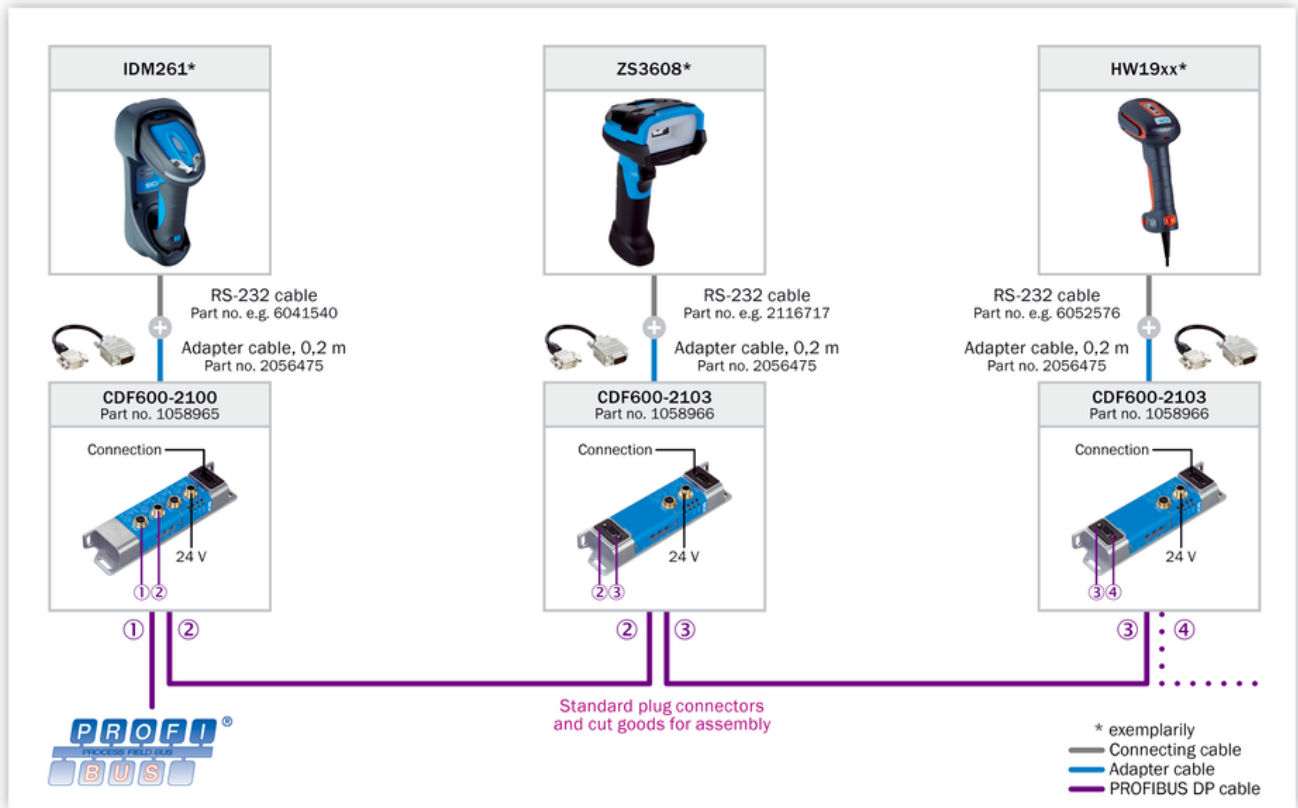

Ethernet TCP/IP

Ethernet TCP/IP

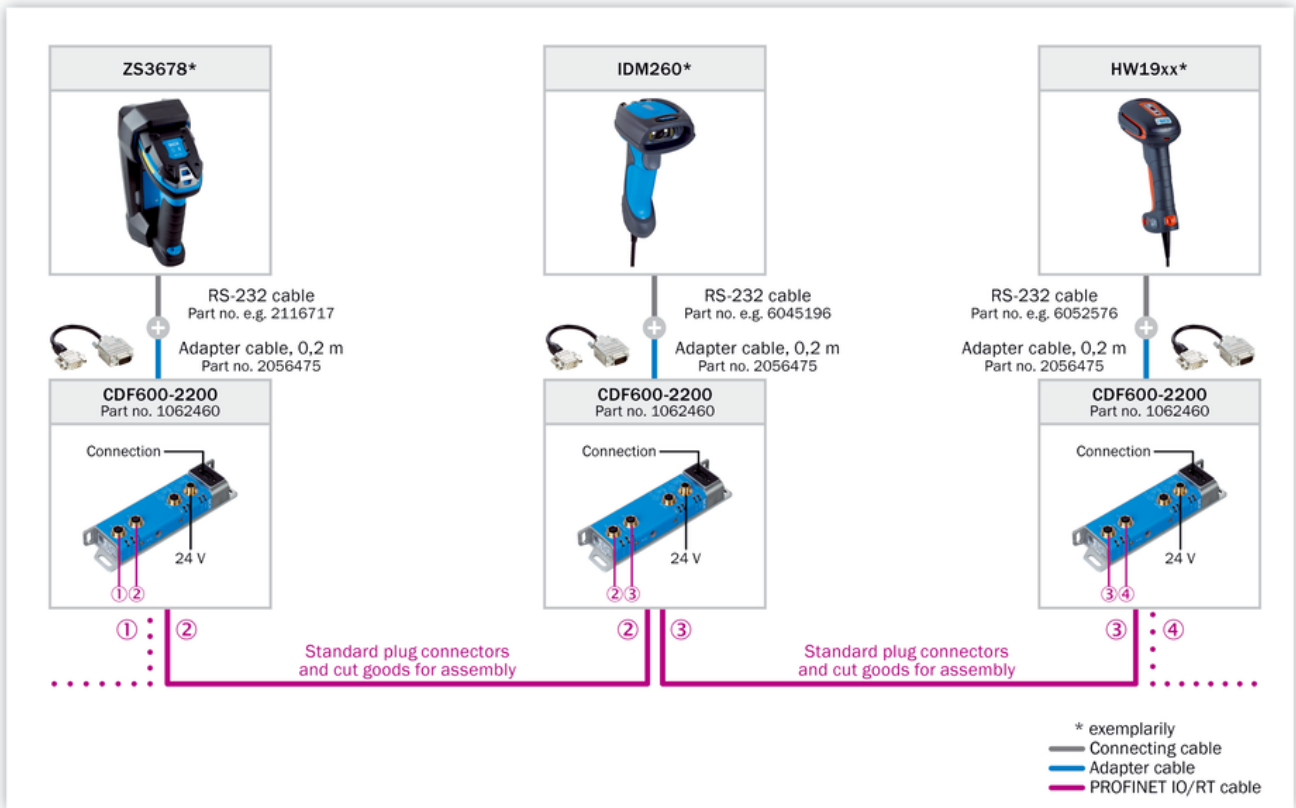

EtherCAT®

EtherCAT®



AUX looping

Looping-in via AUX

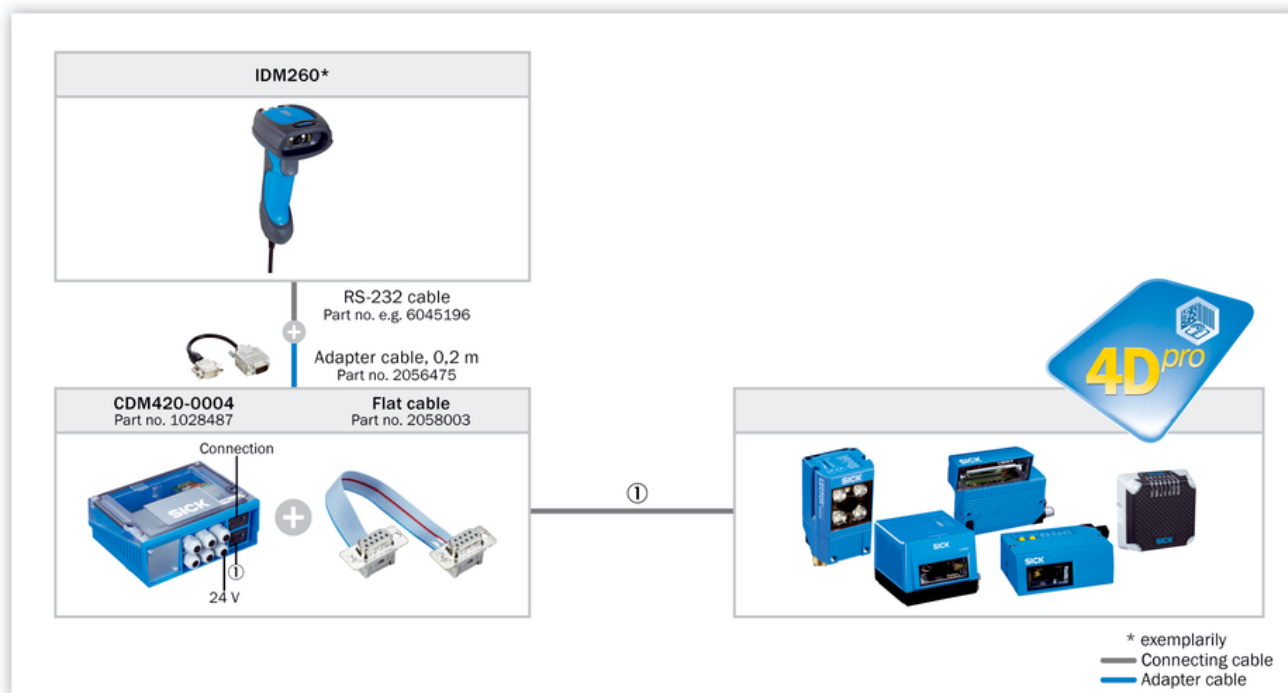



Selection Guide

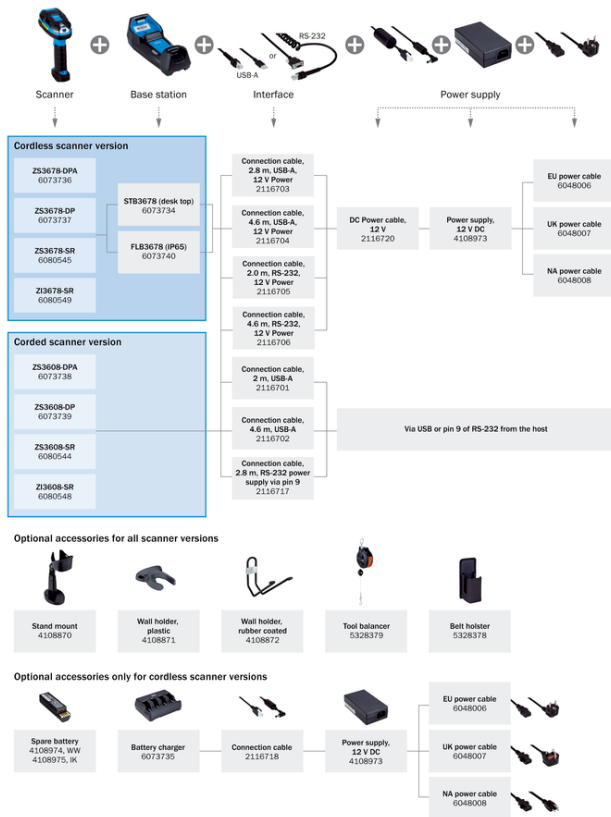

# ZS3678-DP2F263VZK | Zx36





## MOBILE HANDHELD SCANNERS



### Recommended accessories

Other models and accessories → [www.sick.com/Zx36](http://www.sick.com/Zx36)

|  | Brief description  | Type                 | Part no. |
|--|--|----------------------|----------|
| <b>Rechargeable batteries and battery chargers</b> |  |                      |          |
|  | Charging and WPAN receiver station for ZS36xx, enclosure rating IP65 (Zebra FLB3678-C126F3WW), may require power supply unit (part number 4108973, Zebra PWR-BGA12V50W0WW), DC cable (part number 2116720, Zebra CBL-DC-451A1-01) and AC cable | FLB3678 base station | 6073740  |
|  | Charging and WPAN receiver station for ZS36xx, desk top (Zebra STB3678-C126F3WW), may require power supply unit (part number 4108973, Zebra PWR-BGA12V50W0WW), DC cable (part number 2116720, Zebra CBL-DC-451A1-01) and AC cable              | STB3678 base station | 6073734  |
| <b>Others</b>                                      |  |                      |          |
|  | AC power cable with EU male connector  | Power cable          | 6048006  |
|  | DC cable for power supply (#6074455, Zebra PWRBGA12V50W0WW) for use with ZS36xx (Zebra CBL-DC-451A1-01)  | Power cable          | 2116720  |
|  | Power supply for ZS36xx, battery charger, EA 3600 module (Zebra PWRB-GA12V50W0WW), requires DC and AC line   | Power supply unit    | 4108973  |

|   | Brief description  | Type   | Part no. |
|---|--|--|----------|
|  | <ul style="list-style-type: none"> <li>• <b>Connection type head A:</b> Male connector, USB-A</li> <li>• <b>Connection type head B:</b> Male connector, RJ45</li> <li>• <b>Signal type:</b> USB</li> <li>• <b>Cable:</b> 2 m, straightened cable</li> <li>• <b>Description:</b> USB, for keyboard connector or USB Com Port Emulation, 5 V Host Power shielded (Zebra CBA-U46-S07ZAR), USB</li> </ul>  | Connection cable (male connector-male connector)   | 2116701  |
|  | <ul style="list-style-type: none"> <li>• <b>Connection type head A:</b> Female connector, D-Sub, 9-pin, straight</li> <li>• <b>Connection type head B:</b> Male connector, RJ45</li> <li>• <b>Signal type:</b> RS-232 TTL</li> <li>• <b>Cable:</b> 2 m, straightened cable</li> <li>• <b>Description:</b> RS-232 TTL, 5 V Host Power, with power socket for 12 V power supply, RS232 TTL, TXT on pin 2 (Zebra CBA-R07-S07PAR), needs power supply/DC and AC line if necessary</li> </ul> | Connection cable (male connector-female connector) | 2116705  |
|  | <ul style="list-style-type: none"> <li>• <b>Connection type head A:</b> Female connector, D-Sub, 9-pin, straight</li> <li>• <b>Connection type head B:</b> Male connector, RJ45</li> <li>• <b>Signal type:</b> RS-232 TTL</li> <li>• <b>Cable:</b> 2.8 m, coiled cable</li> <li>• <b>Description:</b> RS-232 TTL, Voltage supply via pin 9, RS232 TTL, (Zebra CBA-R71-C09ZAR)</li> </ul>   | Connection cable (male connector-female connector) | 2116717  |
|  | <ul style="list-style-type: none"> <li>• <b>Connection type head A:</b> Male connector, USB-A</li> <li>• <b>Connection type head B:</b> Male connector, RJ45</li> <li>• <b>Signal type:</b> USB</li> <li>• <b>Cable:</b> 2.8 m, straightened cable</li> <li>• <b>Description:</b> USB, for keyboard connector or USB Com Port Emulation, 5 V Host Power, with power socket for 12 V power supply, shielded (Zebra CBA-U42-S07PAR), USB, needs power supply/DC- and AC cable</li> </ul>   | Connection cable (male connector-male connector)   | 2116703  |

## SICK AT A GLANCE

SICK is one of the leading manufacturers of intelligent sensors and sensor solutions for industrial applications. A unique range of products and services creates the perfect basis for controlling processes securely and efficiently, protecting individuals from accidents and preventing damage to the environment.

We have extensive experience in a wide range of industries and understand their processes and requirements. With intelligent sensors, we can deliver exactly what our customers need. In application centers in Europe, Asia and North America, system solutions are tested and optimized in accordance with customer specifications. All this makes us a reliable supplier and development partner.

Comprehensive services complete our offering: SICK LifeTime Services provide support throughout the machine life cycle and ensure safety and productivity.

For us, that is “Sensor Intelligence.”

## WORLDWIDE PRESENCE:

Contacts and other locations –[www.sick.com](http://www.sick.com)