



ZS3678-DPAF262VZK

Zx36

MOBILE HANDHELD SCANNERS

SICK
Sensor Intelligence.



Ordering information

Type	Part no.
ZS3678-DPAF262VZK	6073738

Included in delivery: Rechargeable battery (1)

Other models and accessories → www.sick.com/Zx36

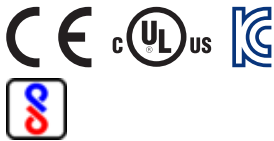

Detailed technical data

Features

Version	Standard Density (DPA)
Application	Industrial application
Country approval	India, Korea
Scanner design	Wireless variant
Sensor resolution	1,280 px x 960 px
Light source	LED, Visible, Warm white, Direct LED, Visible, Red, 634 nm, diffuse
Alignment aid	LED, Red, 630 nm
Reading distance	3 mm ... 125 mm
Code resolution	≥ 0.08 mm ¹⁾ ≥ 0.13 mm ²⁾
Authorizations	BIS-conformity KC-conformity

¹⁾ Valid for Code 39.

²⁾ Valid for Data Matrix code.

Mechanics/electronics

Supply voltage	5 V DC, ± 10 %, Via host 12 V DC, ± 5 %, External supply
Current consumption	Operation (full charge mode): 1,200 mA Operation (minimum charge mode): 400 mA Standby current: 80 mA
Housing color	Blue, black
Enclosure rating	IP65 IP68
Weight	402 g, incl. rechargeable battery
Dimensions (L x W x H)	132 mm x 77 mm x 185 mm

Performance

Readable code structures	1D codes, 2D codes, Stacked, direct-marked codes
Bar code types	Code 39, Code 39 Trioptic, Code 32, Code 93, Code 11, Codabar, Code 128, GS1-128 / EAN 128, UPC / EAN / JAN (with addition), MSI/Plessey, Interleaved 2 of 5, Standard and Industrial 2 of 5, Matrix 2 of 5, GS1 DataBar, Australian Post, US Planet, US Postnet, British Post, Japan Post, Dutch KIX Post
2D code types	Data Matrix, QR code, MicroQR-Code, Aztec, MaxiCode, TLC-39, Chinese Sensible (Han Xin)
Stacked code types	PDF417, MicroPDF417, Code 49, Code 16K, Composite, Codablock F
Code alignment	Omni-directional
Battery power	3,100 mAh, over 100,000 scans with full battery
Code buffer	9,000 Codes (EAN, for scanning in batch mode)
Authorizations	BIS-conformity KC-conformity

Interfaces

Ethernet	✓, TCP/IP
Type of fieldbus integration	Optional over external fieldbus module CDF600-2
PROFINET	✓
Type of fieldbus integration	Optional over external fieldbus module CDF600-2
Function	PROFINET Single Port, PROFINET Dual Port
EtherCAT	✓
Type of fieldbus integration	Optional over external fieldbus module CDF600-2
Serial	✓, RS-232 TTL
PROFIBUS DP	✓
Type of fieldbus integration	Optional over external fieldbus module CDF600-2
USB	✓
Function	Keyboard wedge, COM-Port emulation
Bluetooth	✓
Remark	Bluetooth™ V4.0, 2.402 ... 2.4830 GHz
Function	Wireless operating range up to 100 m (free view), batch function for expansion of the wireless radius, up to seven scanners communicate with one base station
Data transmission rate	≤ 3 Mbit/s
Optical indicators	3 LEDs (operational status, good read, radio connection status)
Acoustic indicators	Beeper, can be switched off
Vibration	Yes
Configuration software	Z-Up Tool

Ambient data

Shock resistance	Multiple falls onto concrete from a height of 2.4 m
Ambient operating temperature	-20 °C ... +50 °C
Storage temperature	-40 °C ... +70 °C
Permissible relative humidity	95 %, Non-condensing
Ambient light immunity	108,000 lx

General notes

Items supplied	The rechargeable battery is included with delivery
-----------------------	----------------------------------------------------

Note	Not free of paint wetting impairment substances.
-------------	--------------------------------------------------

Classifications

ECLASS 5.0	27280101
ECLASS 5.1.4	27280101
ECLASS 6.0	27280101
ECLASS 6.2	27280101
ECLASS 7.0	27280101
ECLASS 8.0	27280101
ECLASS 8.1	27280101
ECLASS 9.0	27280101
ECLASS 10.0	27280101
ECLASS 11.0	27280101
ECLASS 12.0	27280101
ETIM 5.0	EC002550
ETIM 6.0	EC002550
ETIM 7.0	EC002550
ETIM 8.0	EC002550
UNSPSC 16.0901	43211701

Connection diagram

PROFINET IO/RT

PROFINET IO/RT

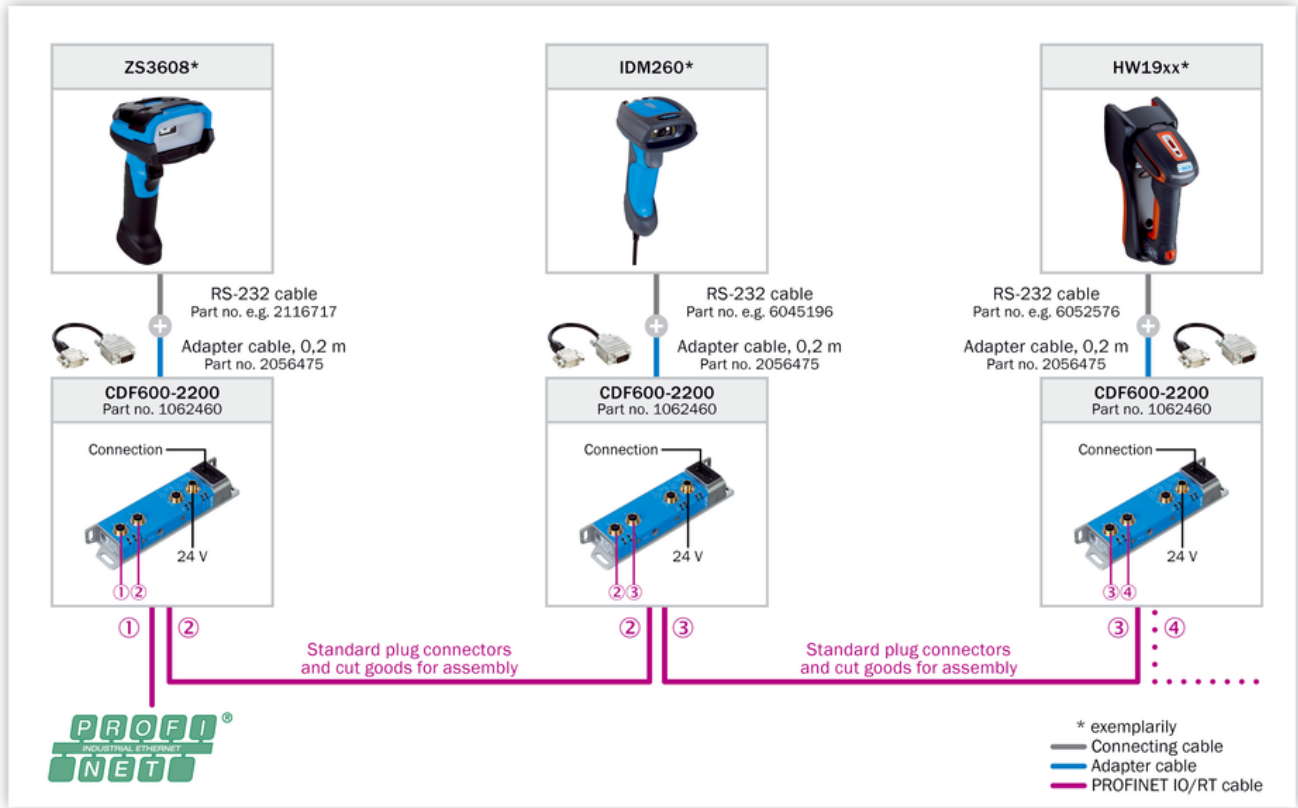

PROFIBUS DP

PROFIBUS DP

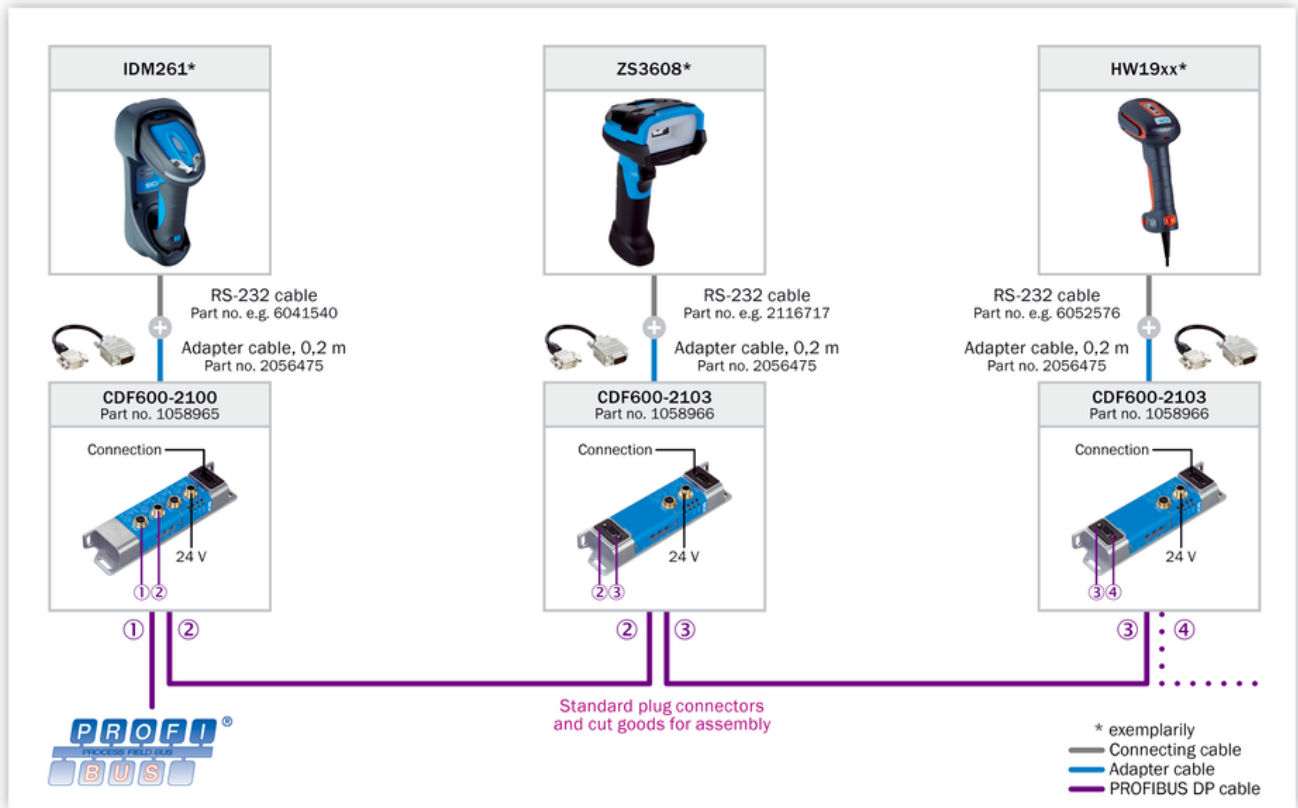

Ethernet TCP/IP

Ethernet TCP/IP

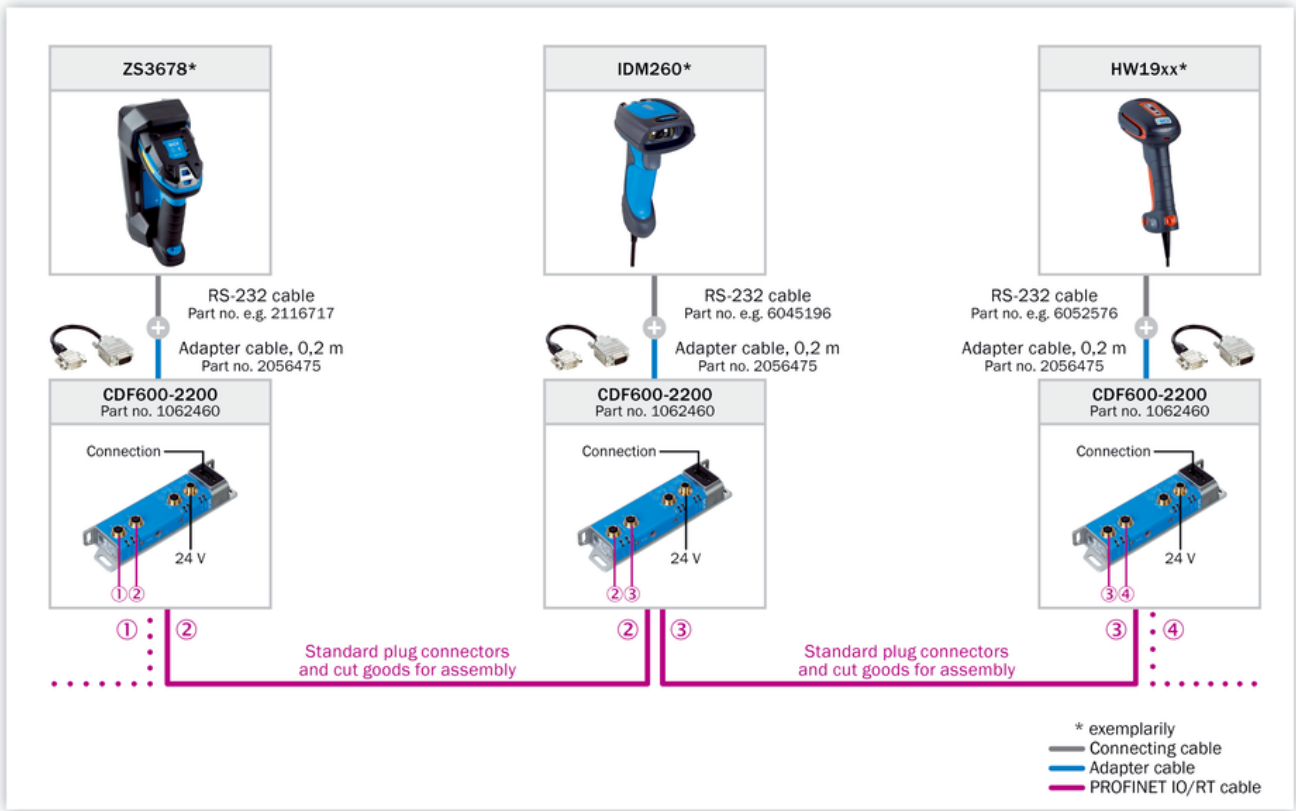

EtherCAT®

EtherCAT®

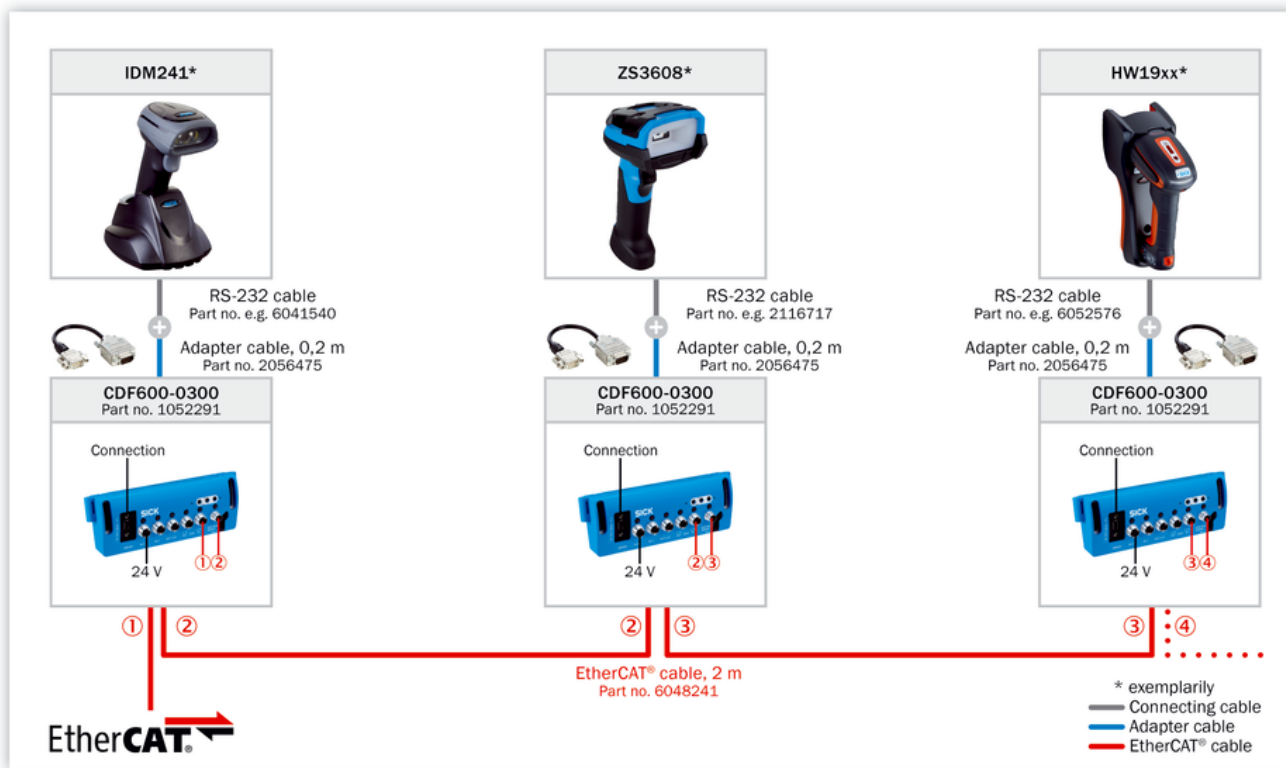

AUX looping

Looping-in via AUX

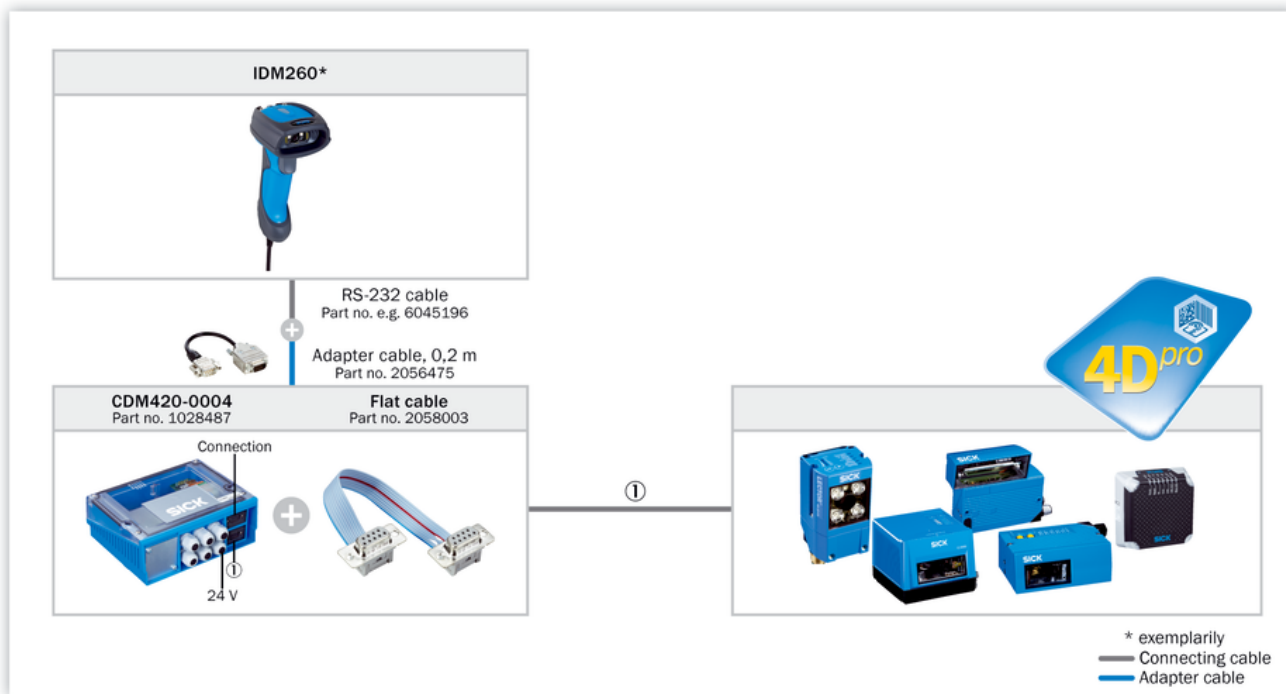

Selection Guide

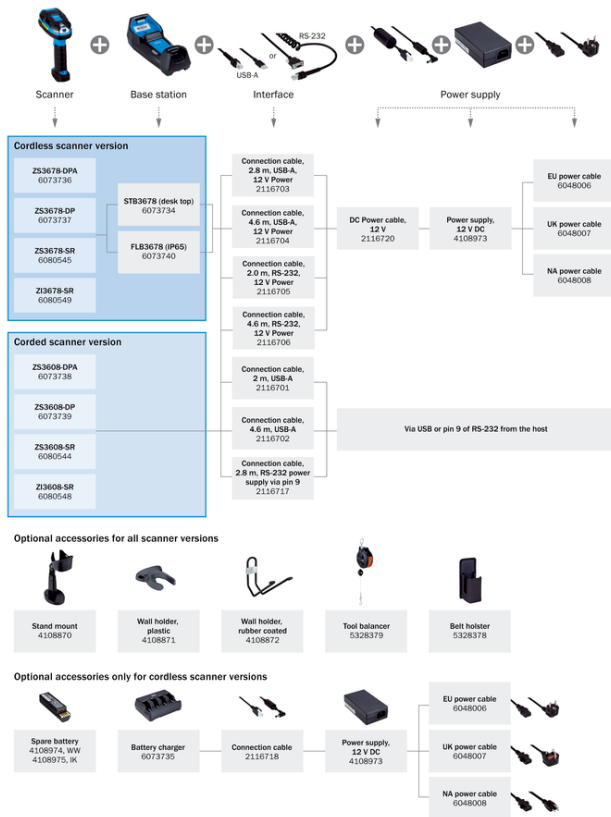





ZS3678-DPAF262VZK | Zx36





MOBILE HANDHELD SCANNERS



Recommended accessories

Other models and accessories → www.sick.com/Zx36

	Brief description	Type	Part no.
Rechargeable batteries and battery chargers			
	Charging and WPAN receiver station for ZS36xx, enclosure rating IP65 (Zebra FLB3678-C126F3WW), may require power supply unit (part number 4108973, Zebra PWR-BGA12V50W0WW), DC cable (part number 2116720, Zebra CBL-DC-451A1-01) and AC cable	FLB3678 base station	6073740
	Charging and WPAN receiver station for ZS36xx, desk top (Zebra STB3678-C126F3WW), may require power supply unit (part number 4108973, Zebra PWR-BGA12V50W0WW), DC cable (part number 2116720, Zebra CBL-DC-451A1-01) and AC cable	STB3678 base station	6073734
Others			
	AC power cable with EU male connector	Power cable	6048006
	DC cable for power supply (#6074455, Zebra PWRBGA12V50W0WW) for use with ZS36xx (Zebra CBL-DC-451A1-01)	Power cable	2116720
	Power supply for ZS36xx, battery charger, EA 3600 module (Zebra PWRB-GA12V50W0WW), requires DC and AC line	Power supply unit	4108973

	Brief description	Type	Part no.
	<ul style="list-style-type: none"> • Connection type head A: Male connector, USB-A • Connection type head B: Male connector, RJ45 • Signal type: USB • Cable: 2 m, straightened cable • Description: USB, for keyboard connector or USB Com Port Emulation, 5 V Host Power shielded (Zebra CBA-U46-S07ZAR), USB 	Connection cable (male connector-male connector)	2116701
	<ul style="list-style-type: none"> • Connection type head A: Female connector, D-Sub, 9-pin, straight • Connection type head B: Male connector, RJ45 • Signal type: RS-232 TTL • Cable: 2 m, straightened cable • Description: RS-232 TTL, 5 V Host Power, with power socket for 12 V power supply, RS232 TTL, TXT on pin 2 (Zebra CBA-R07-S07PAR), needs power supply/DC and AC line if necessary 	Connection cable (male connector-female connector)	2116705
	<ul style="list-style-type: none"> • Connection type head A: Female connector, D-Sub, 9-pin, straight • Connection type head B: Male connector, RJ45 • Signal type: RS-232 TTL • Cable: 2.8 m, coiled cable • Description: RS-232 TTL, Voltage supply via pin 9, RS232 TTL, (Zebra CBA-R71-C09ZAR) 	Connection cable (male connector-female connector)	2116717
	<ul style="list-style-type: none"> • Connection type head A: Male connector, USB-A • Connection type head B: Male connector, RJ45 • Signal type: USB • Cable: 2.8 m, straightened cable • Description: USB, for keyboard connector or USB Com Port Emulation, 5 V Host Power, with power socket for 12 V power supply, shielded (Zebra CBA-U42-S07PAR), USB, needs power supply/DC- and AC cable 	Connection cable (male connector-male connector)	2116703

SICK AT A GLANCE

SICK is one of the leading manufacturers of intelligent sensors and sensor solutions for industrial applications. A unique range of products and services creates the perfect basis for controlling processes securely and efficiently, protecting individuals from accidents and preventing damage to the environment.

We have extensive experience in a wide range of industries and understand their processes and requirements. With intelligent sensors, we can deliver exactly what our customers need. In application centers in Europe, Asia and North America, system solutions are tested and optimized in accordance with customer specifications. All this makes us a reliable supplier and development partner.

Comprehensive services complete our offering: SICK LifeTime Services provide support throughout the machine life cycle and ensure safety and productivity.

For us, that is “Sensor Intelligence.”

WORLDWIDE PRESENCE:

Contacts and other locations –www.sick.com